

26

STEPS

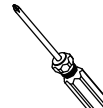

3 HR

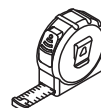

EN_IMPORTANT, RETAIN FOR FUTURE REFERENCE: READ CAREFULLY.

FR_IMPORTANT: A LIRE ATTENTIVEMENT ET À CONSERVER POUR CONSULTATION ULTÉRIEURE.

ES_IMPORTANTE, LEA Y GUARDE PARA FUTURAS REFERENCIAS.

PT_IMPORTANTE, RETER PARA REFERÊNCIA FUTURA: LEIA ATENTAMENTE.

DE_WICHTIG! SORFGFÄLTIG LESEN UND FÜR SPÄTERES NACHSCHLAGEN AUFBEWAHREN.

IT_IMPORTANTE! CONSERVARE IL PRESENTE MANUALE PER FUTURO RIFERIMENTO E LEGGERLO ATTENTAMENTE.

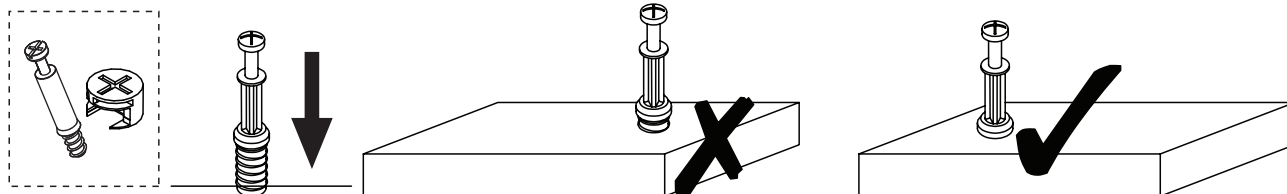

EN_QUICKFIT: Tighten quickfit until shoulder is flush with panel. Do not overtighten or undertighten.

FR_RACCORD RAPIDE: Faites serrer le raccord rapide jusqu'à ce que l'épaulement soit parfaitement encastré dans le panneau. Il ne faut ni trop serrer ni insuffisamment serrer.

ES_QUICKFIT: Apriete quickfit hasta que el hombro se descargue con el panel. NO lo sobreapriete ni lo apriete poco.

PT_AJUSTE RÁPIDO: Aperte o ajuste rápido até estar nivelada com o painel. Não apertar demasiado ou excessivamente.

DE_QUICKFIT: Ziehen Sie den Quickfit fest, bis die Schulter mit der Platte bündig ist. Bitte nicht zu fest oder zu schwach anziehen.

IT_MONTAGGIO RAPIDO: Stringere il montaggio rapido fino a quando la spalla è a filo con il pannello, non stringere troppo o troppo poco.

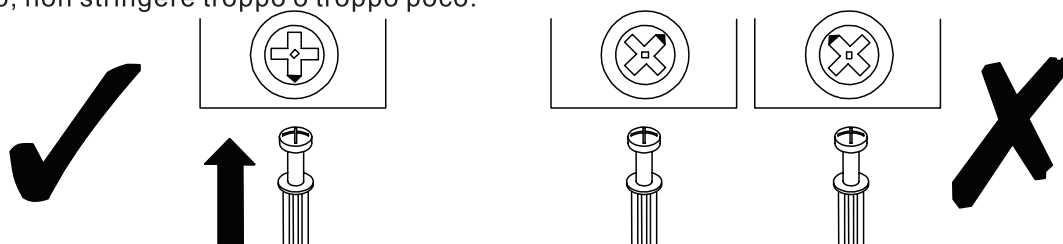

EN_CAM LOCK: When fitting cam lock, ensure starting position is correct before you insert connecting quickfit.

FR_SERRURE BATTEUSE: Avant d'insérer la serrure batteuse, veillez à la bonne orientation avant d'insérer le raccord rapide.

ES_CIERRE DE LA CÁMARA: Cuando instale el cierre de la cámara, asegúrese de que la posición de inicio es correcta antes de que inserte el quickfit conector.

PT_BLOQUEIO: Ao instalar o bloqueio, assegurar-se de que a posição inicial está correcta antes de inserir o encaixe de ligação rápida.

DE_CAM-LOCK: Achten Sie bei der Montage des Cam-Locks auf die richtige Ausgangsposition, bevor Sie den Quickfit einsetzen.

IT_BLOCCAGGIO A CAMMA: Quando si monta il bloccaggio a camma, assicurarsi che la posizione iniziale sia corretta prima di inserire il montaggio rapido di collegamento.

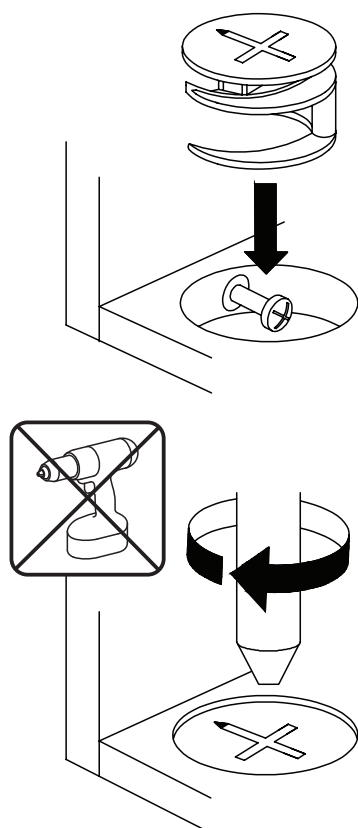

EN_Quickfit head should be in the centre of the cam lock when the two panels are joined.

Cam lock should be inserted before quickfit.

FR_Lorsque les deux panneaux sont assemblés, la tête du raccord rapide doit reposer au centre de la serrure batteuse.

Il faut insérer la serrure batteuse avant le raccord rapide.

ES_El cabezal del quickfit debe estar en el centro del cierre de la cámara cuando se unan los dos paneles.

Se debe insertar el cierre de la cámara antes que el quickfit.

PT_A cabeça de ajuste rápido deve estar no centro da fechadura quando os dois painéis estão unidos.

A fechadura de cames deve ser inserida antes de ser rápida.

DE_Der Quickfit-Kopf sollte sich in der Mitte des Cam-Locks befinden, wenn die beiden Platten zusammengefügt sind.

Der Cam-Lock sollte vor dem Quickfit eingesetzt werden.

IT_La testa del montaggio rapido deve trovarsi al centro del bloccaggio a camma quando i due pannelli sono uniti.

Il Bloccaggio a Camma deve essere inserito prima del montaggio rapido.

EN_Turn cam lock clockwise to tighten.

FR_Faites tourner la serrure batteuse dans le sens des aiguilles d'une montre pour la resserrer.

ES_Gire el cierre de la cámara en sentido horario para apretarlo.

PT_Rodar o bloqueio no sentido dos ponteiros do relógio para o apertar.

DE_Drehen Sie den Cam-Lock im Uhrzeigersinn, um ihn festzuziehen.

IT_Ruotare il bloccaggio a camma in senso orario per stringere.

NOTE DIFFERENT MODELS

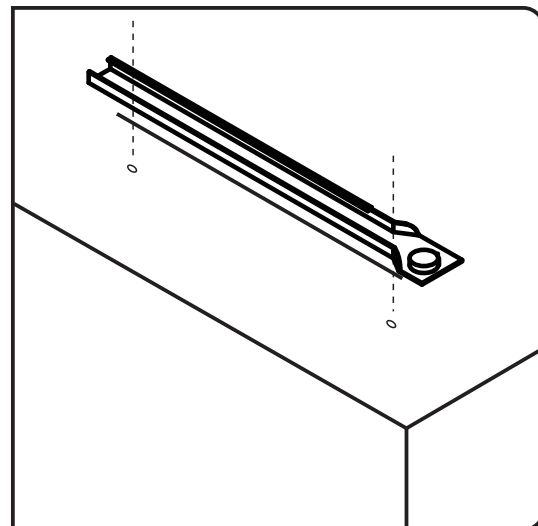
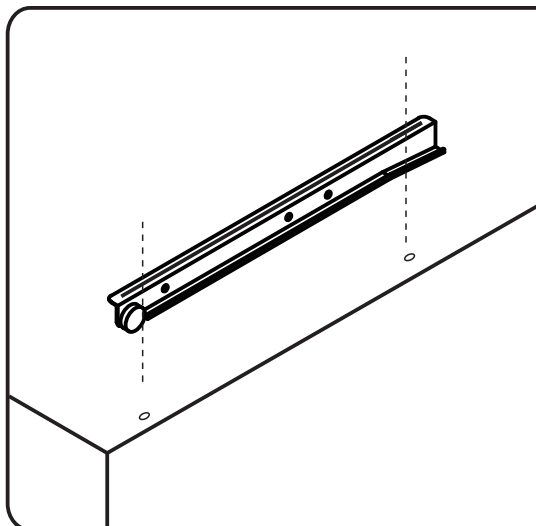
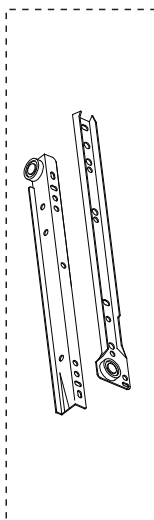

EN Please find the exact hole for installation, otherwise it will be misaligned. The screws on the drawer slide must be leveled, otherwise it will affect the smoothness of the drawer.

FR Identifiez le trou exact pour l'installation, sinon il sera mal aligné. Les vis de la glissière du tiroir doivent être nivelées, sinon cela affectera le fonctionnement du tiroir.

ES Al instalar, encuentre el orificio exacto; de lo contrario, estará desalineado. Los tornillos en las correderas del cajón deben estar nivelados, de lo contrario, afectará la suavidad al deslizar el cajón.

PT Por favor encontre o orifício exacto para instalação, caso contrário será desalinhado. Os parafusos na corredeira da gaveta devem ser nivelados, caso contrário afetará a suavidade da abertura da gaveta.

DE Bitte finden Sie das genaue Loch für die Installation, sonst wird es falsch ausgerichtet werden. Die Schrauben an der Schubladenführung müssen nivelliert werden, da sonst die Leichtgängigkeit der Schublade beeinträchtigt wird.

IT individuare il foro esatto per l'installazione, altrimenti ci sarà un disallineamento. Le viti sulla guida del cassetto devono essere allineate, altrimenti influirà sulla scorrevolezza del cassetto.

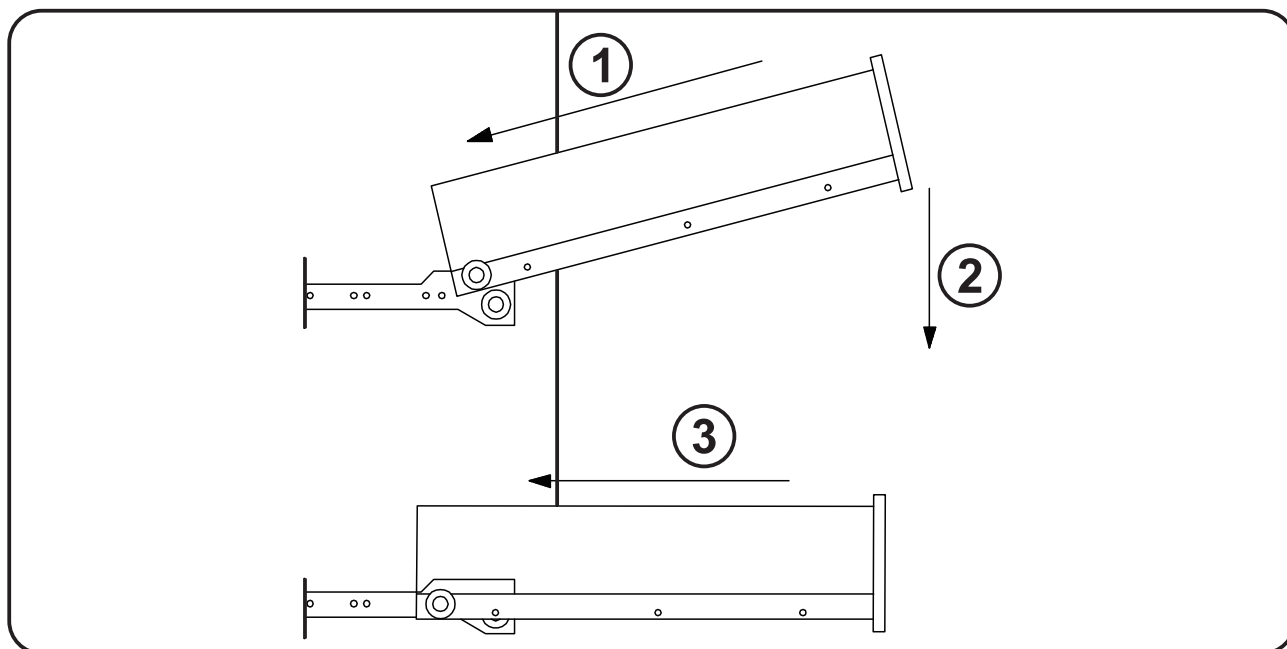

EN Be careful to push in the board when the both sides slide way been aligned.

FR Prenez soin d'enfoncer la planche lorsque les deux côtés de la glissière sont alignés.

ES Empuje con cuidado el tablero después de que los dos lados se hayan alineado.

PT Ter o cuidado de empurrar a placa quando os dois lados estiverem alinhados.

DE Achten Sie darauf, dass Sie die Platte einschieben, wenn die beiden Seiten so ausgerichtet sind, dass sie gleiten.

IT Fare attenzione quando si spinge il cassetto quando le due guide di scorrimento sono state allineate.

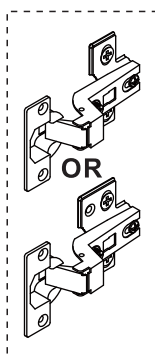

EN It may be necessary to adjust the hinges so that the doors align. Use the instructions below as a guide.

FR Il est parfois nécessaire d'ajuster les charnières pour un meilleur alignement des portes. Servez-vous des instructions ci-dessous comme guide.

ES Puede que sea necesario ajustar los quicios de forma que se alineen las puertas. Use las instrucciones que aparecen debajo como guía.

PT Pode ser necessário ajustar as dobradiças para que as portas fiquem alinhadas. Utilizar as instruções abaixo como guia.

DE Möglicherweise müssen Sie die Scharniere so einstellen, dass die Türen ausgerichtet sind. Verwenden Sie die nachstehenden Anweisungen als Leitfaden.

IT Potrebbe essere necessario regolare le cerniere in modo che le porte siano allineate. Per fare ciò attenersi alle istruzioni sottostanti.

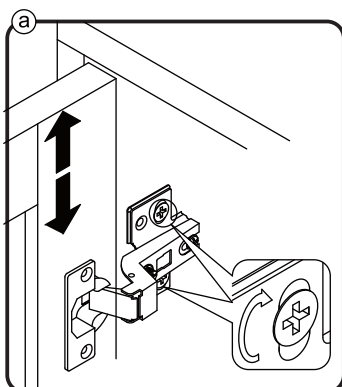

EN To adjust the door vertically loosen the screw as shown and move up and down as needed.

FR Si vous souhaitez régler la porte **verticalement**, desserrez la vis comme indiqué et déplacez la porte de haut en bas selon les besoins.

ES Para ajustar la puerta **verticalmente** afloje el tornillo tal y como se muestra y muévelo hacia arriba o hacia abajo según sea necesario.

PT Para ajustar a porta na vertical, soltar o parafuso mostrado e mover-se para cima e para baixo, conforme necessário.

DE Um die Tür **vertikal** auszurichten, lösen Sie die Schraube wie abgebildet und bewegen Sie sie nach Bedarf nach oben oder nach unten.

IT Per allineare la porta **verticalmente** allentare la vite come mostrato e spostarla in alto o in basso secondo necessità.

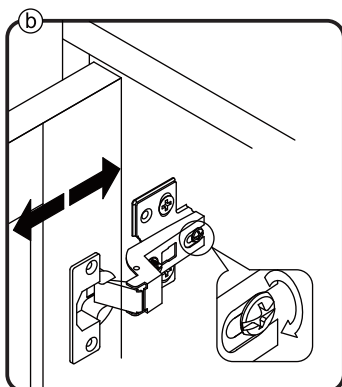

EN To adjust the gap from the door to the main frame turn the screw clockwise or anti-clockwise as needed.

FR Si vous souhaitez ajuster l'**écart** entre la porte et le cadre principal, tournez la vis dans le sens des aiguilles d'une montre ou dans le sens inverse, si nécessaire.

ES Para ajustar el **espacio** desde la puerta al marco principal, gire el tornillo en sentido horario o antihorario, según se necesite.

PT Para ajustar o espaço entre a porta e o quadro principal, rode o parafuso no sentido dos ponteiros do relógio ou anti-horário, conforme necessário.

DE Um den **Abstand** von der Tür zum Hauptrahmen auszurichten, drehen Sie die Schraube je nach Bedarf im oder gegen den Uhrzeigersinn.

IT Per regolare lo **spazio** tra la porta e il telaio principale, avvitare o svitare la vite secondo necessità.

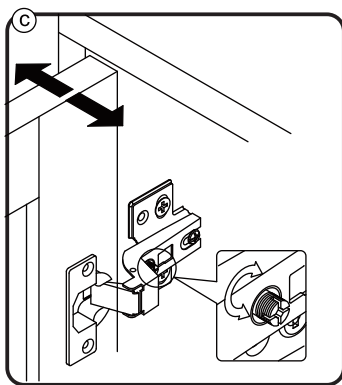

EN To adjust the door laterally adjust the screw as shown by turning clockwise or anti-clockwise.

FR Si vous souhaitez ajuster la porte **latéralement**, ajustez la vis comme indiqué en tournant dans le sens des aiguilles d'une montre ou dans le sens inverse des aiguilles d'une montre.

ES Para ajustar la puerta **lateralmente** ajuste el tornillo tal y como se muestra girándolo en sentido horario y antihorario.

PT Para ajustar a porta lateralmente ajustar o parafuso, conforme indicado, rodando no sentido dos ponteiros do relógio ou no sentido anti-horário.

DE Um die Tür **seitlich** auszurichten, stellen Sie bitte die Schraube wie abgebildet durch Drehen im oder gegen den Uhrzeigersinn ein.

IT Per allineare la porta **lateralmente** regolare la vite come mostrato, avvitandola o svitandola.

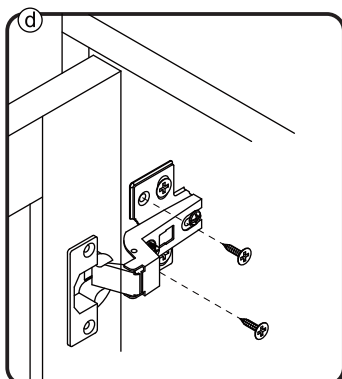

EN Please fix other screws

FR Merci de serrer les autres vis.

ES Fije los demás tornillos

PT Por favor fixe os outros parafusos

DE Befestigen Sie bitte die anderen Schrauben

IT Fissare le altre viti

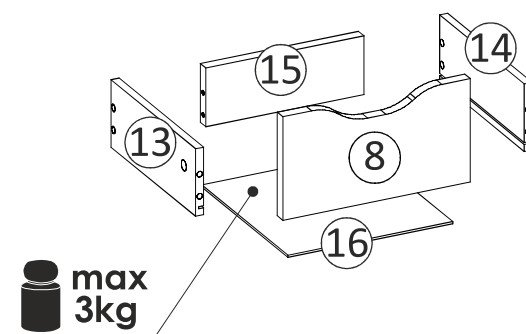
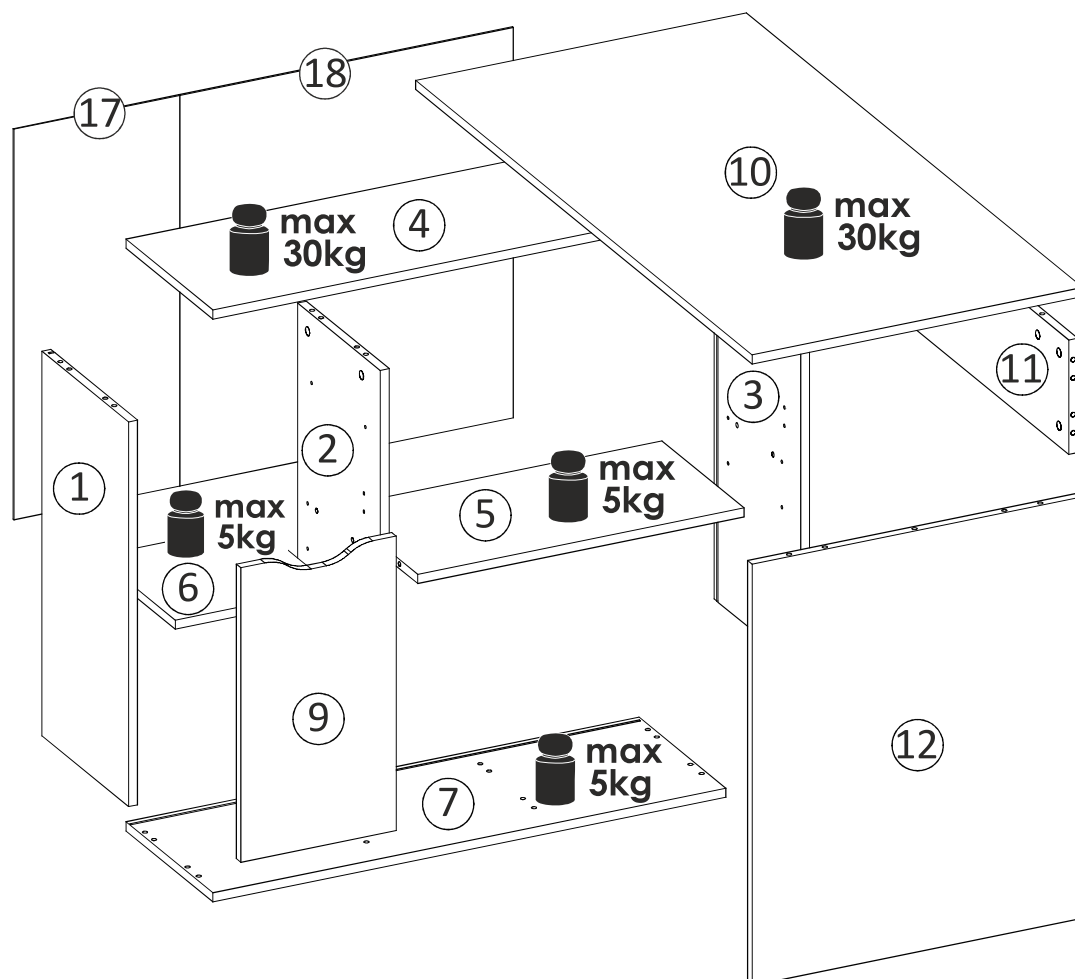

① x 1



673*309*16

② x 1

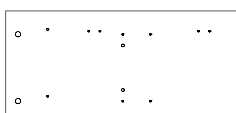

673*295*16

③ x 1

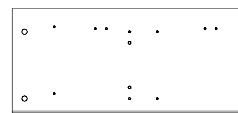

673*309*16

④ x 1

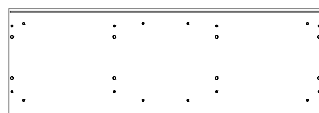

915*310*16

⑦ x 1

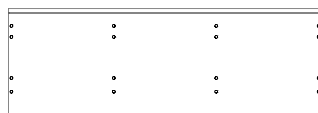

915*310*16

⑪ x 1



683*296*3

⑤ x 1



582*293*16

⑥ x 1



283*277*16

⑧ x 1

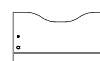

277*150*16

⑨ x 1

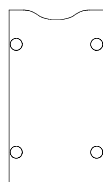

515*277*16

⑩ x 1

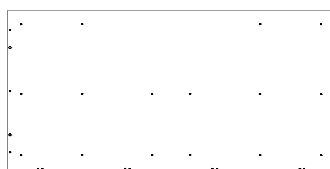

1200*590*16

⑪ x 1



1182*200*16

⑫ x 1

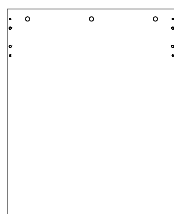

737*588*16

⑬ x 1



250*120*12

⑭ x 1



250*120*12

⑮ x 1



234*85*16

⑯ x 1



244*257*3

⑰ x 1

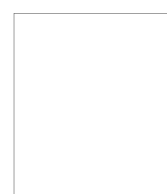

683*595*3

K2 x 20
Φ8*35

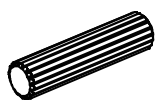

A1 x 6
Φ7*50

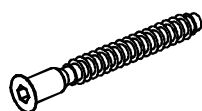

I x 1
hex4

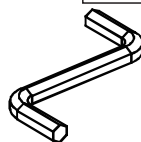

ZMN1 x 2
Φ20



ZMN x 19
Φ15



M1 x 19
Φ15*12



T2 x 21

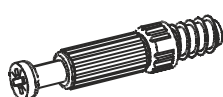

Z4 x 2

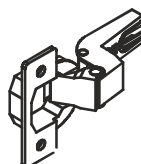

Z3 x 2

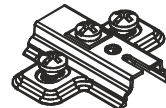

W1 x 4
Φ3,5*16



W5 x 4
Φ6,3*13



F1 x 4



G2 x 8



D5 x 2



O2 x 5

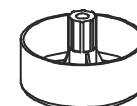

R5 x 1
250mm

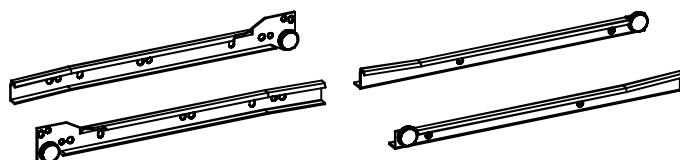

G3 x 5

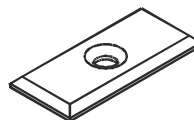

W10 x 12
Φ3*20



M2 x 2
Φ15*10



T5 x 4

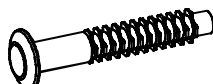

O6 x 4

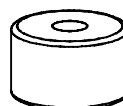

W6 x 4
Φ6,3*45



P3 x 28
Φ5



P4 x 16
Φ8



P5 x 2
Φ35



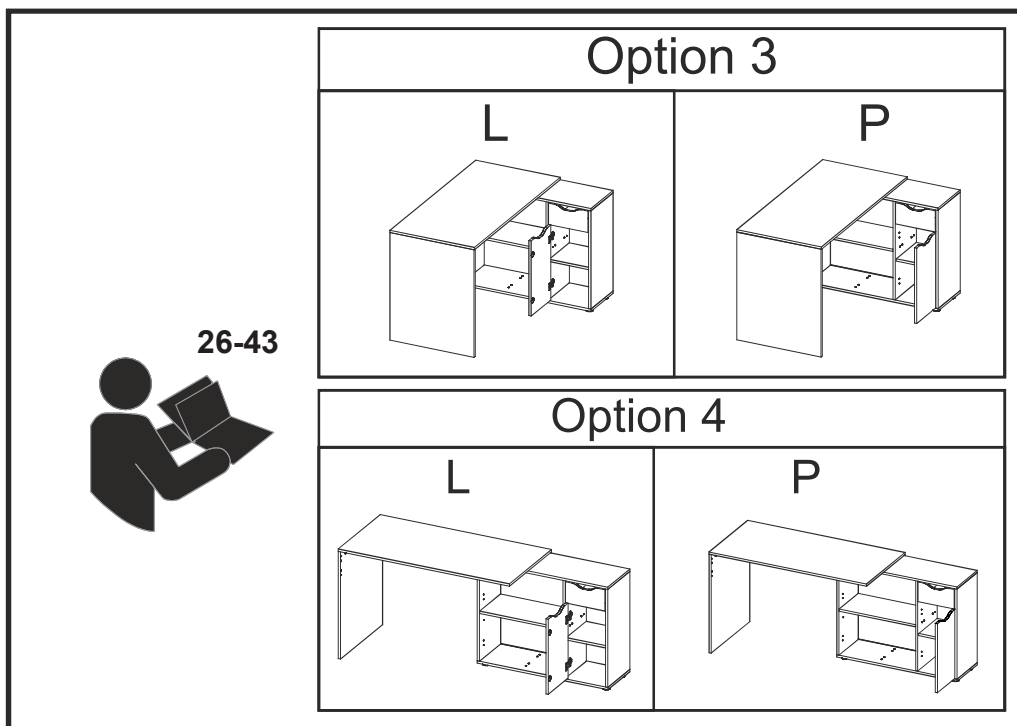
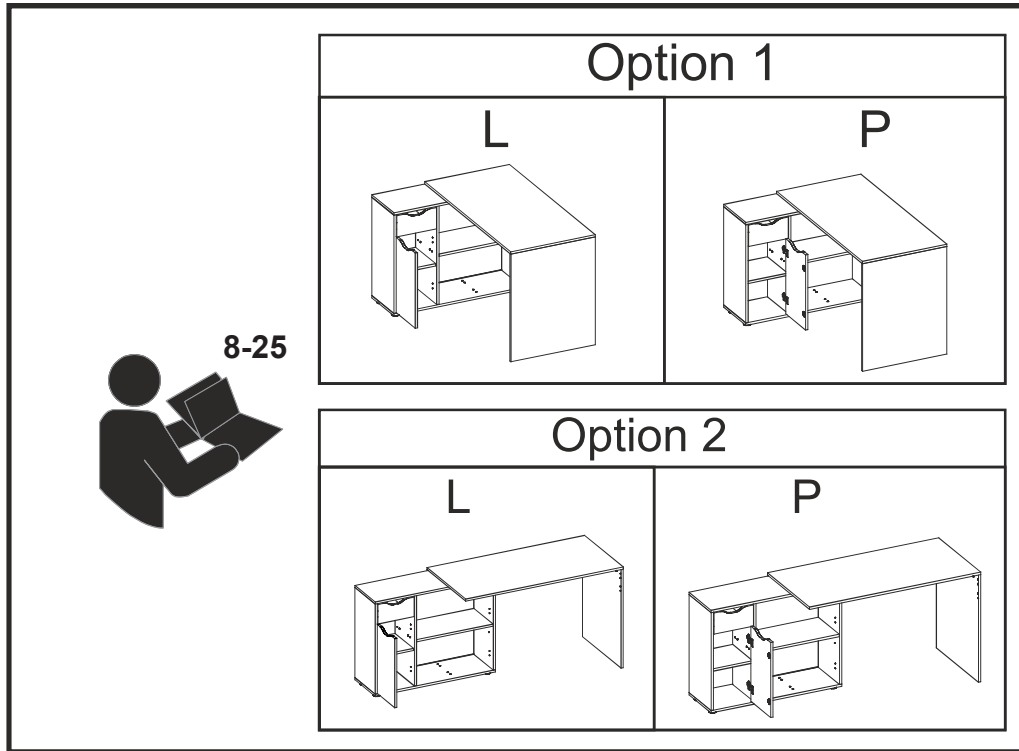



4 x F1

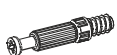

2 x T2

Ø8x35



8 x K2

Ø15x12



4 x M1

Ø5



12 x P3

Ø8



4 x P4

Ø6,3x13



4 x W5

250mm



1 x R5

Option 1

L

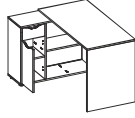

P

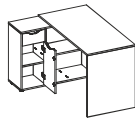

Option 2

L

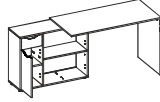

P

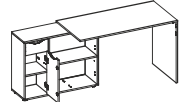

10-27



W5

W5

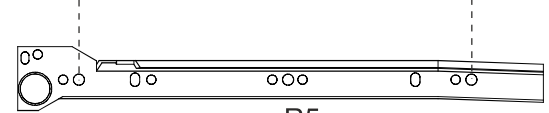

R5

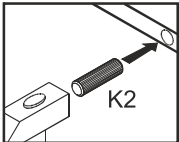

K2

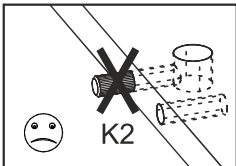

K2

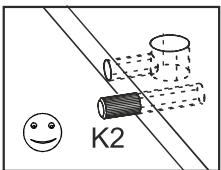

K2

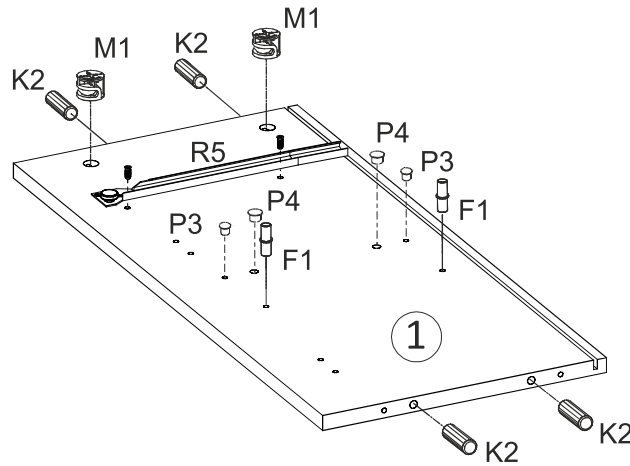

1

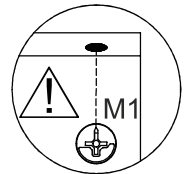

M1

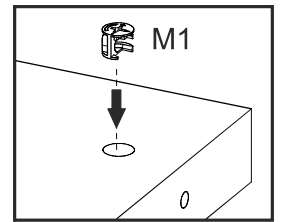

M1

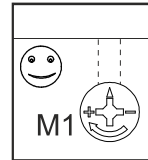

M1

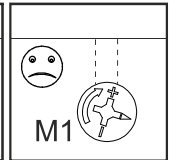

M1

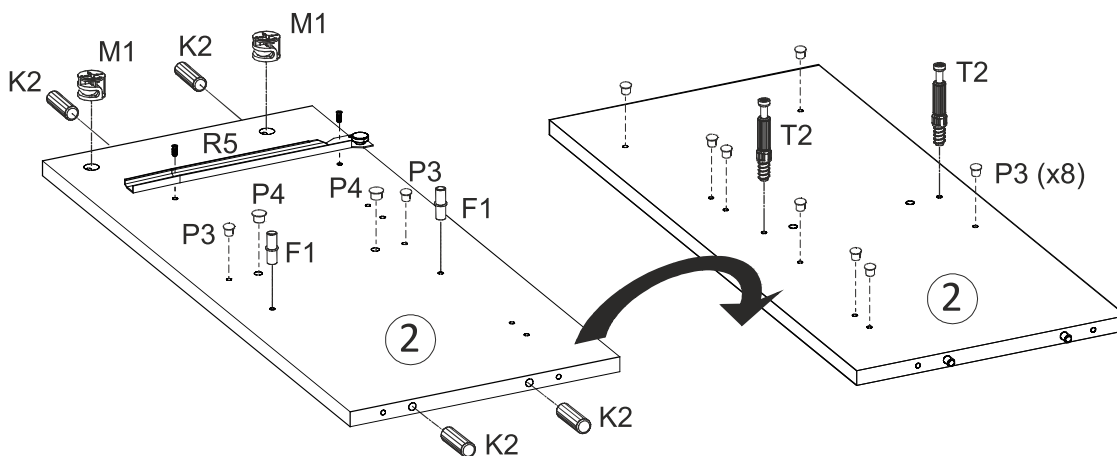

2

2

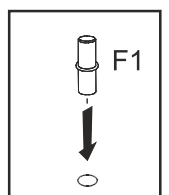

F1

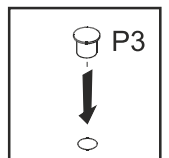

P3

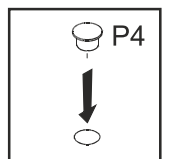

P4

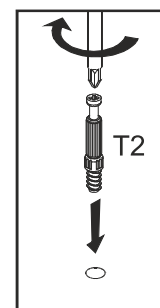

T2

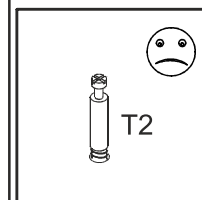

T2

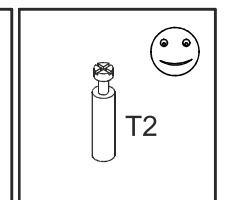

T2

W5

W5

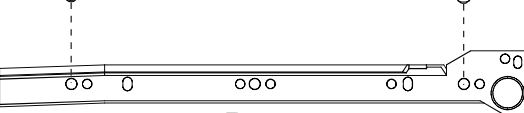

R5

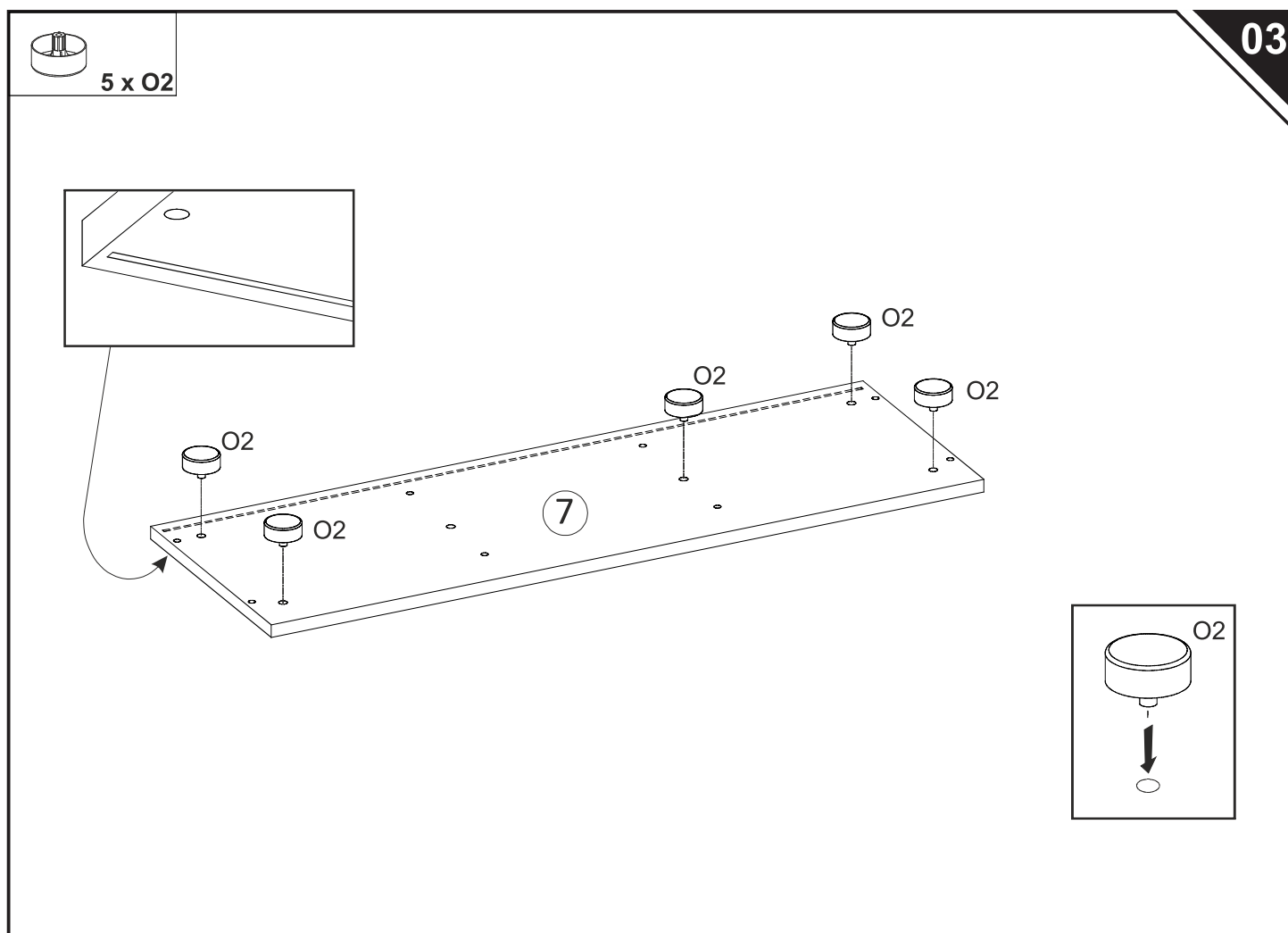
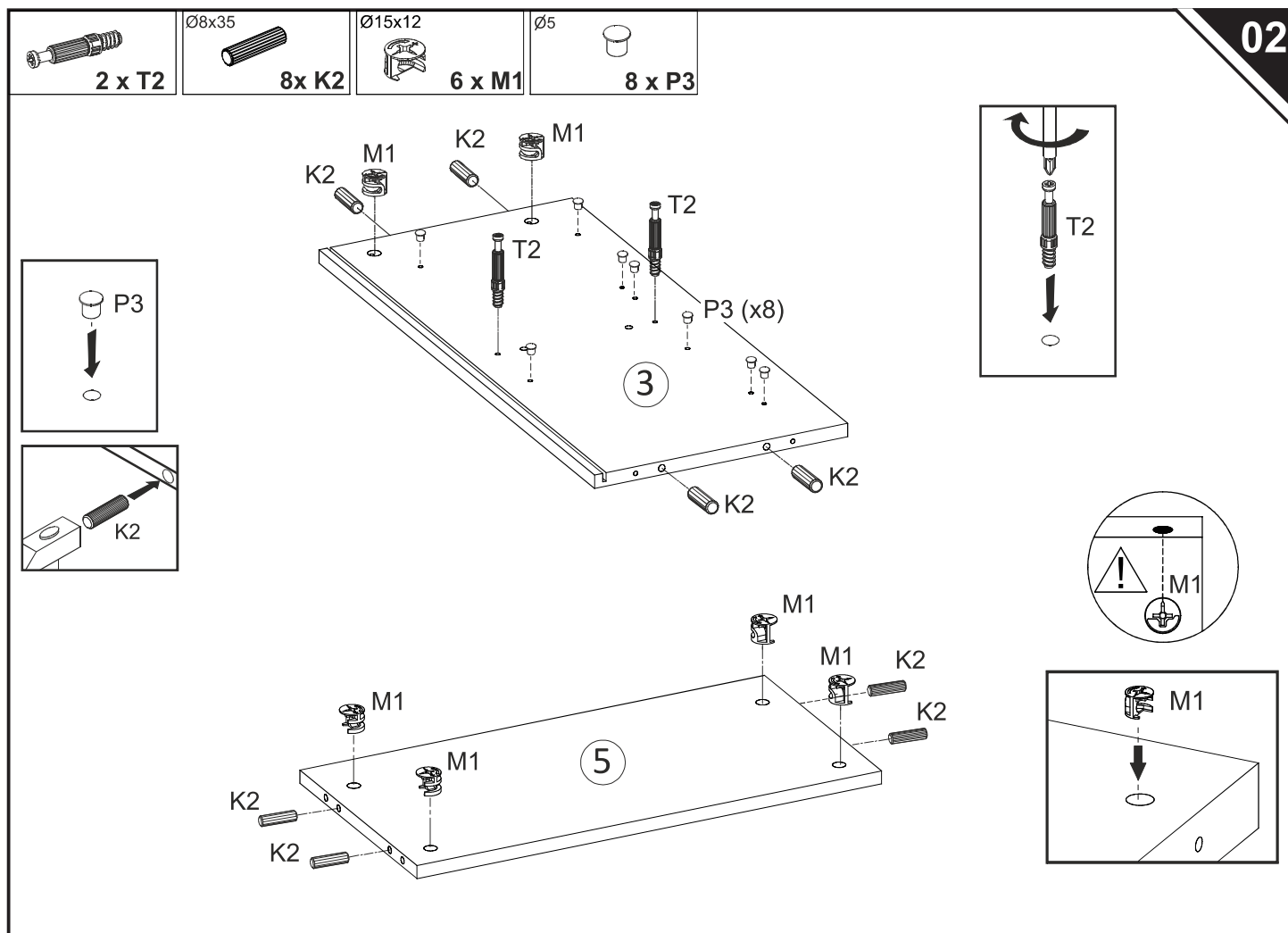

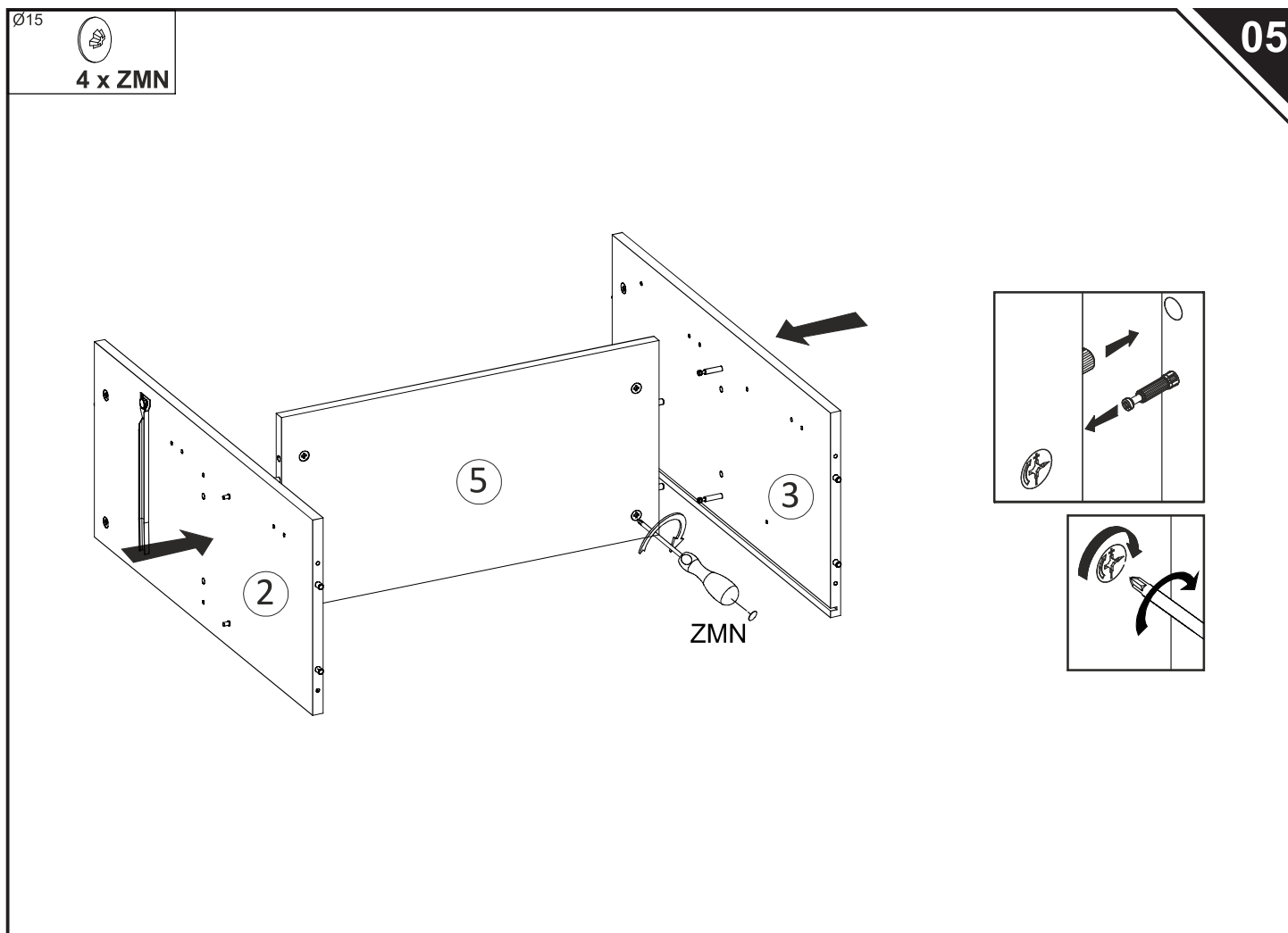
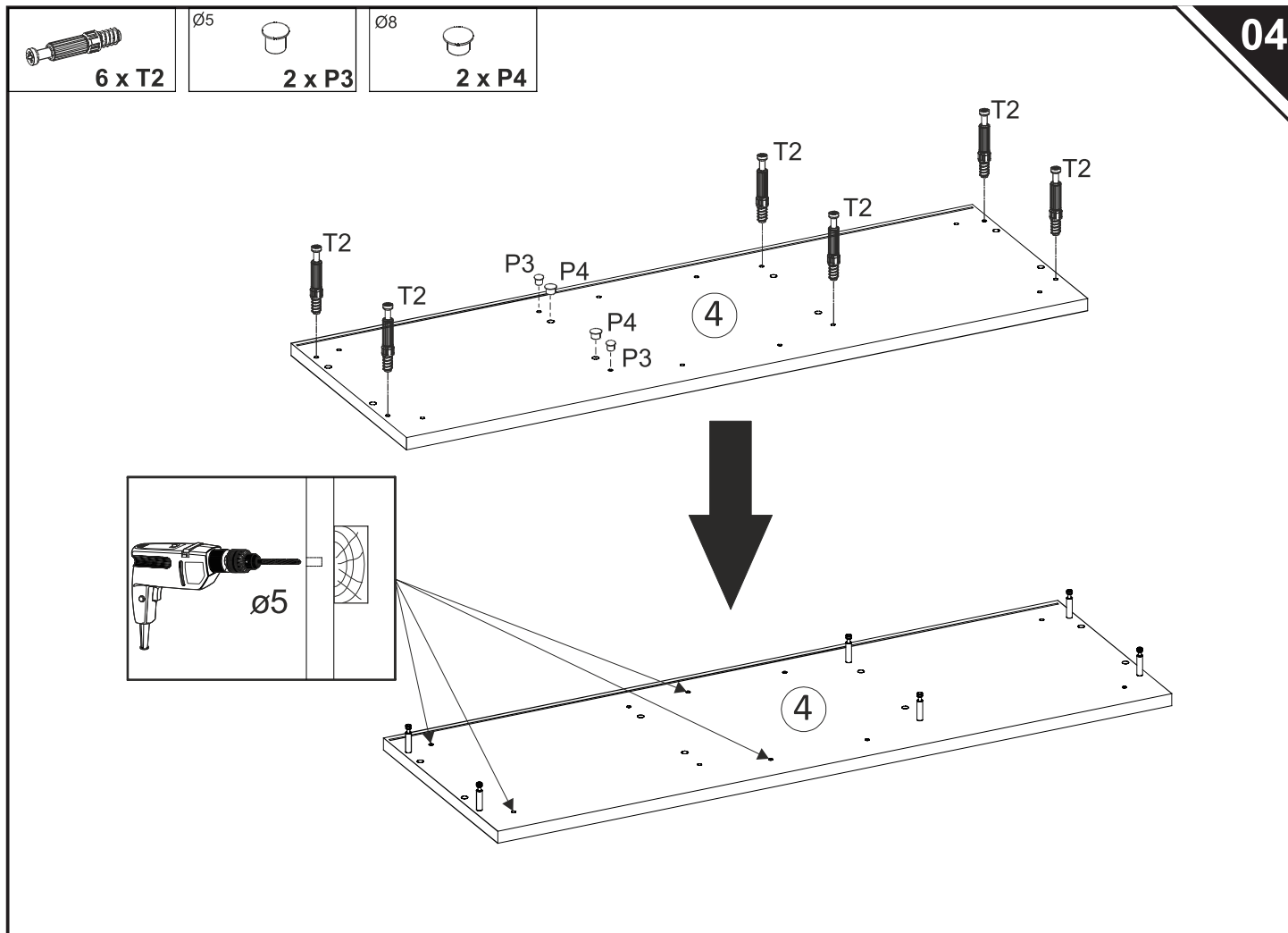

Ø7x50



6 x A1

hex 4



1 x I

06

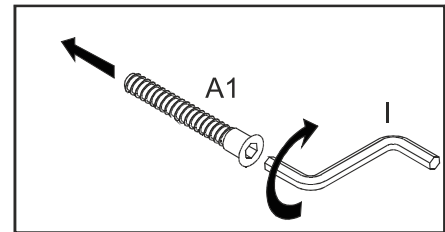
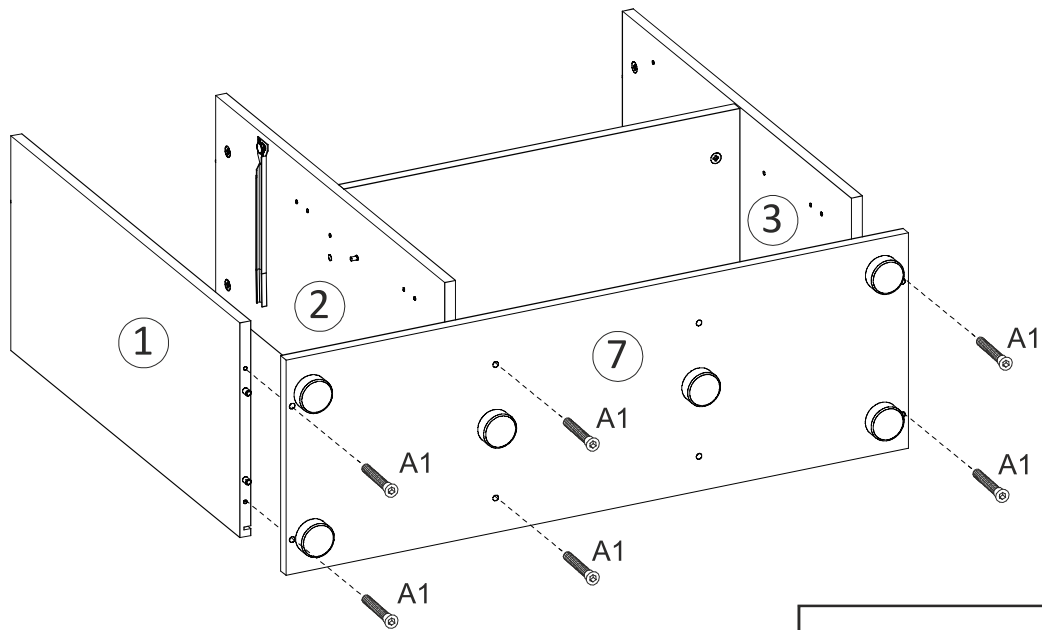

07

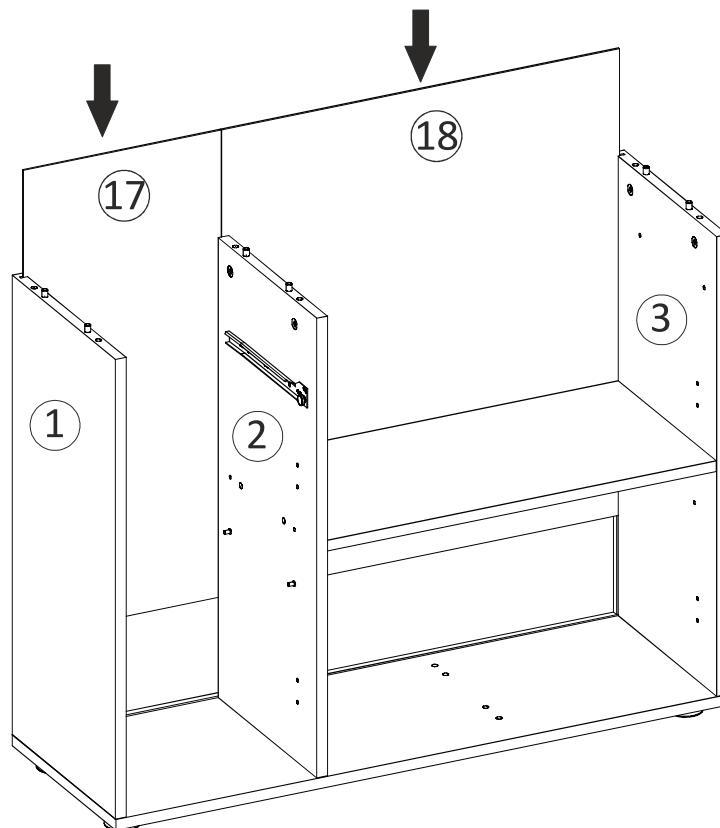



6 x ZMN

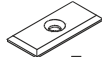
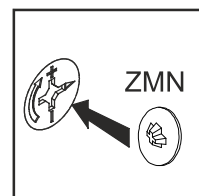
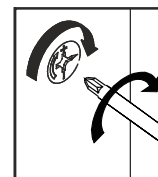
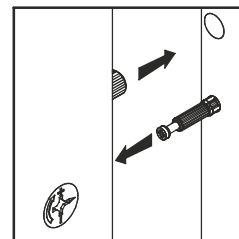
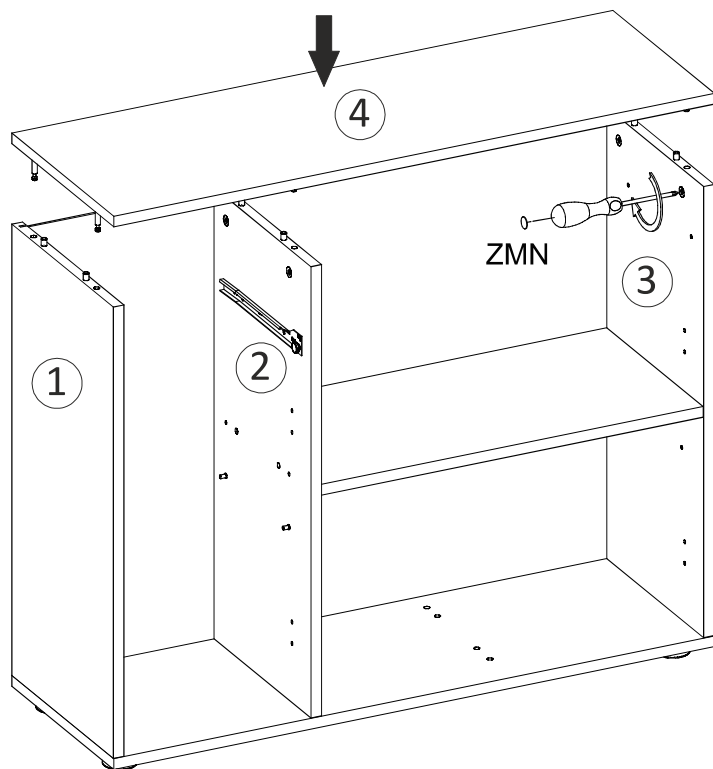

5 x G3

Ø3x20



5 x W10



8 x G2

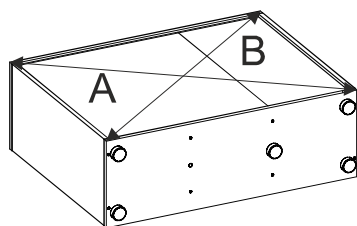
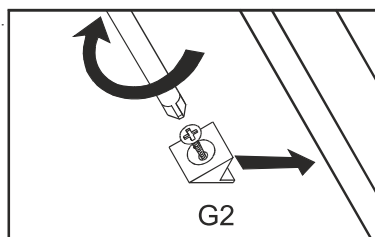
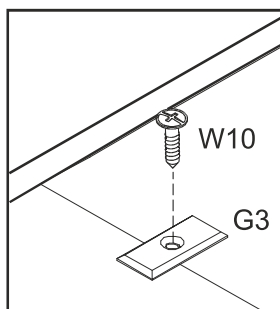

A=B

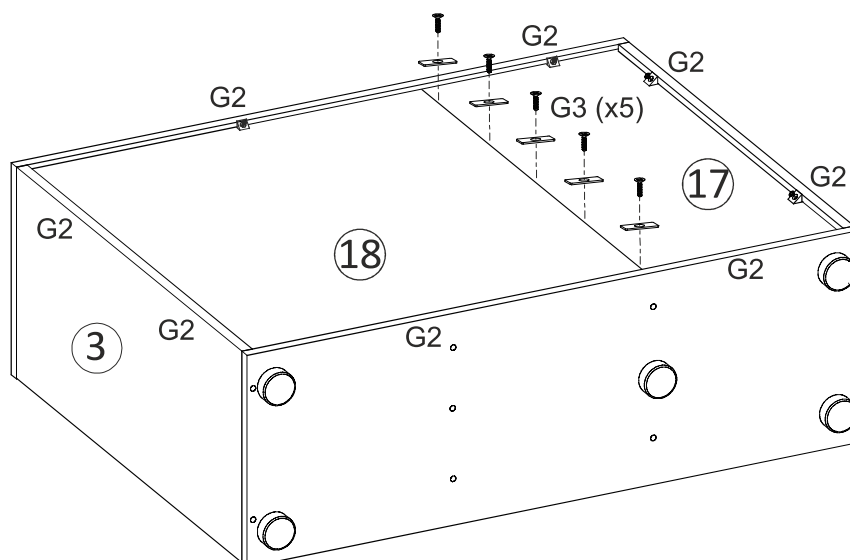



2 x Z3

Ø5



4 x P3



Option 1

P

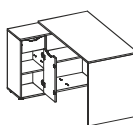

Option 2

P

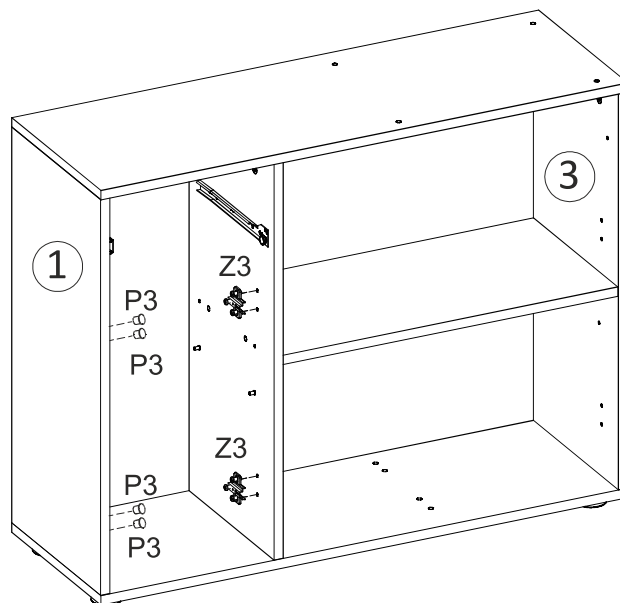
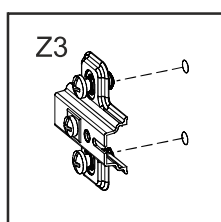
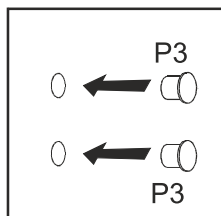
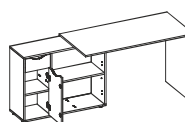

2 x Z3

Ø5



4 x P3



Option 1

L

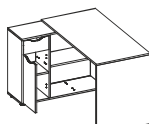

Option 2

L

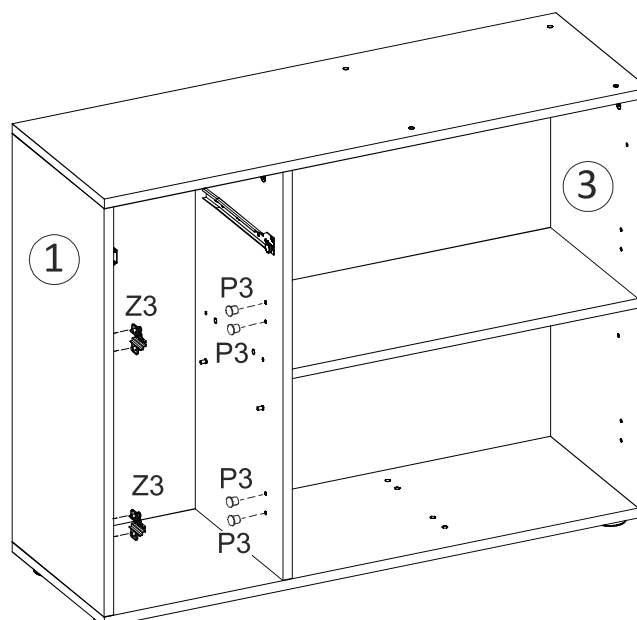
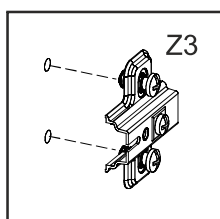
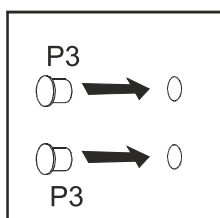
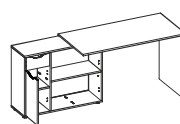

9 x T2

4 x K2

9 x M1

2 x P3

6 x P4

2 x D5

Ø15



2 x ZMN

12

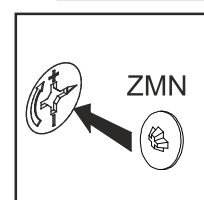
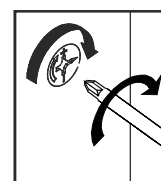
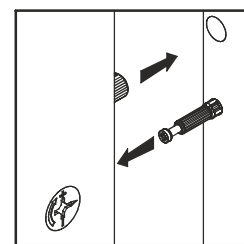
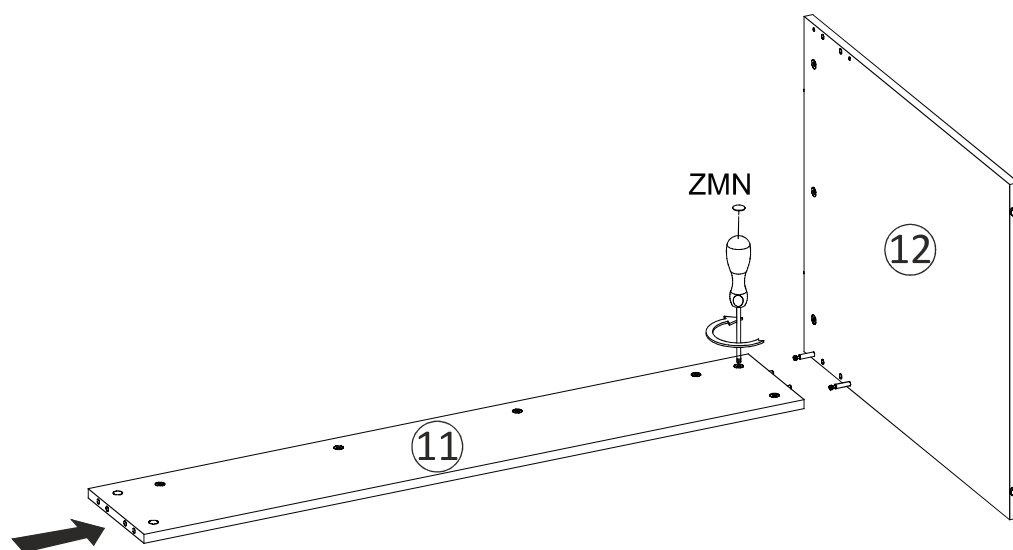

Ø15



7 x ZMN

13

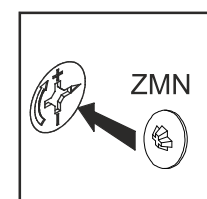
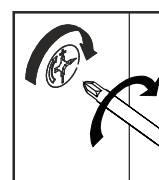
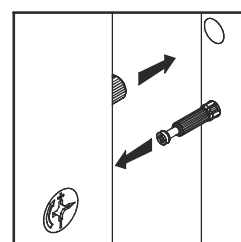
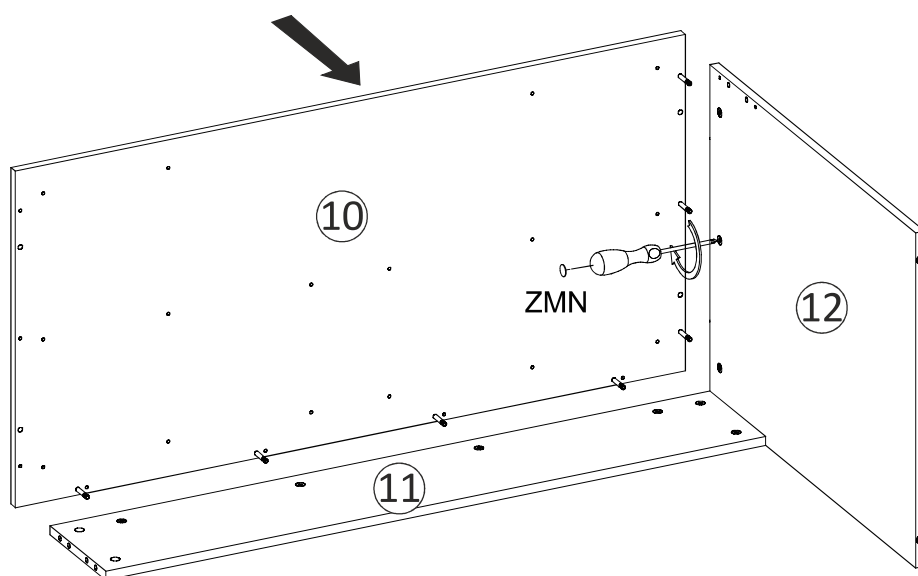



4 x O6

Ø6,3x45



4 x W6

Ø8



4 x P4



Option 1

L

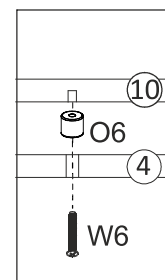
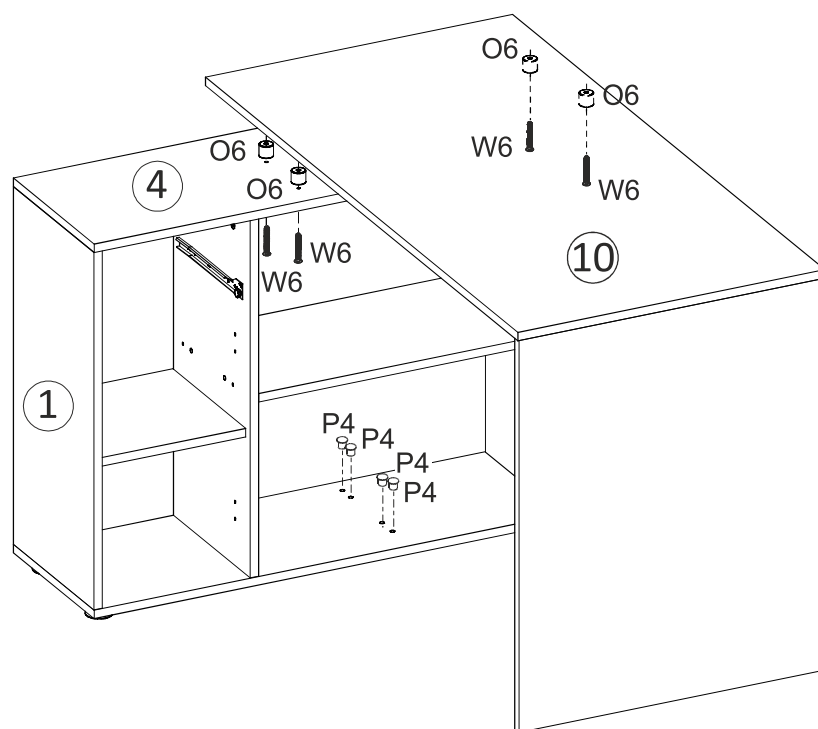
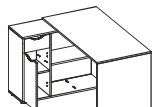

4 x O6

Ø6,3x45



4 x W6

Ø8



4 x P4



Option 1

P

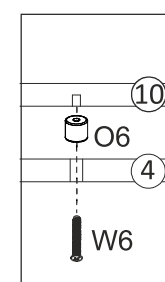
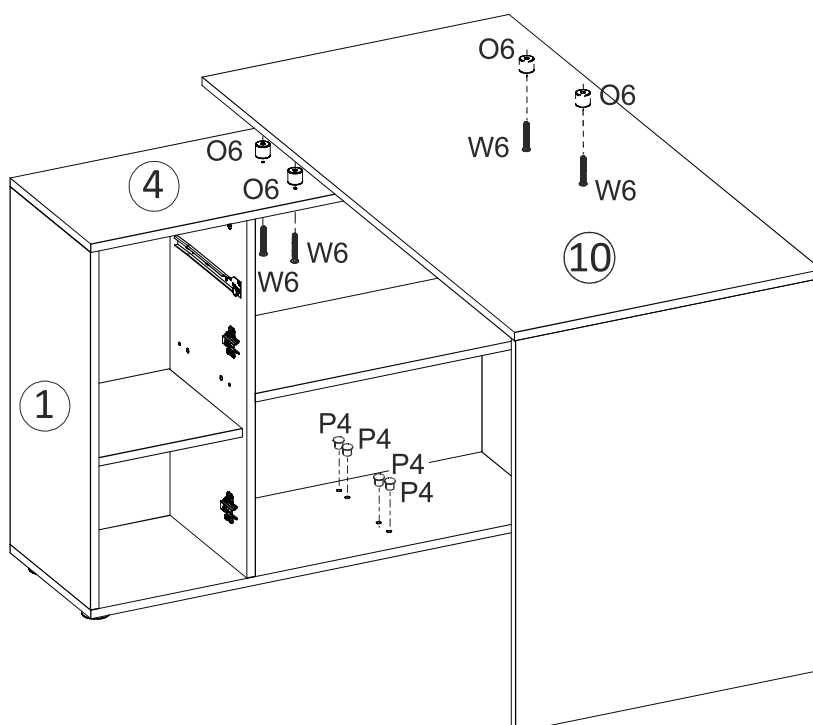
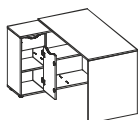



4 x O6

Ø6,3x45



4 x W6

Ø8



4 x P4



Option 2

L

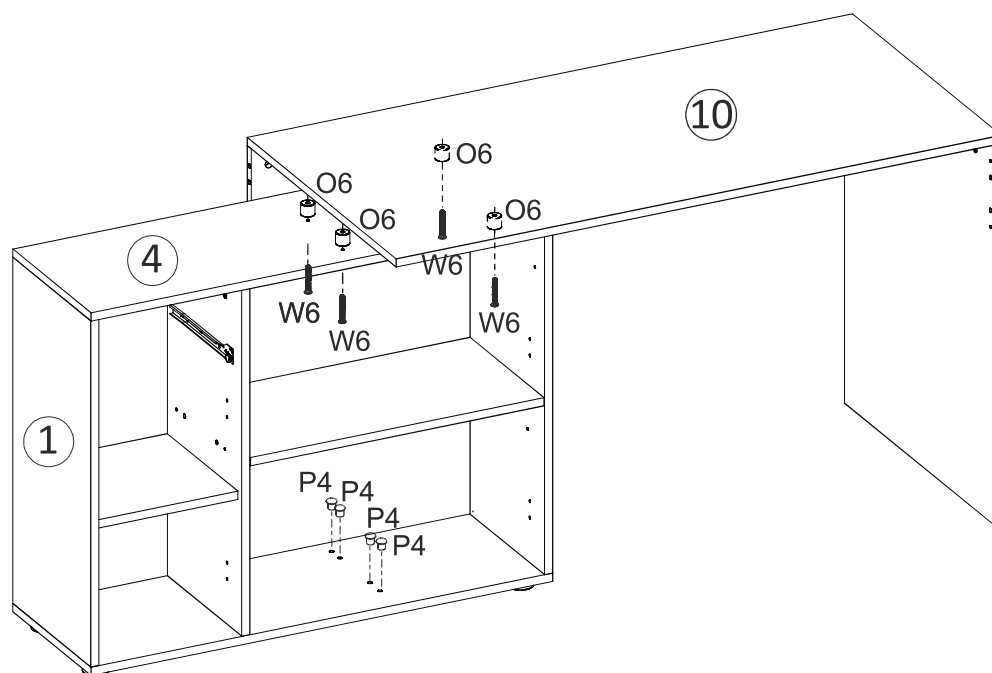
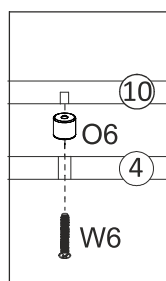
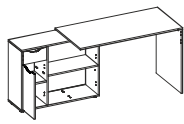

4 x O6

Ø6,3x45



4 x W6

Ø8



4 x P4



Option 2

P

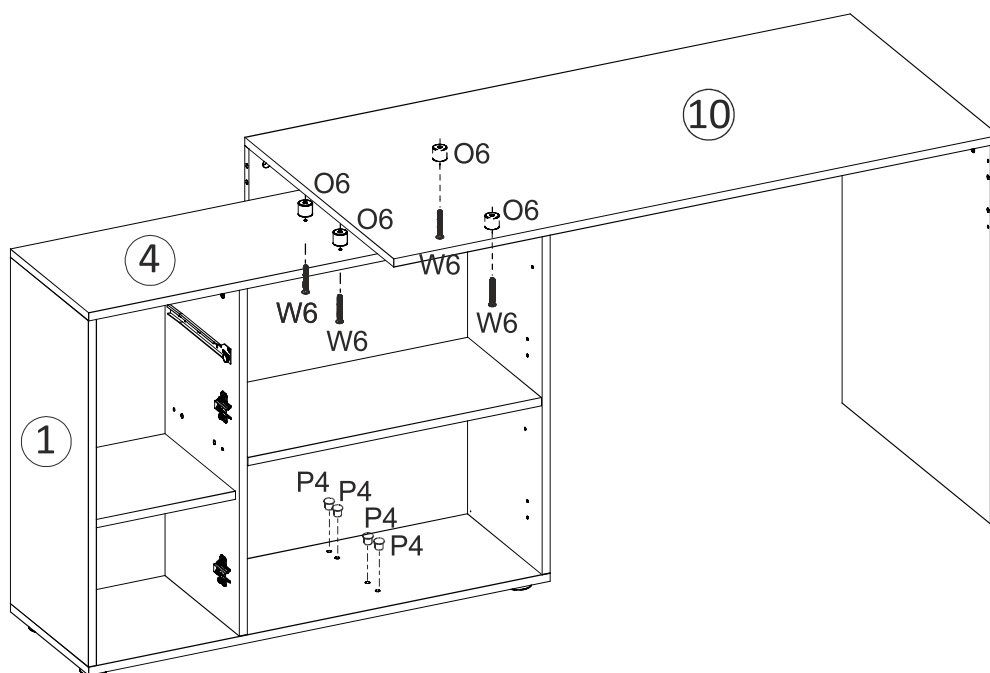
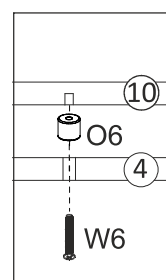
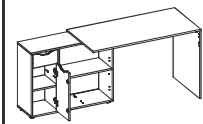

Ø15x10



2 x M2

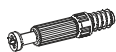

2 x T2

16

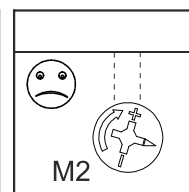
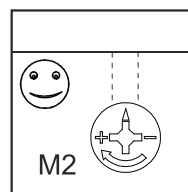
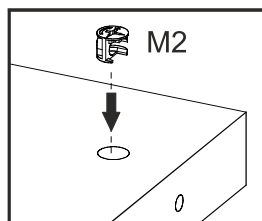
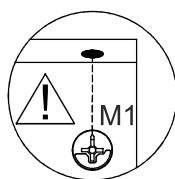
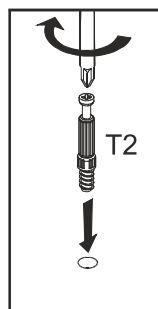
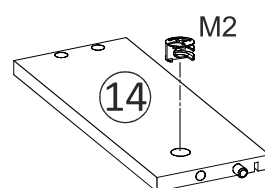
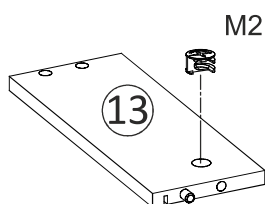
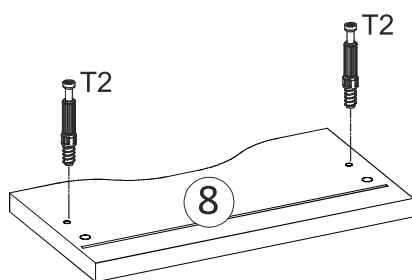

4 x T5

17

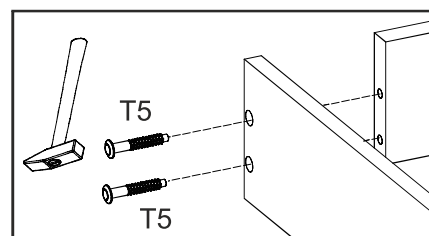
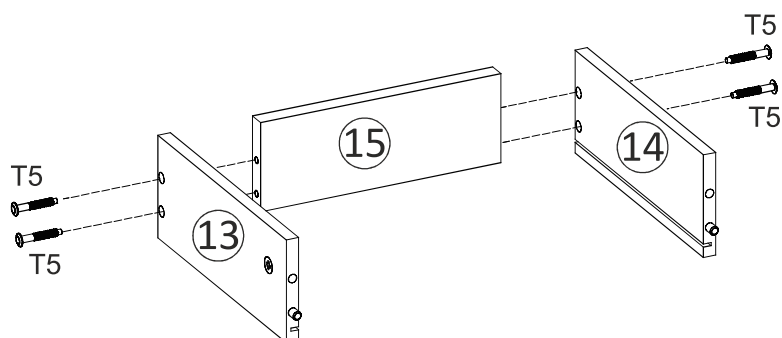

Ø20

2 x ZMN1

18

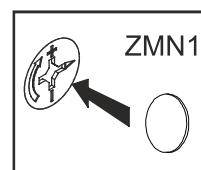
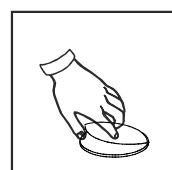
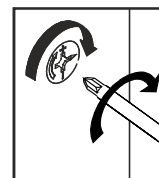
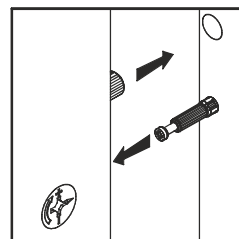
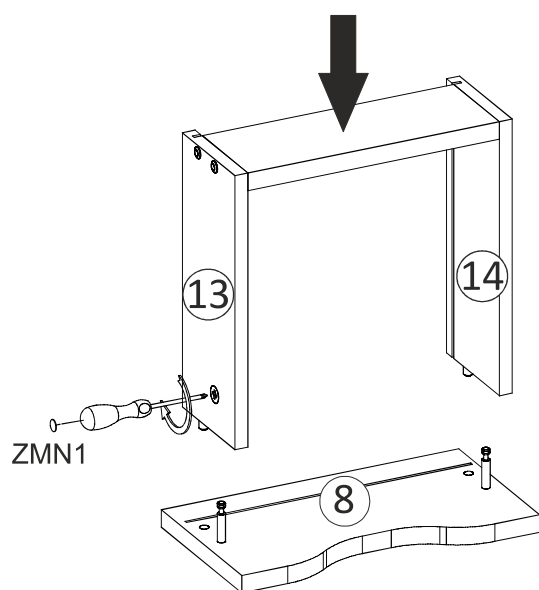

19

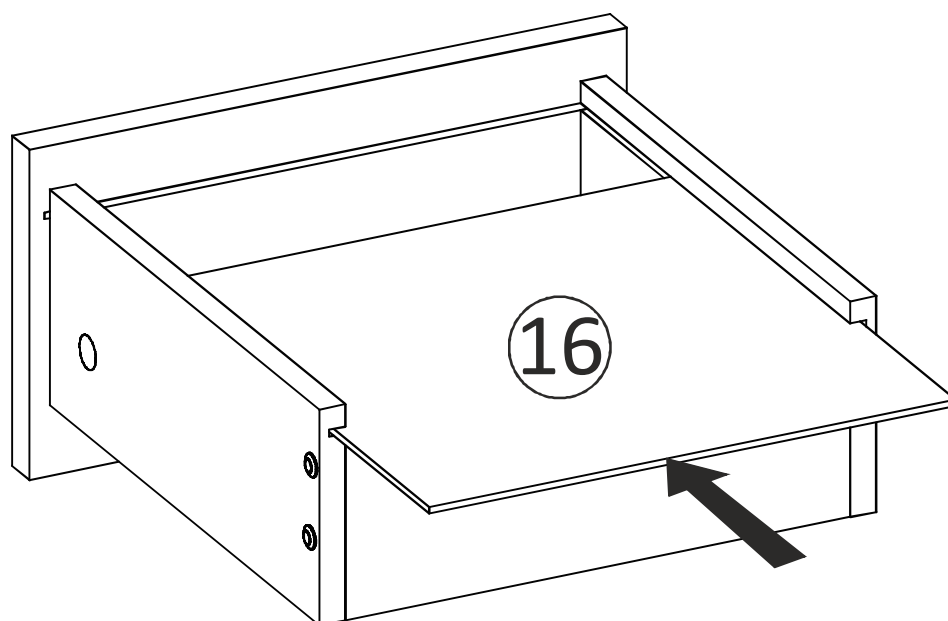

Ø3x20



3 x W10

20

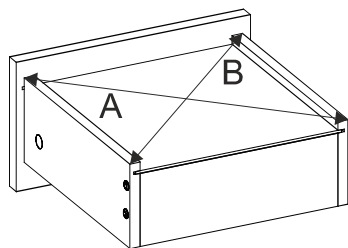

$A=B$

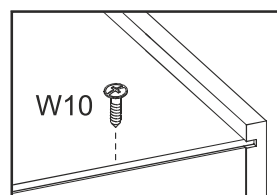
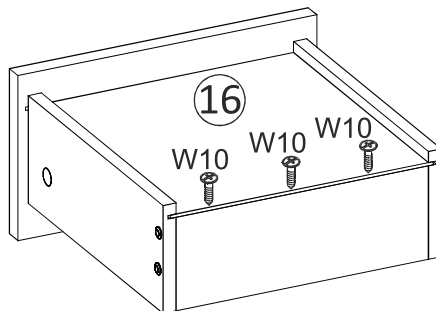
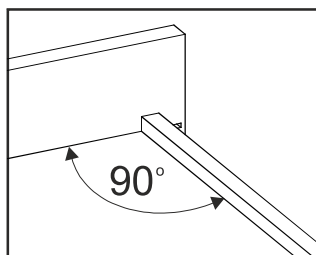

Ø3x20



4 x W10

250mm

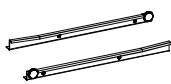

1 x R5

21

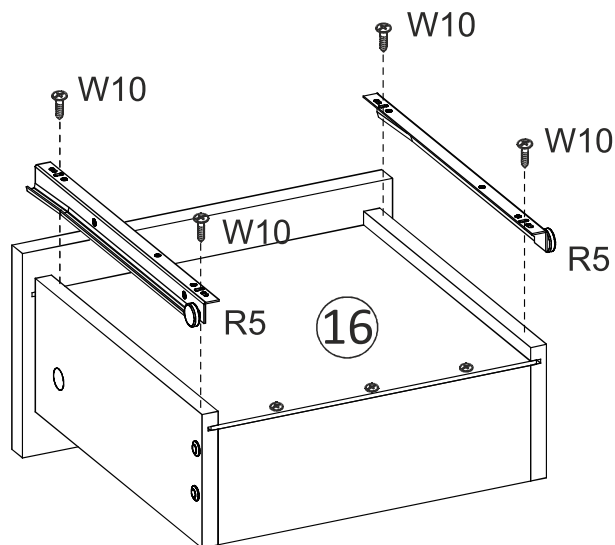
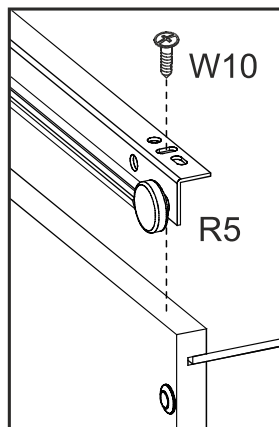



2 x Z4

Ø3,5x16



4 x W1

Ø35



2 x P5

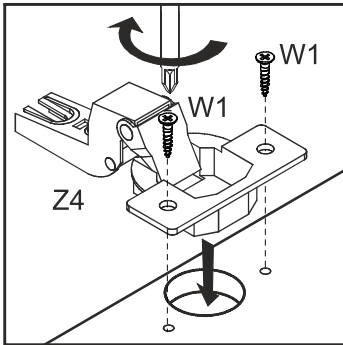
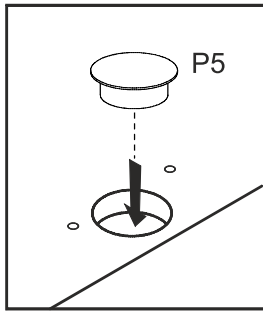

Option 1

L

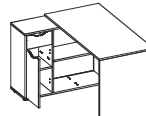

Option 2

L

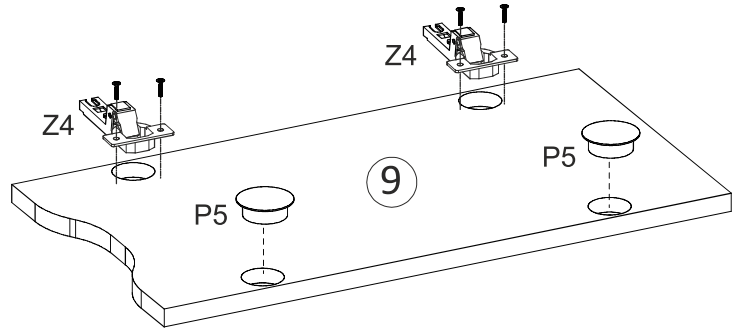
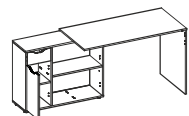

2 x Z4

Ø3,5x16



4 x W1

Ø35



2 x P5

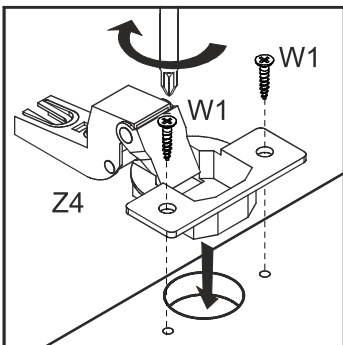
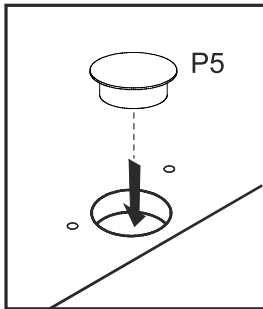

Option 1

P

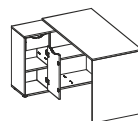

Option 2

P

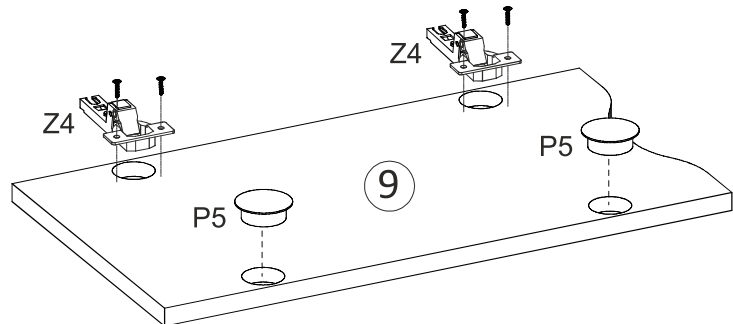
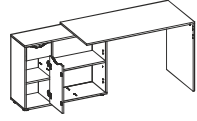

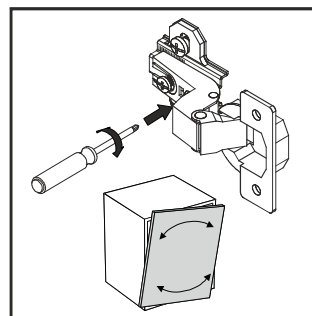
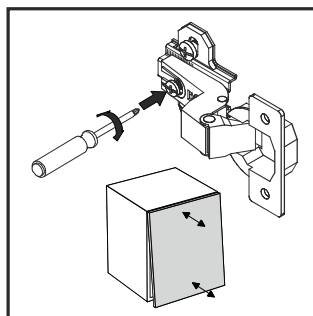
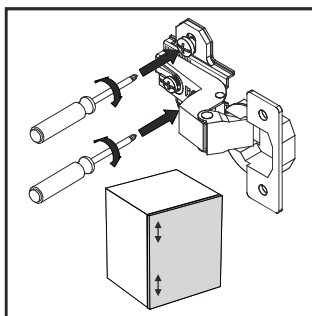
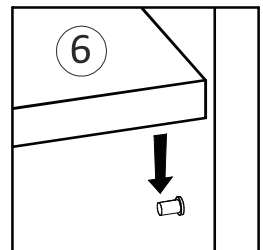
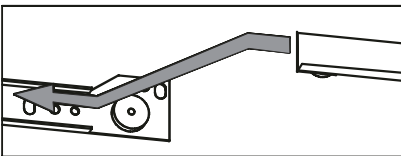
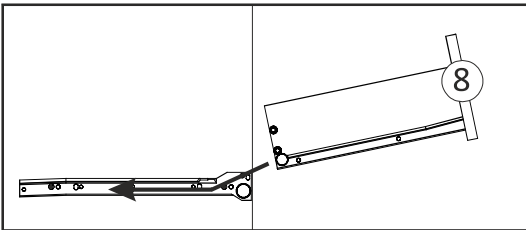
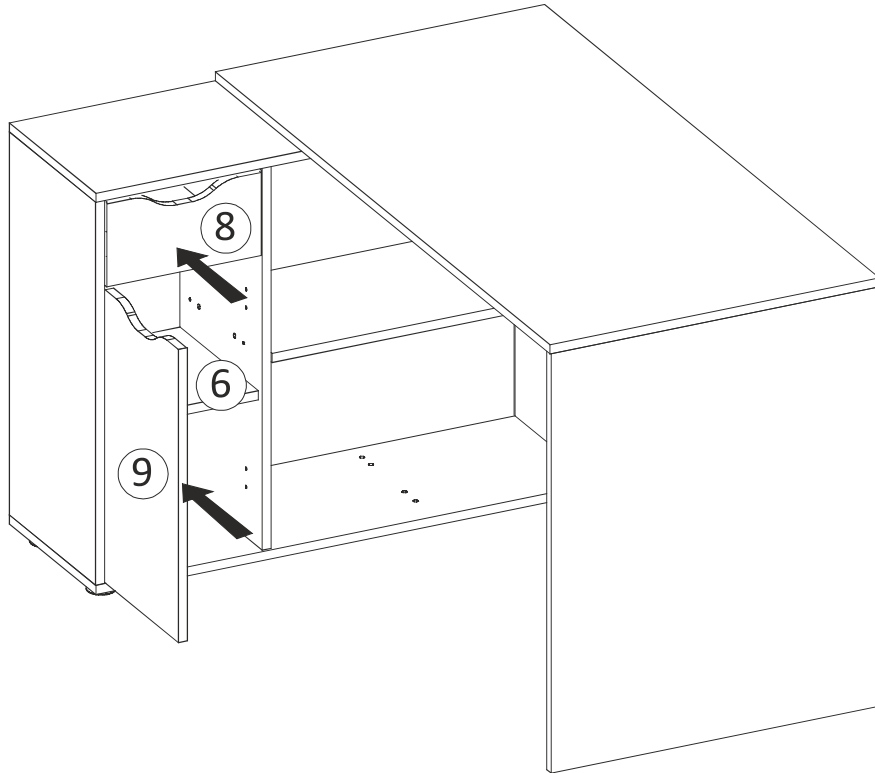
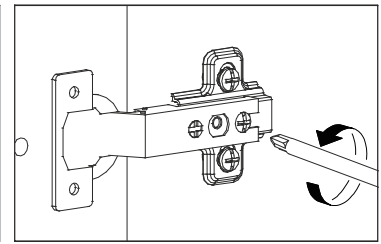
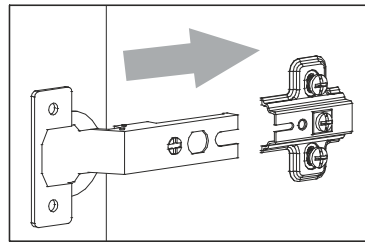
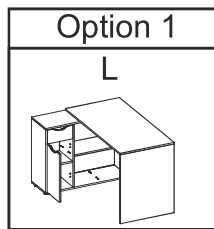

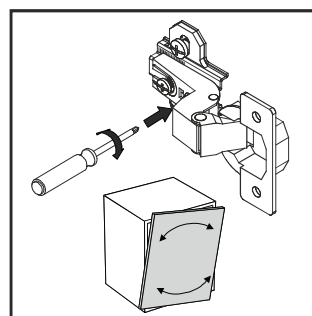
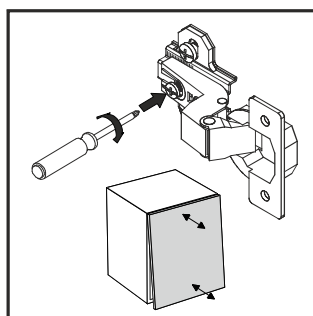
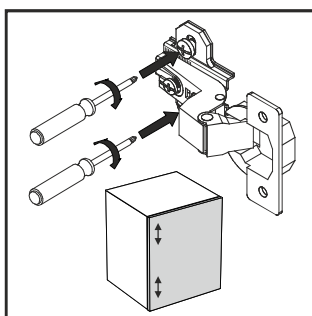
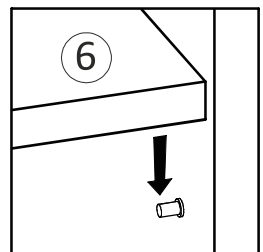
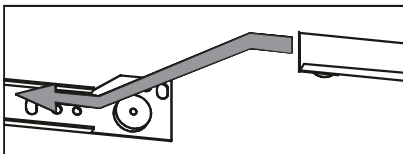
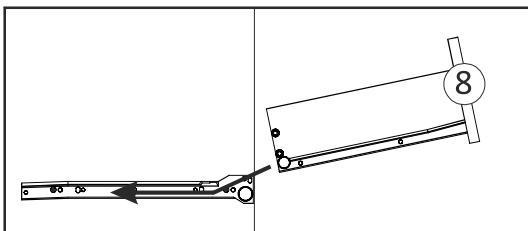
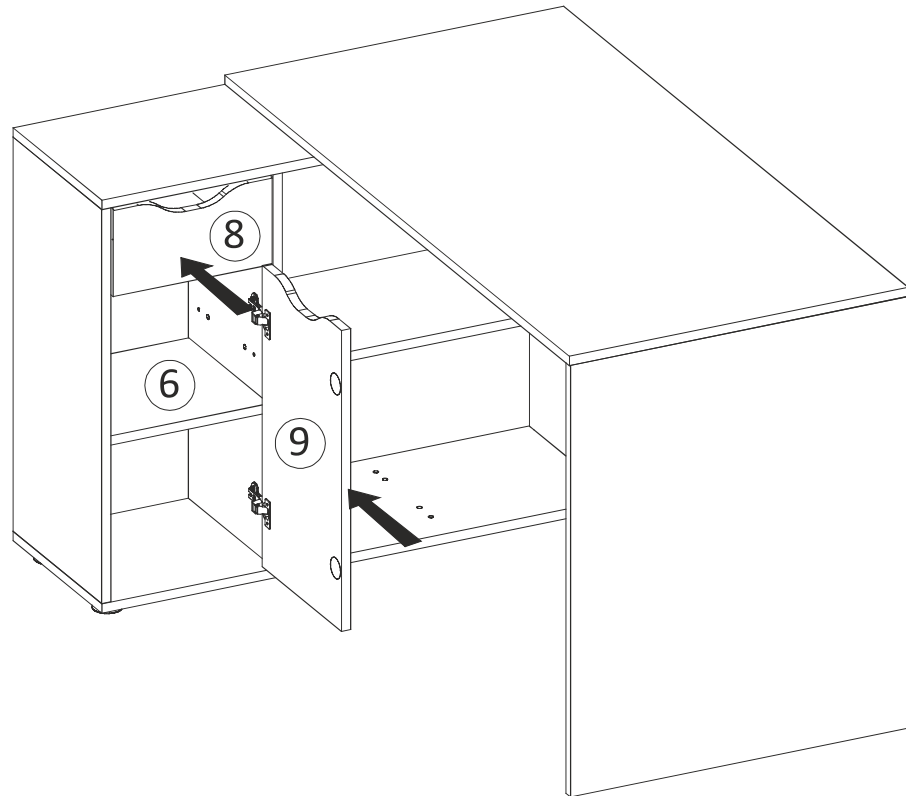
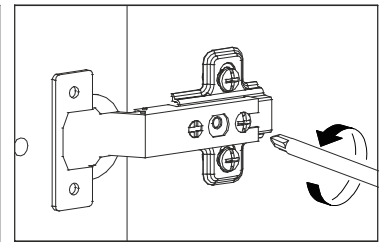
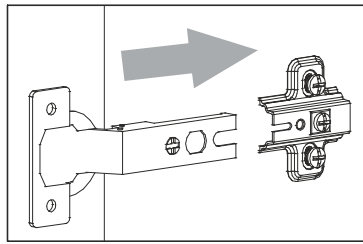
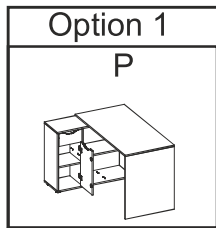

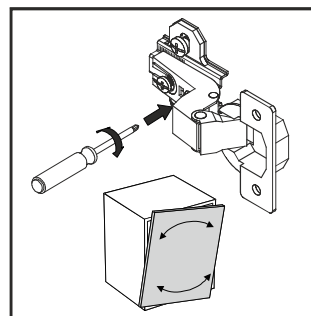
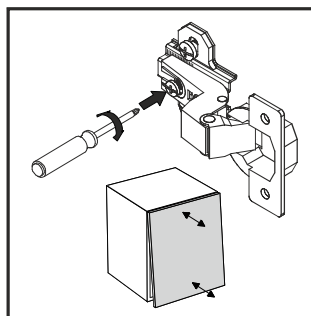
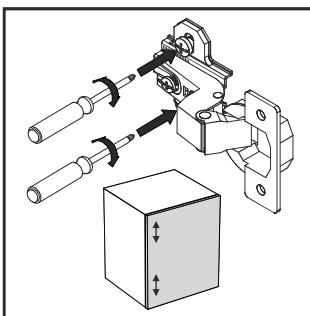
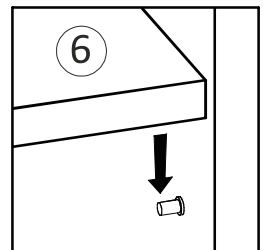
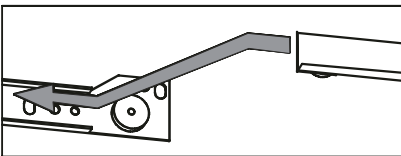
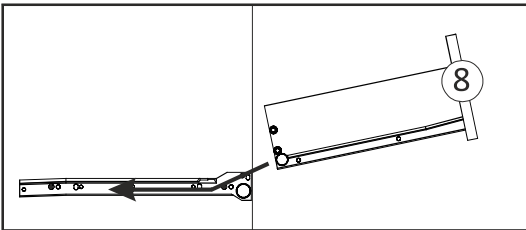
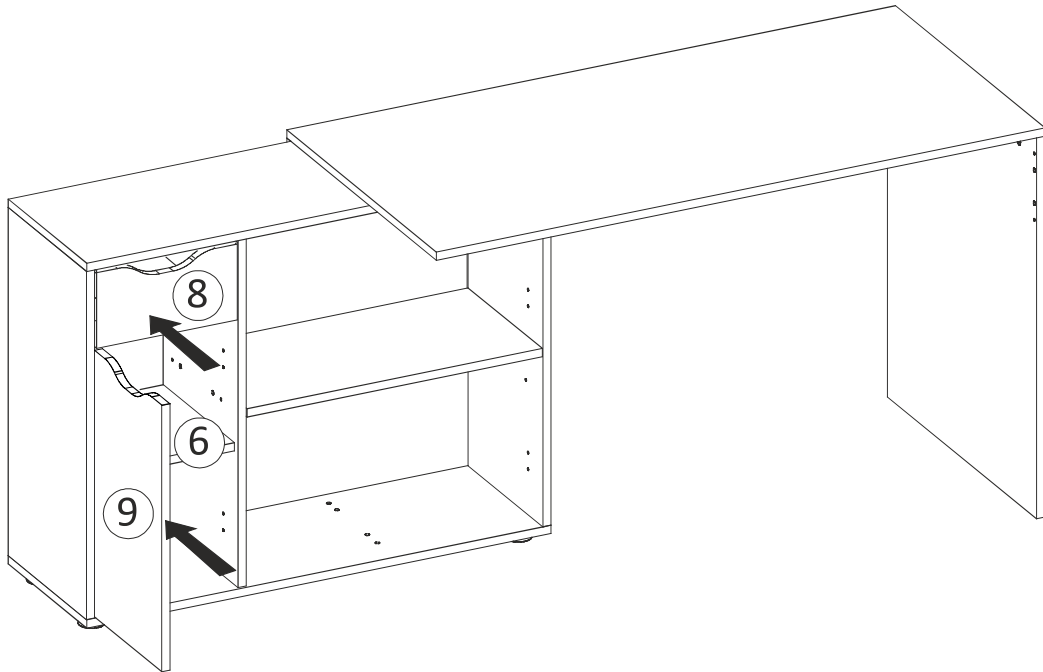
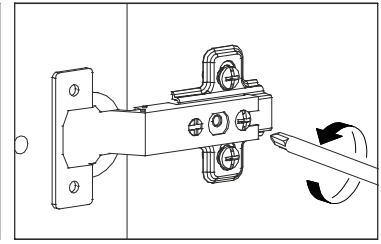
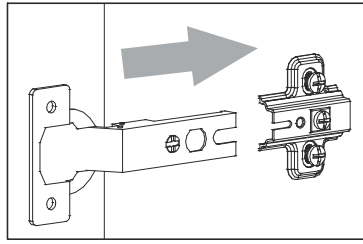
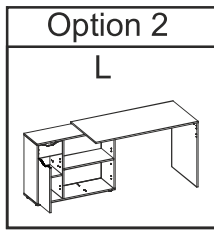

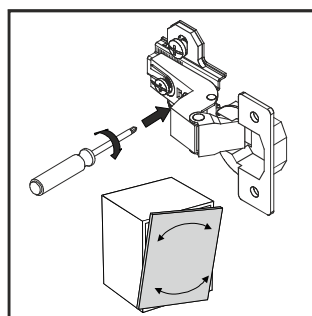
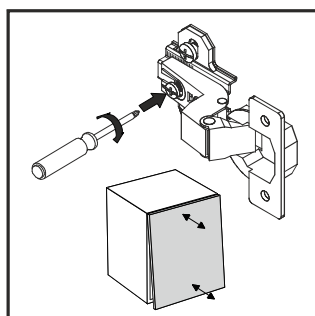
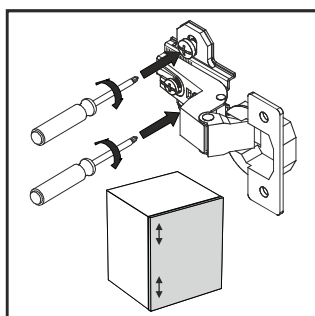
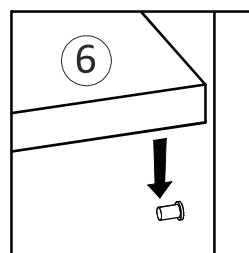
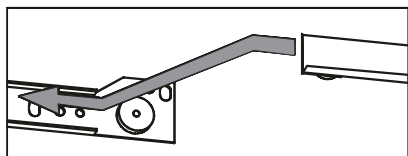
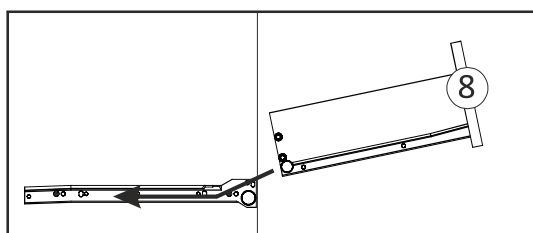
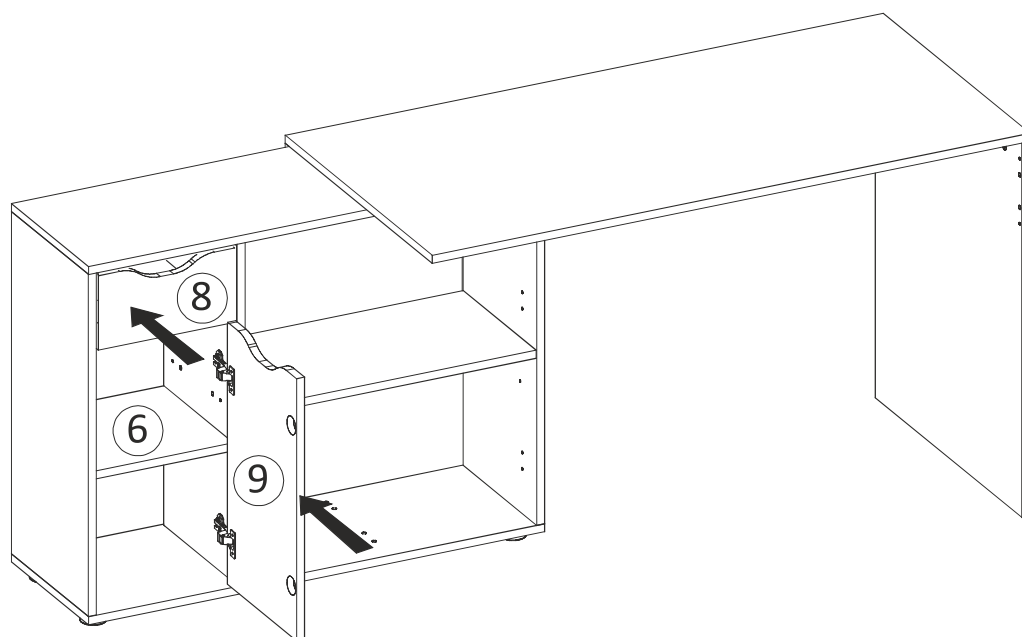
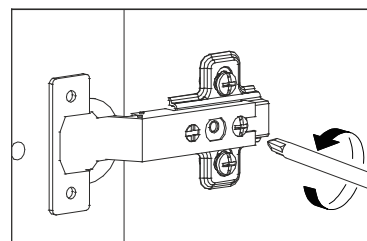
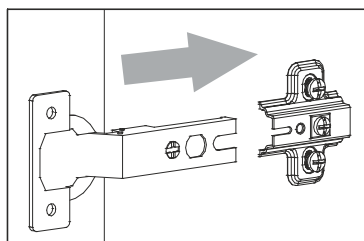
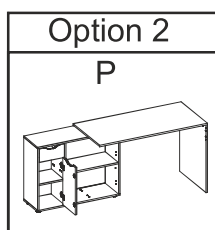



4 x F1

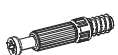

2 x T2

Ø8x35



8 x K2

Ø15x12



4 x M1

Ø5



12 x P3

Ø8



4 x P4

Ø6,3x13



4 x W5

250mm



1 x R5

28-45



Option 3

L

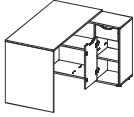

P

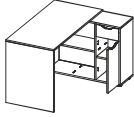

Option 4

L

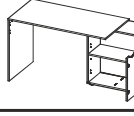

P

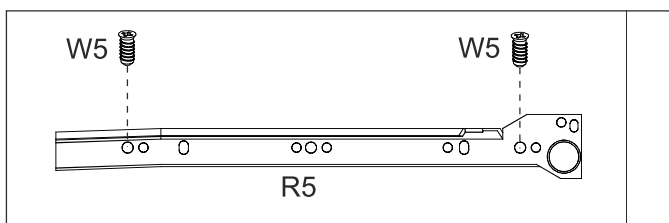
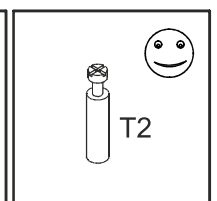
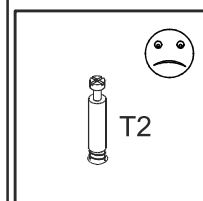
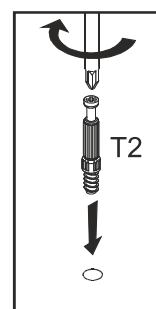
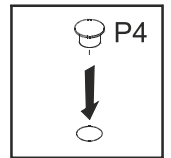
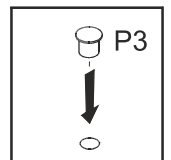
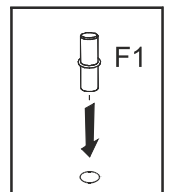
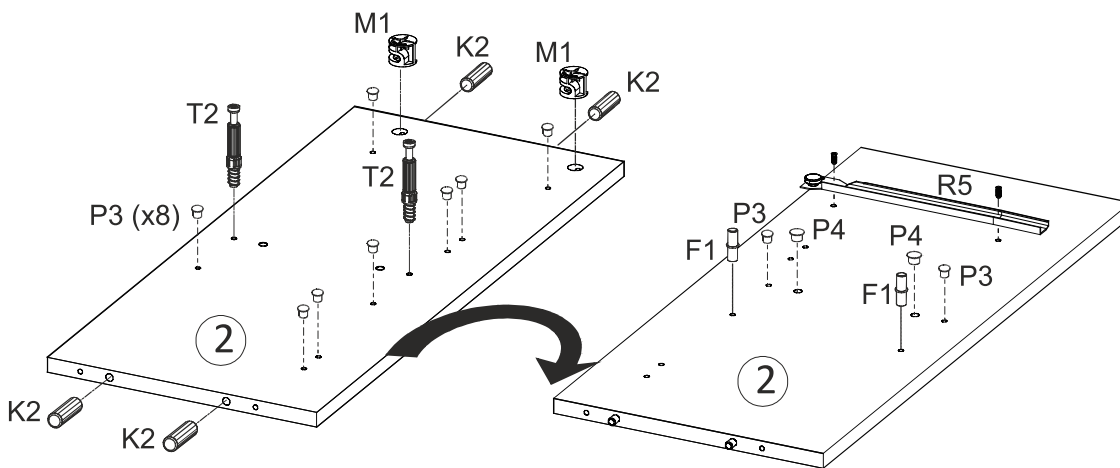
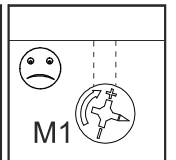
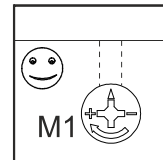
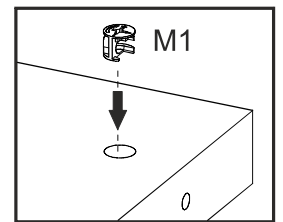
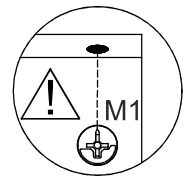
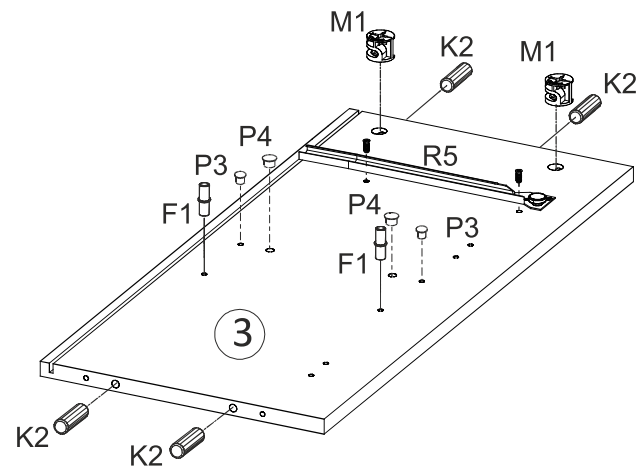
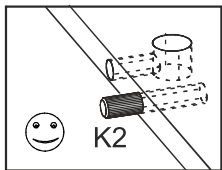
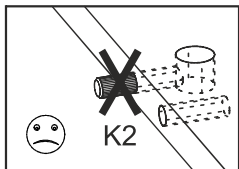
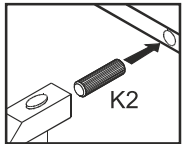
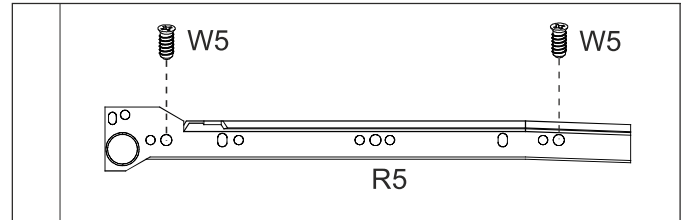
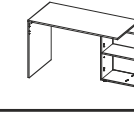

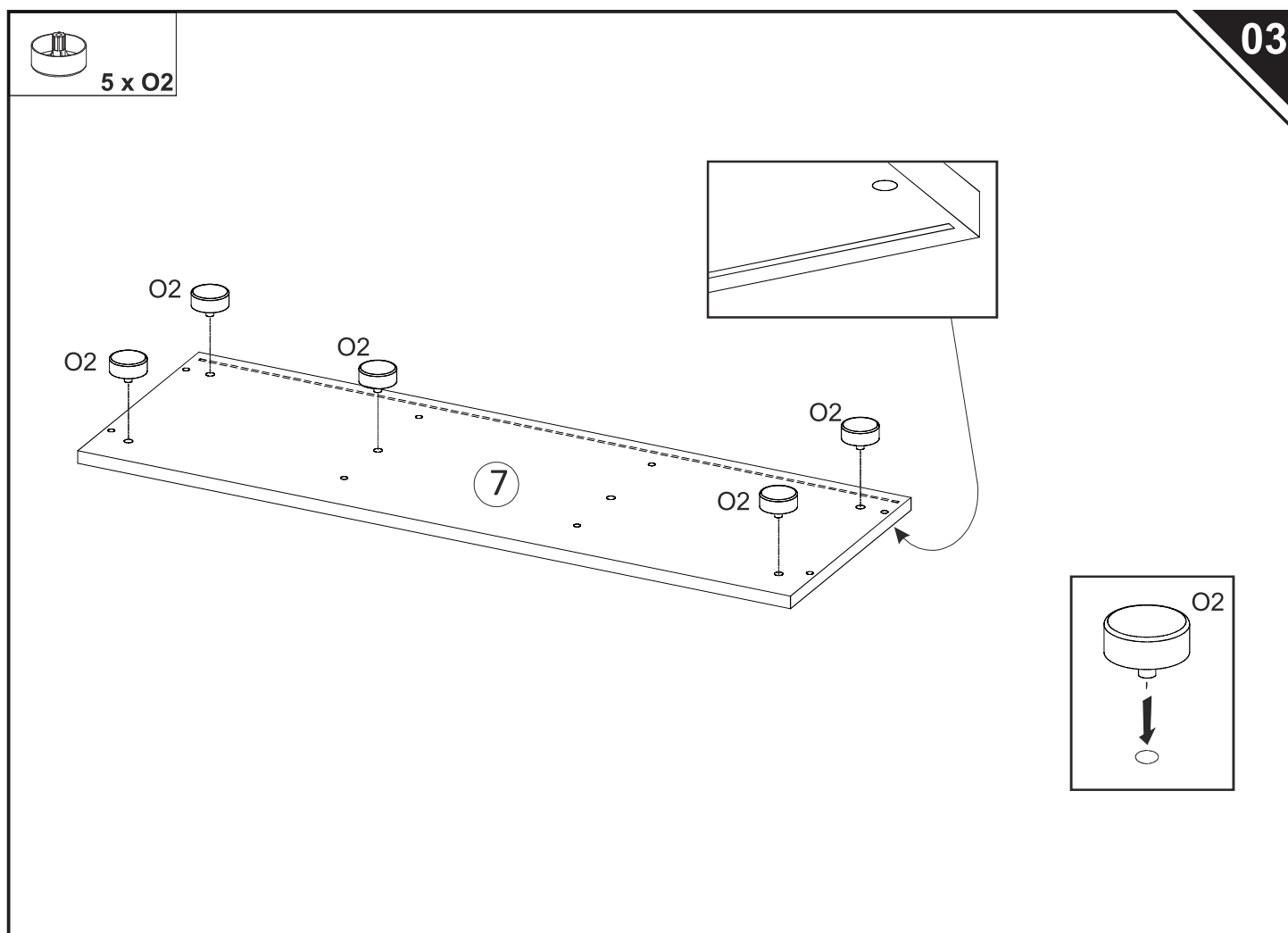
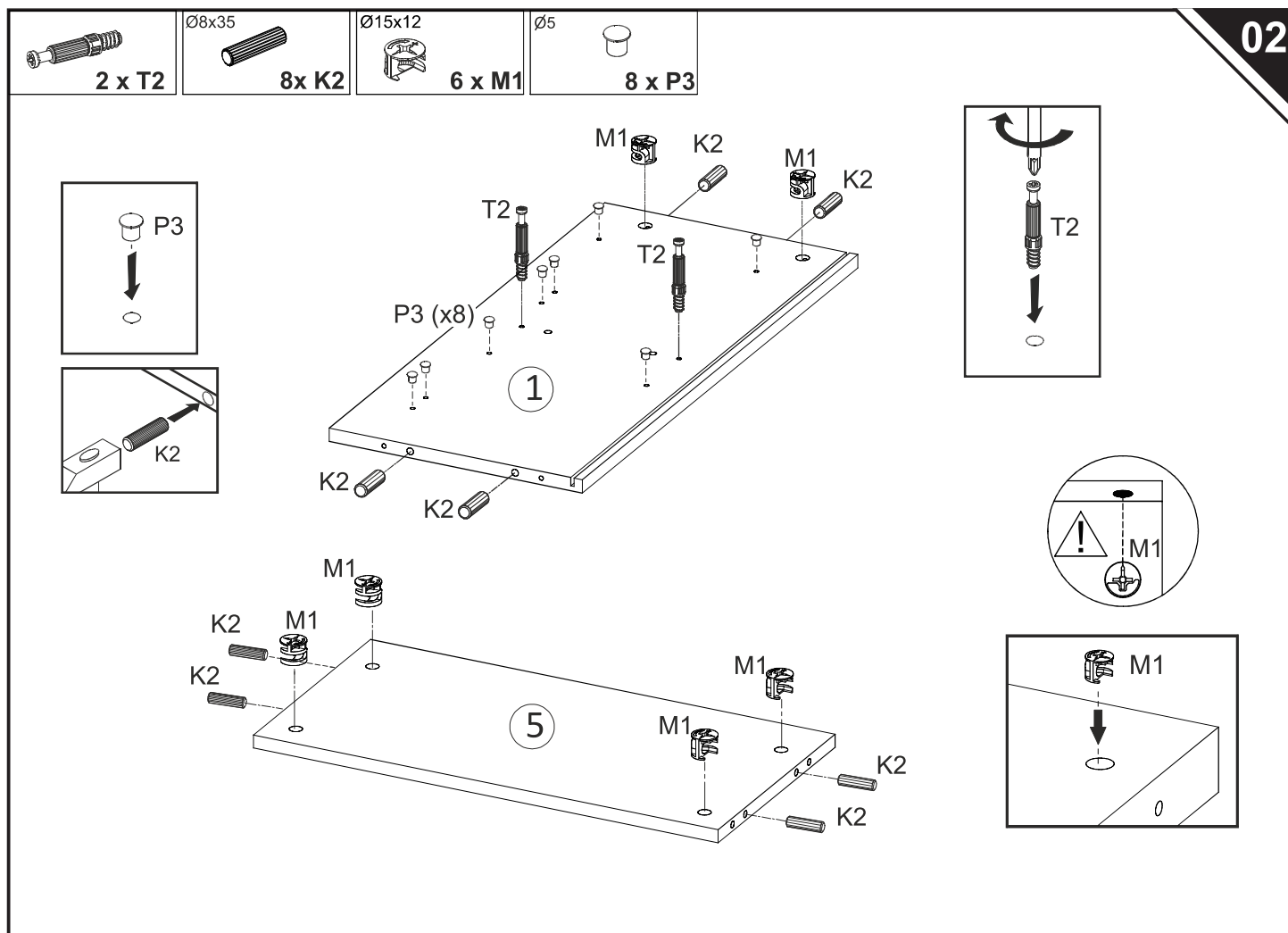

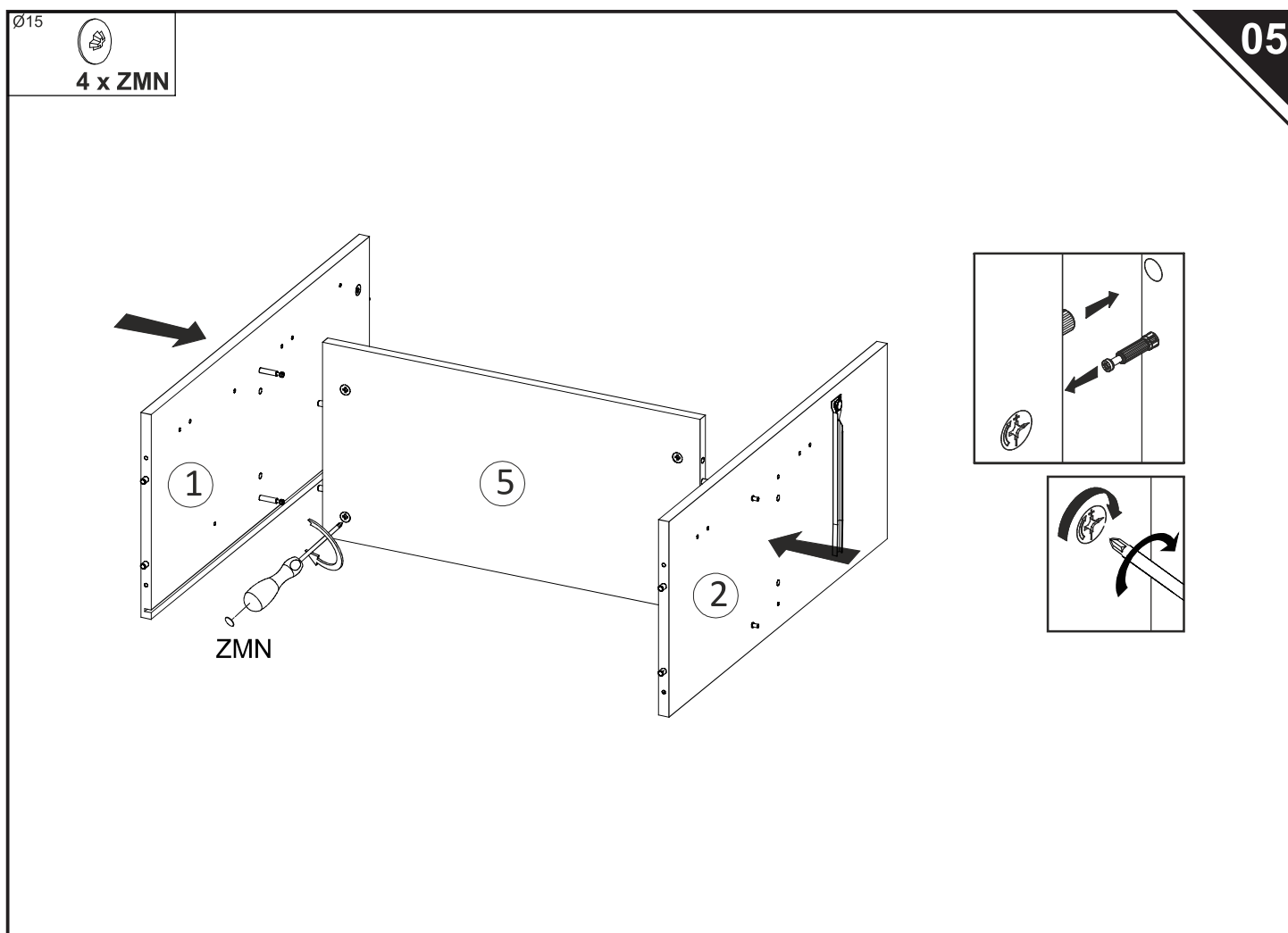
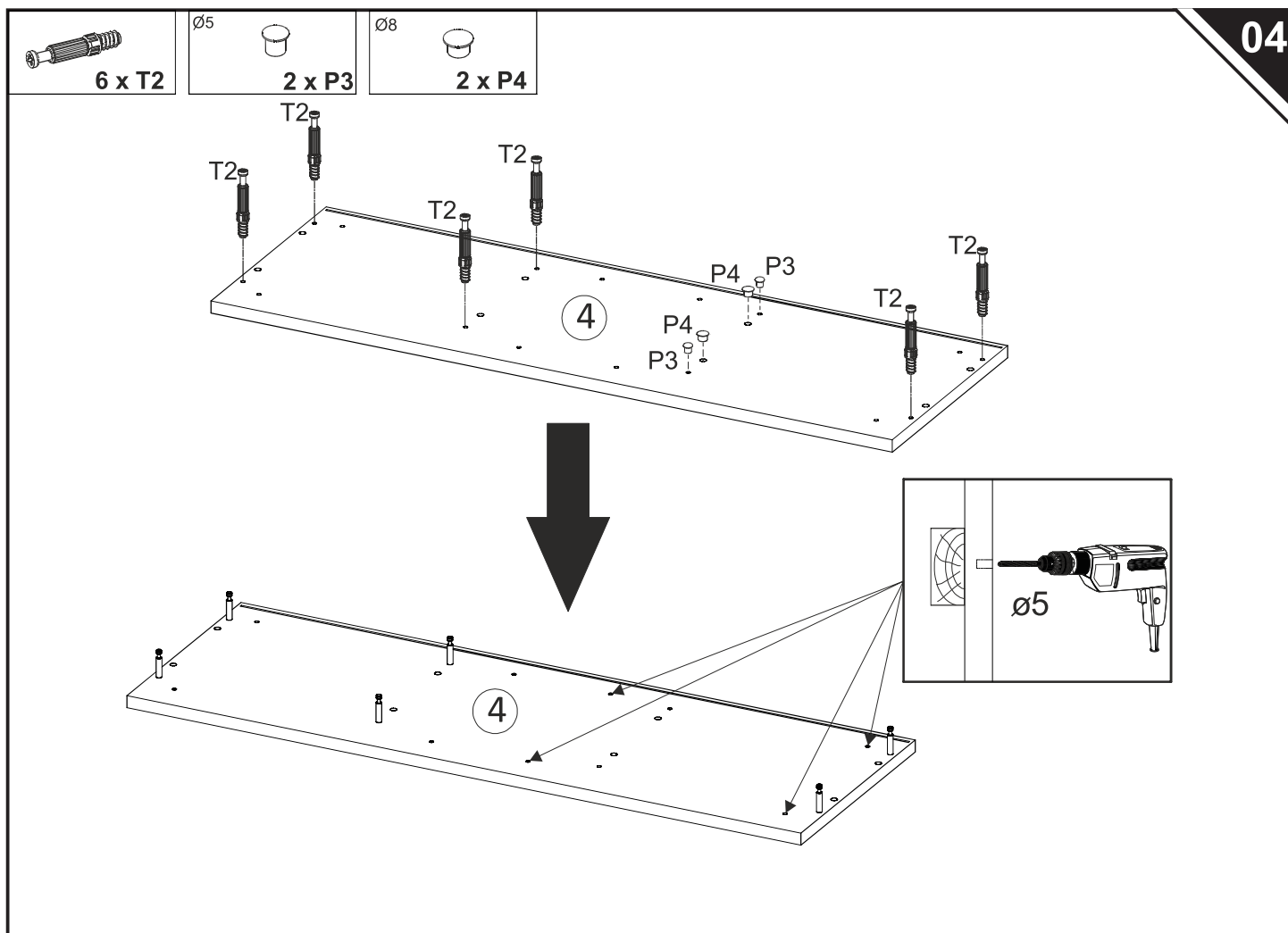

Ø7x50



6 x A1

hex 4



1 x I

06

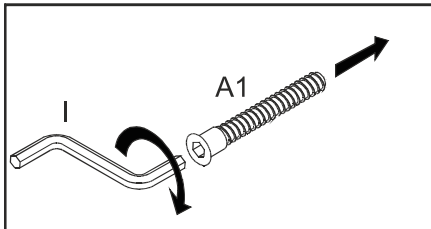
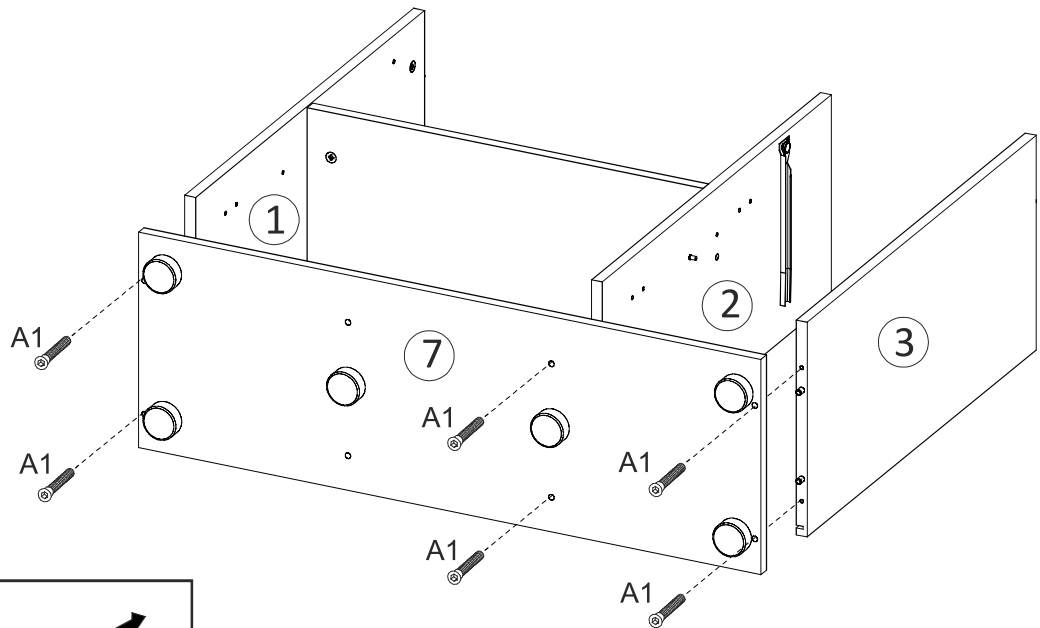

07

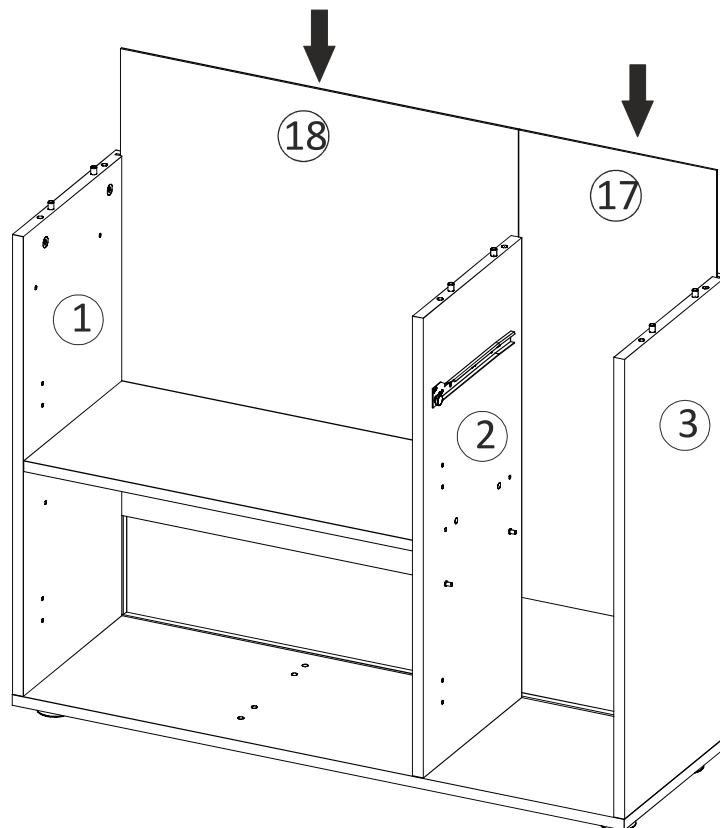

Ø15



6 x ZMN

08

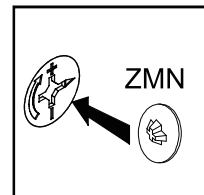
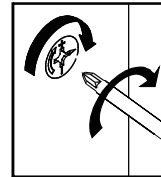
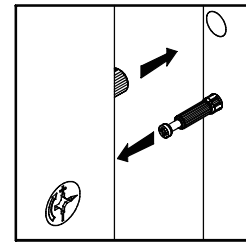
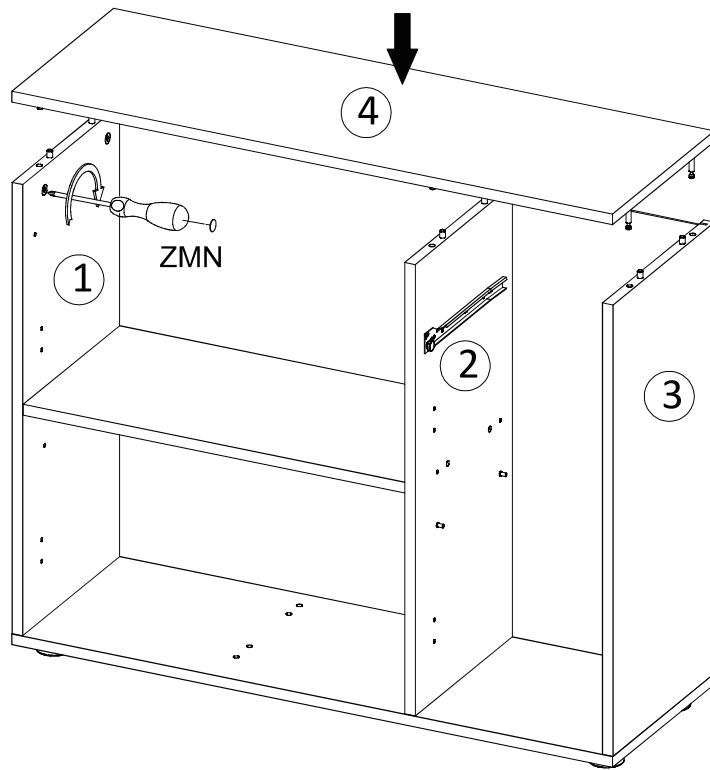

09



5 x G3

Ø3x20



5 x W10



8 x G2

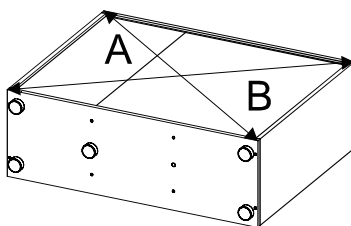
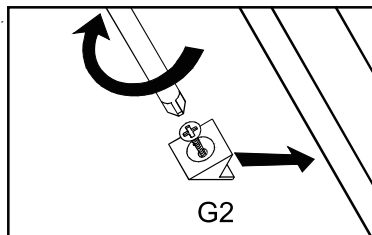
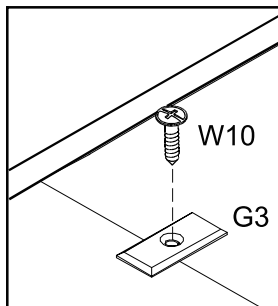

A=B

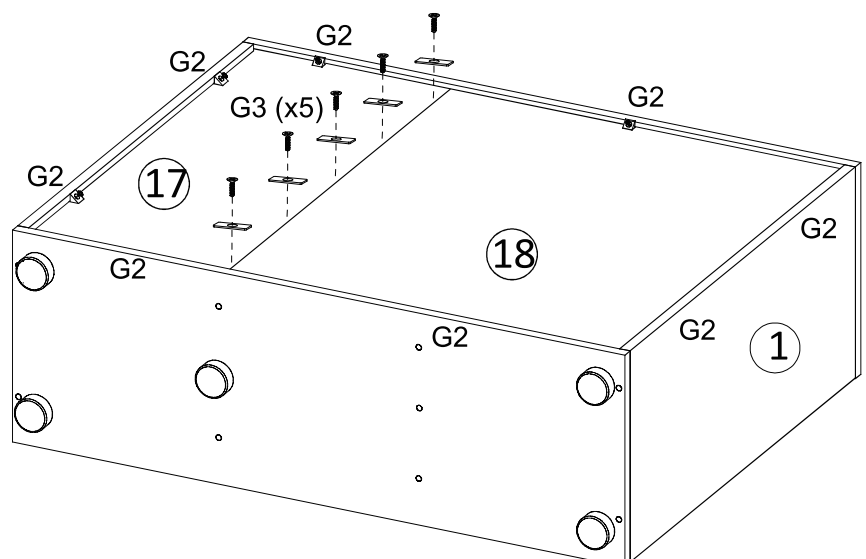



2 x Z3

Ø5



4 x P3



Option 3

L

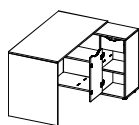

Option 4

L

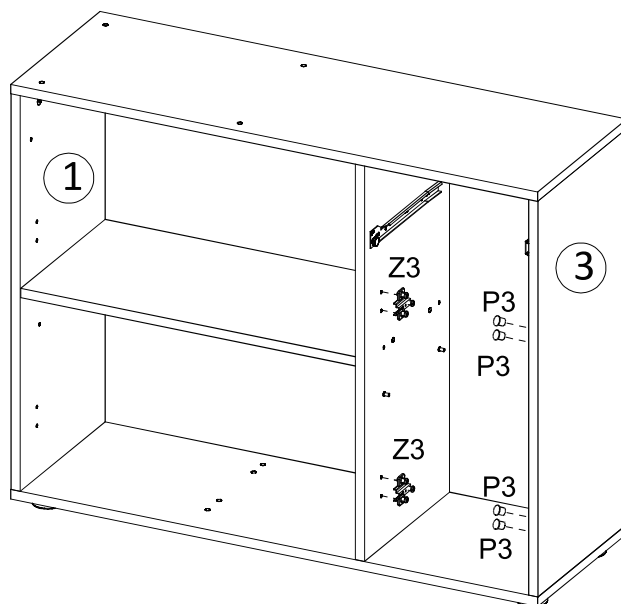
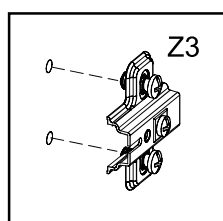
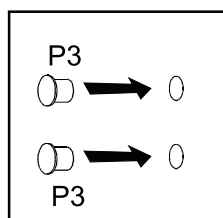
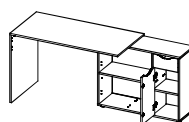

2 x Z3

Ø5



4 x P3



Option 3

P

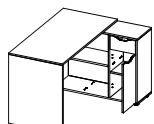

Option 4

P

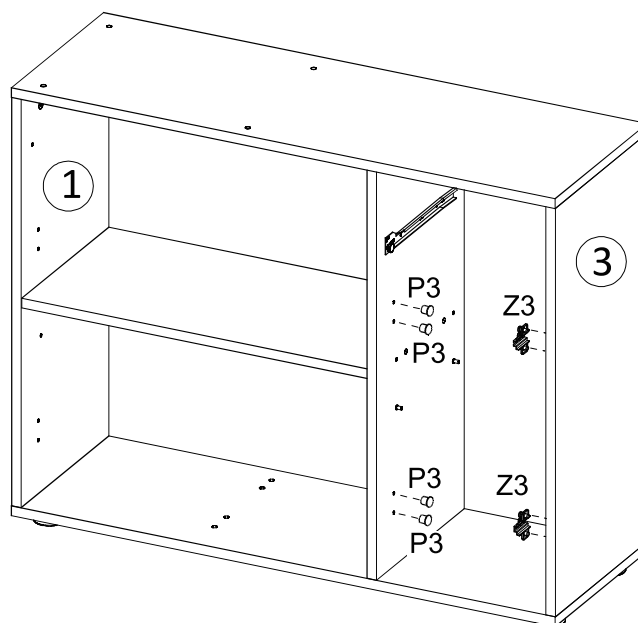
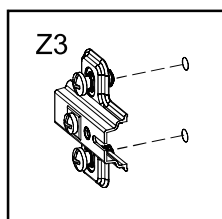
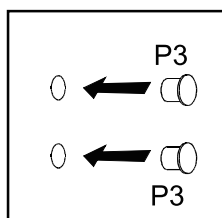
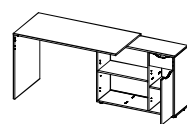

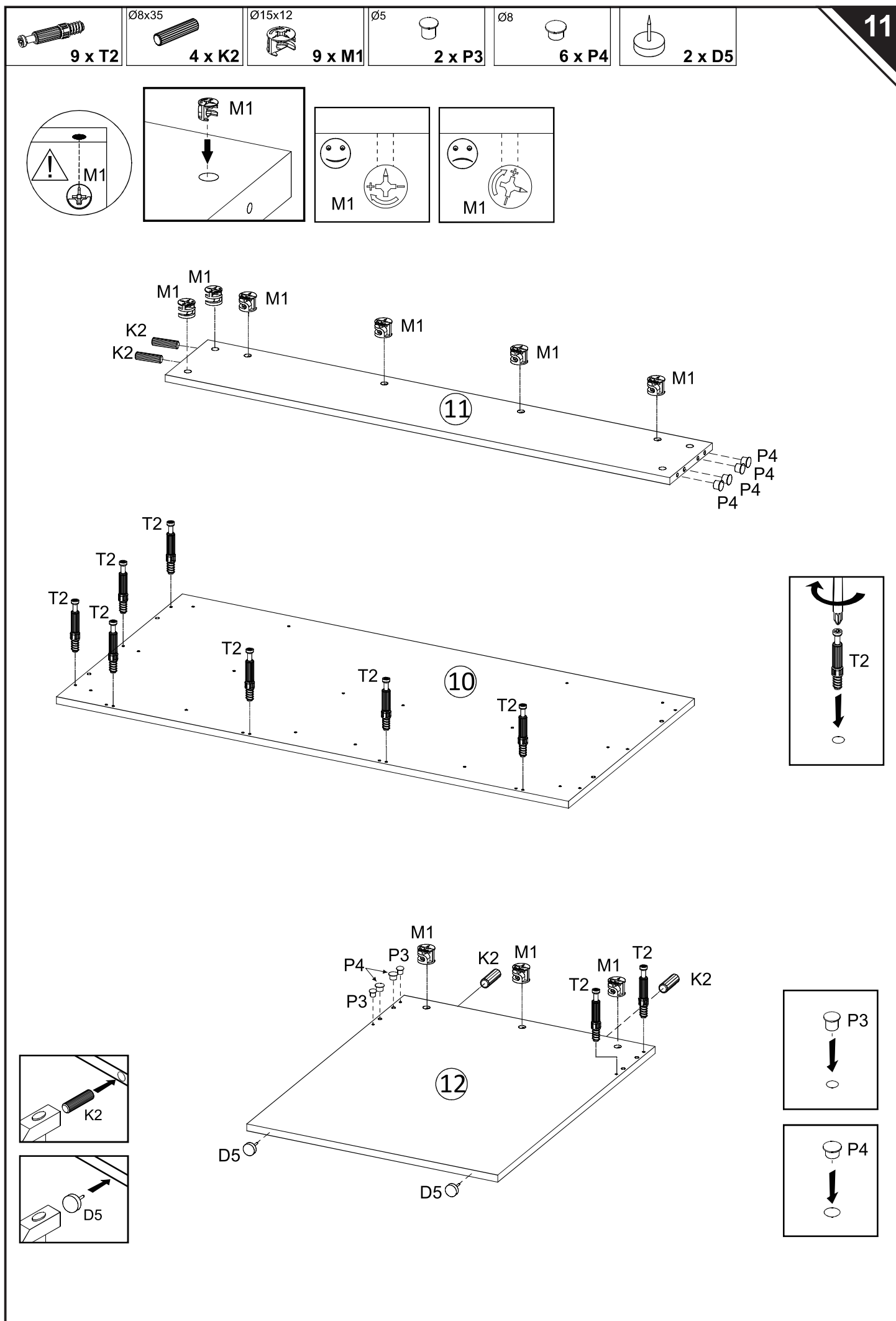

Ø15



2 x ZMN

12

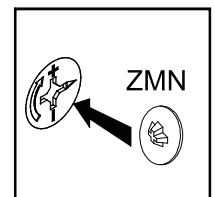
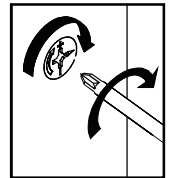
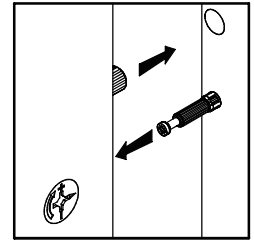
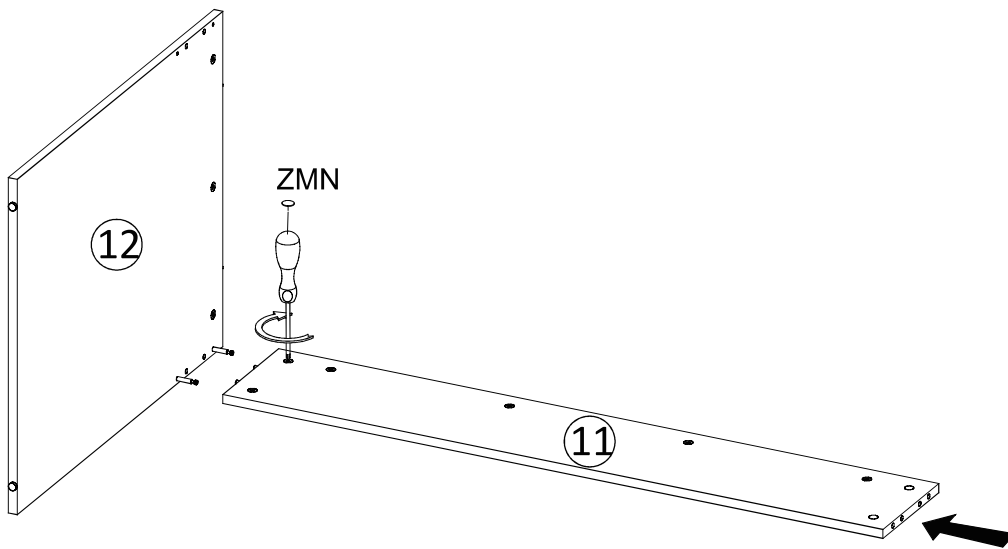

Ø15



7 x ZMN

13

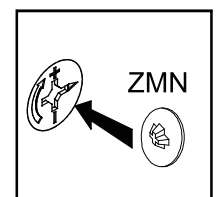
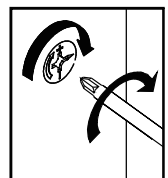
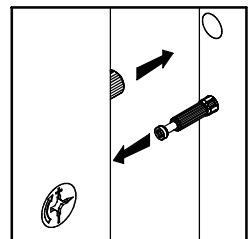
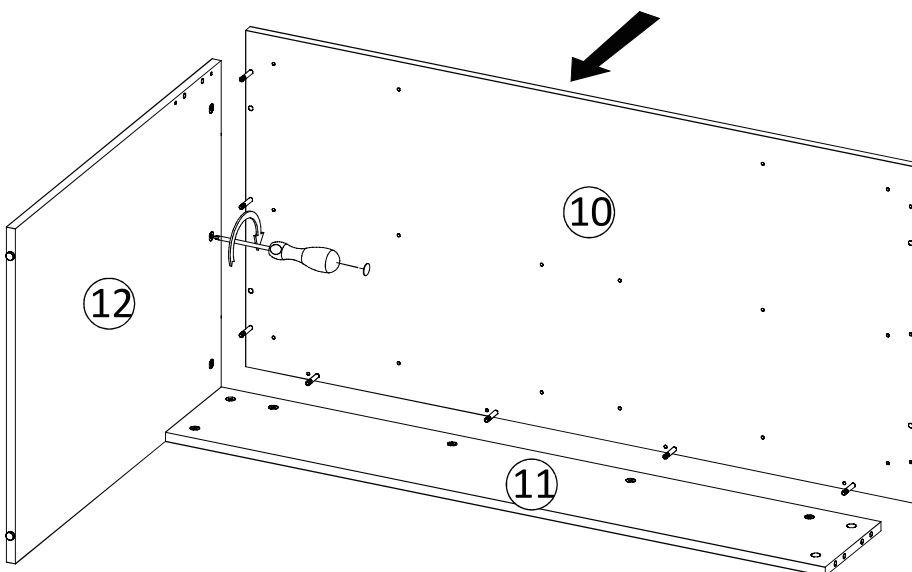



4 x O6

Ø6,3x45



4 x W6

Ø8



4 x P4



Option 3

L

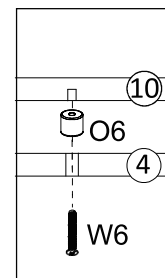
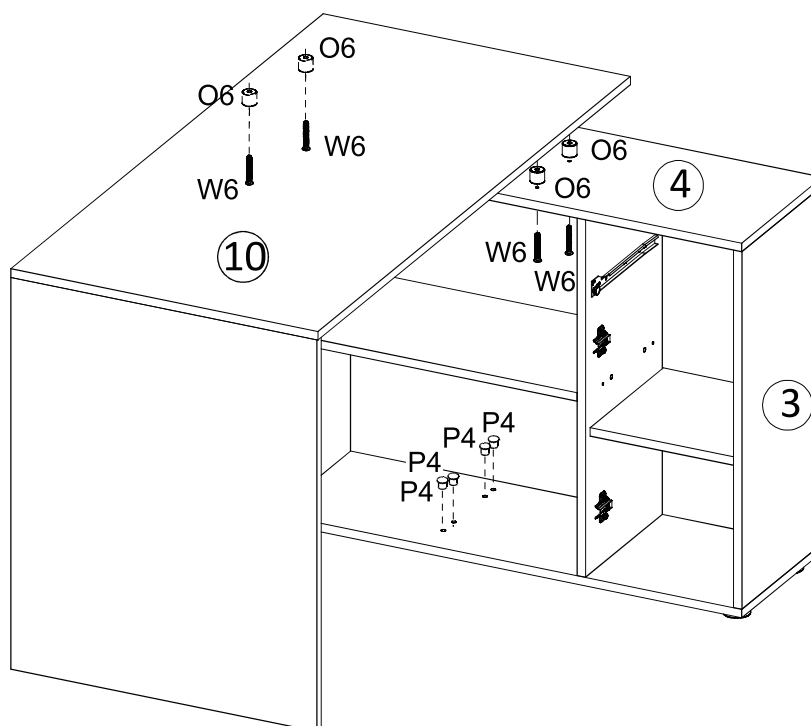
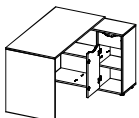

4 x O6

Ø6,3x45



4 x W6

Ø8



4 x P4



Option 3

P

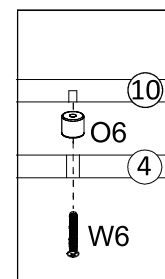
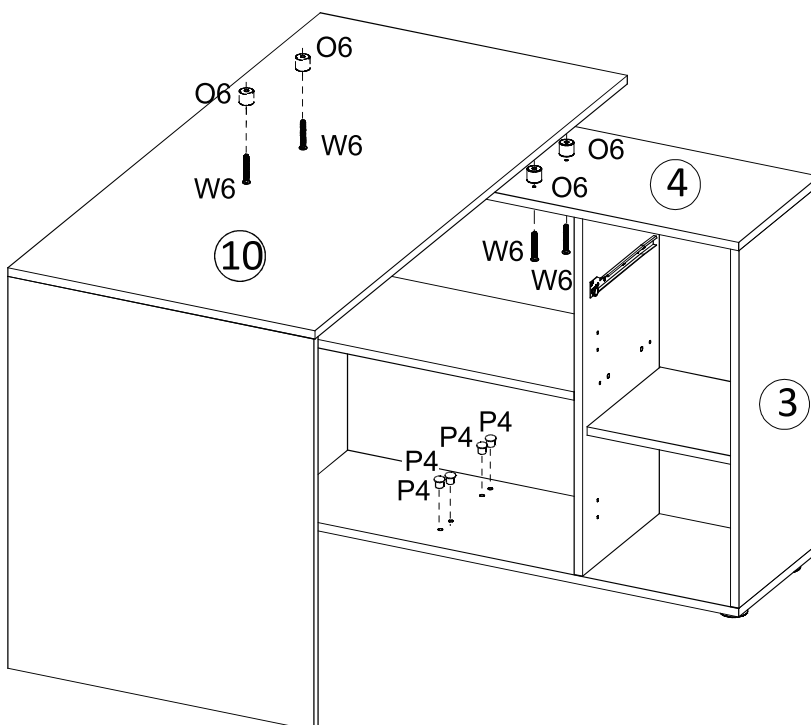
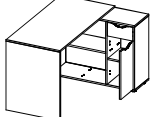



4 x O6

Ø6,3x45



4 x W6

Ø8



4 x P4



Option 4

L

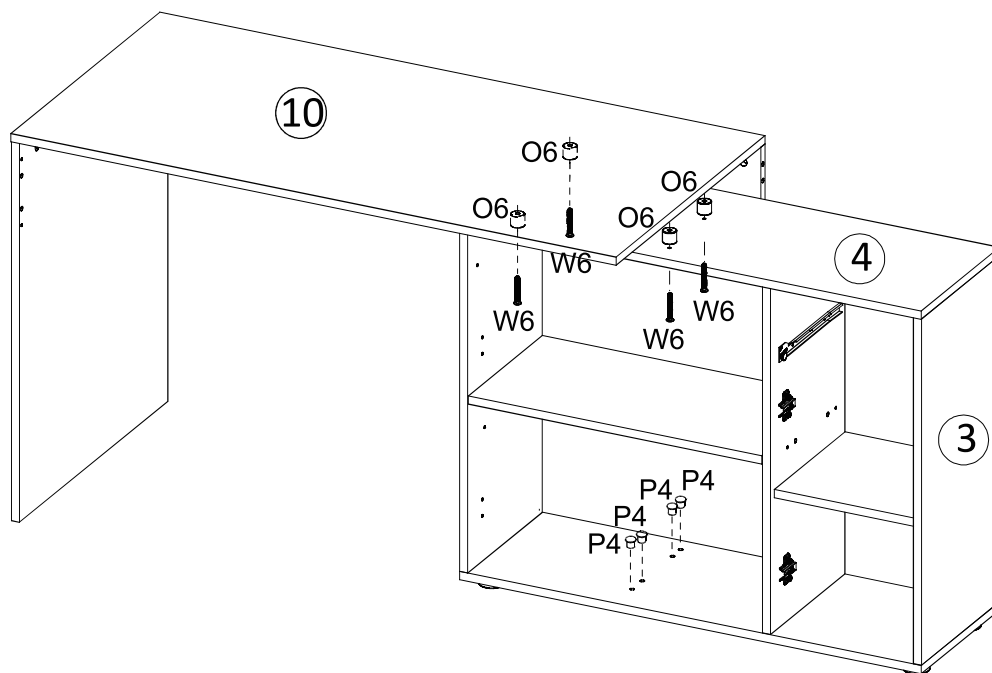
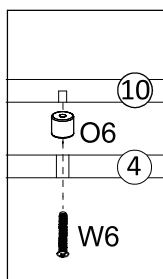
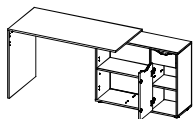

4 x O6

Ø6,3x45



4 x W6

Ø8



4 x P4



Option 4

P

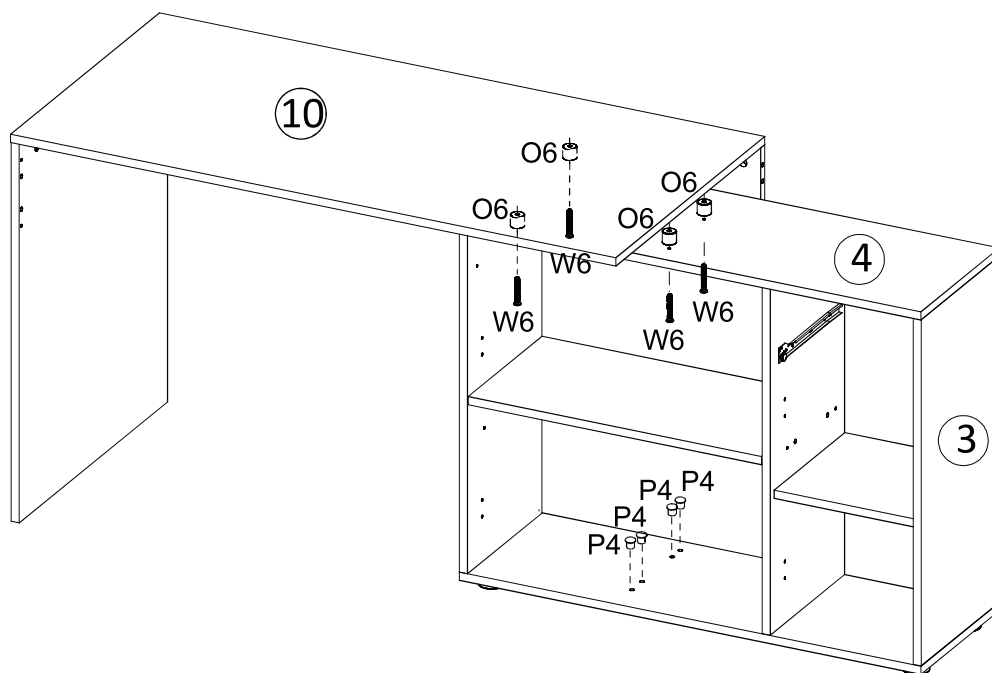
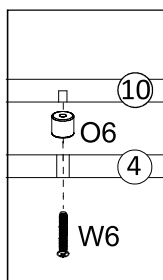
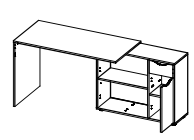

Ø15x10



2 x M2

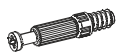

2 x T2

16

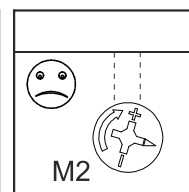
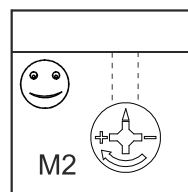
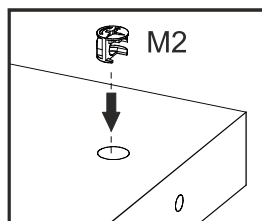
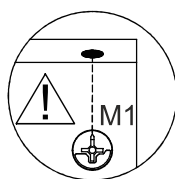
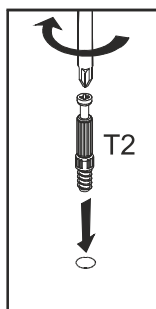
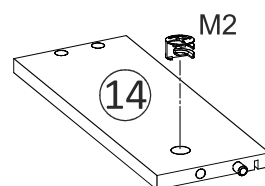
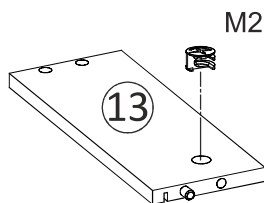
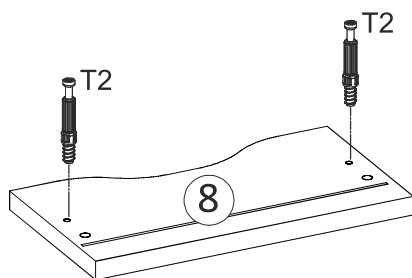

17



4 x T5

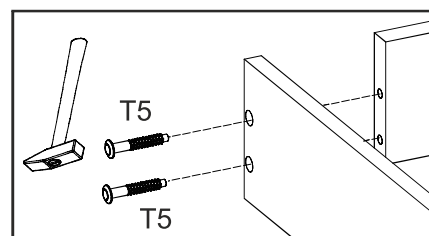
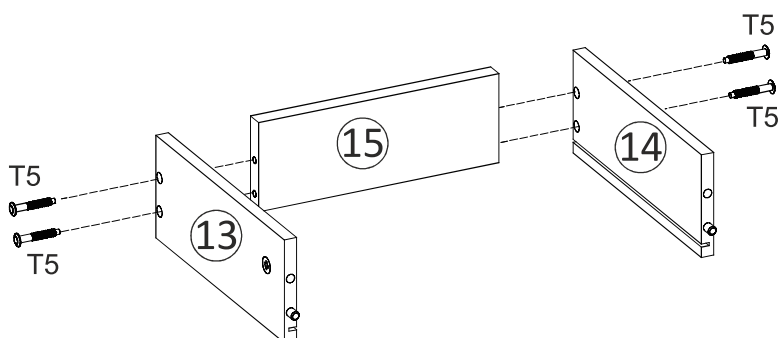

Ø20

2 x ZMN1

18

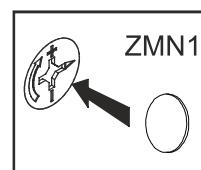
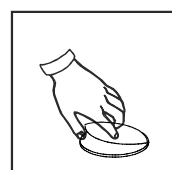
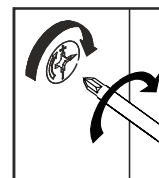
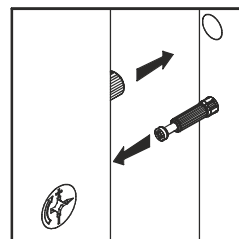
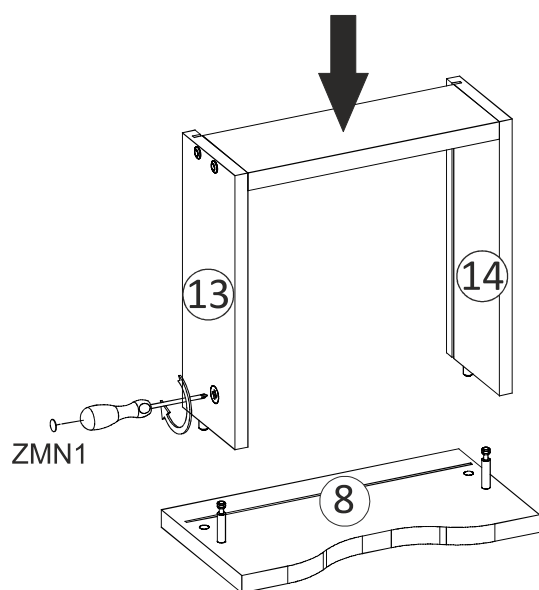

19

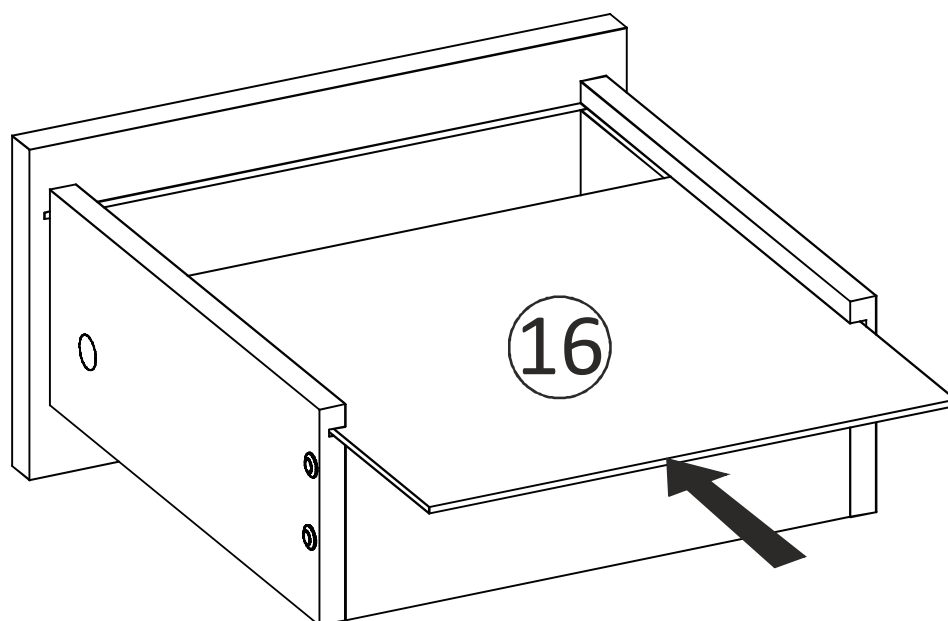

Ø3x20



3 x W10

20

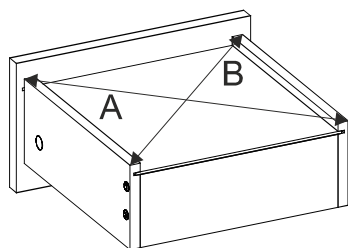

$A=B$

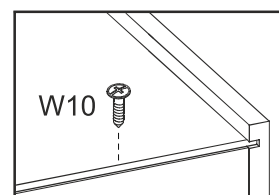
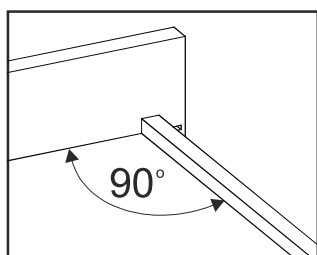
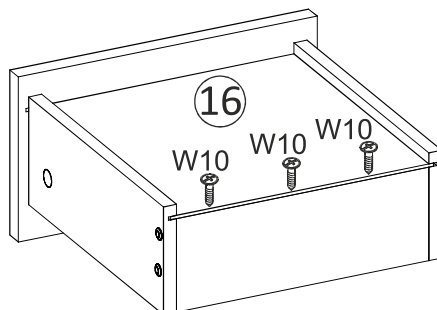

Ø3x20



4 x W10

250mm



1 x R5

21

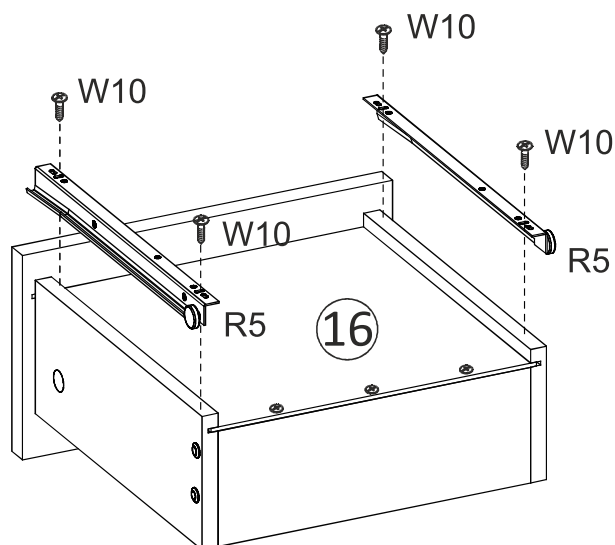
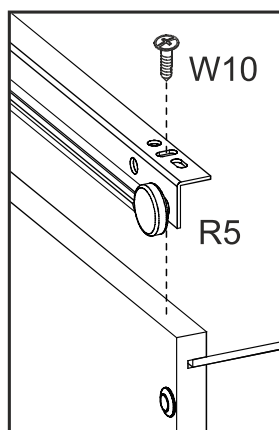



2 x Z4

Ø3,5x16



4 x W1

Ø35



2 x P5

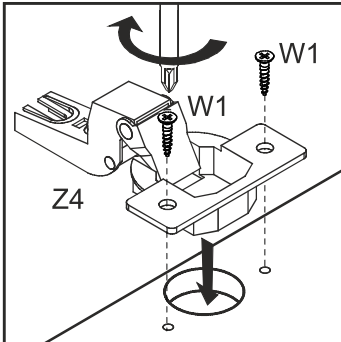
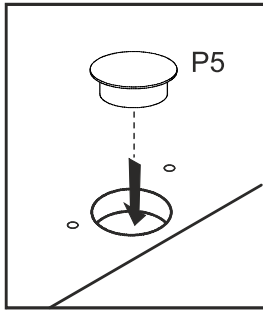

Option 3

L

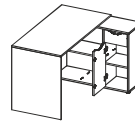

Option 4

L

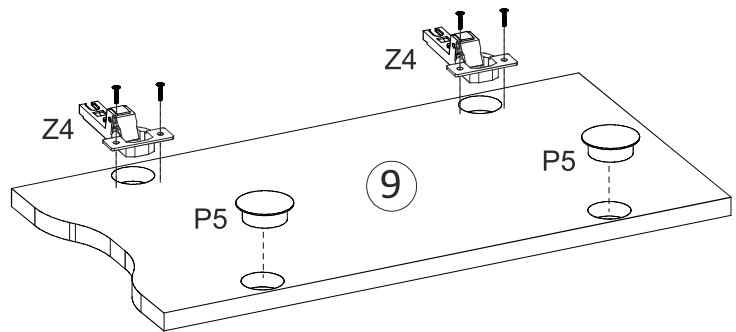
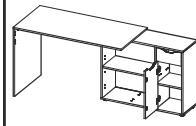

2 x Z4

Ø3,5x16



4 x W1

Ø35



2 x P5

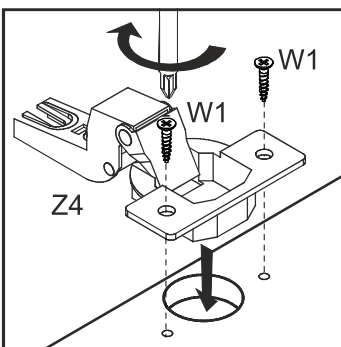
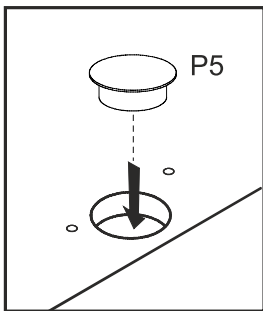

Option 3

P

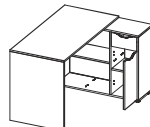

Option 4

P

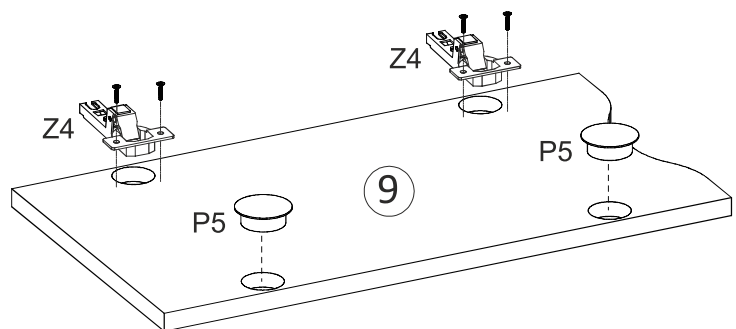
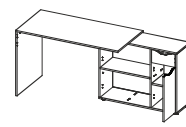

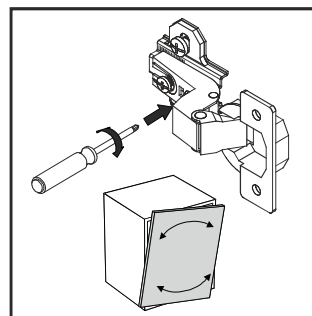
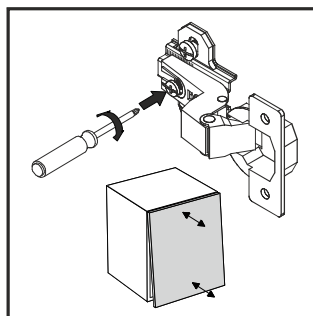
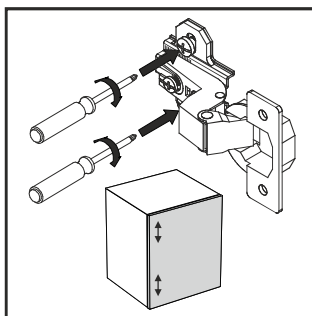
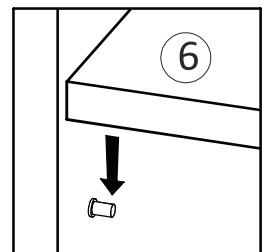
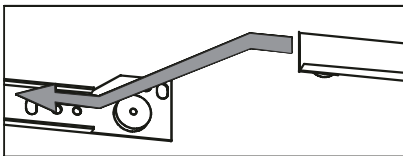
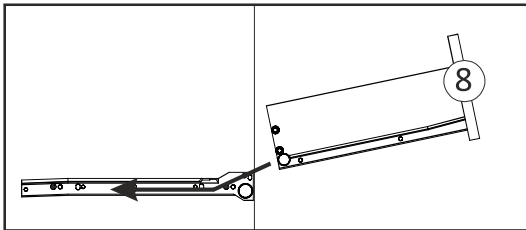
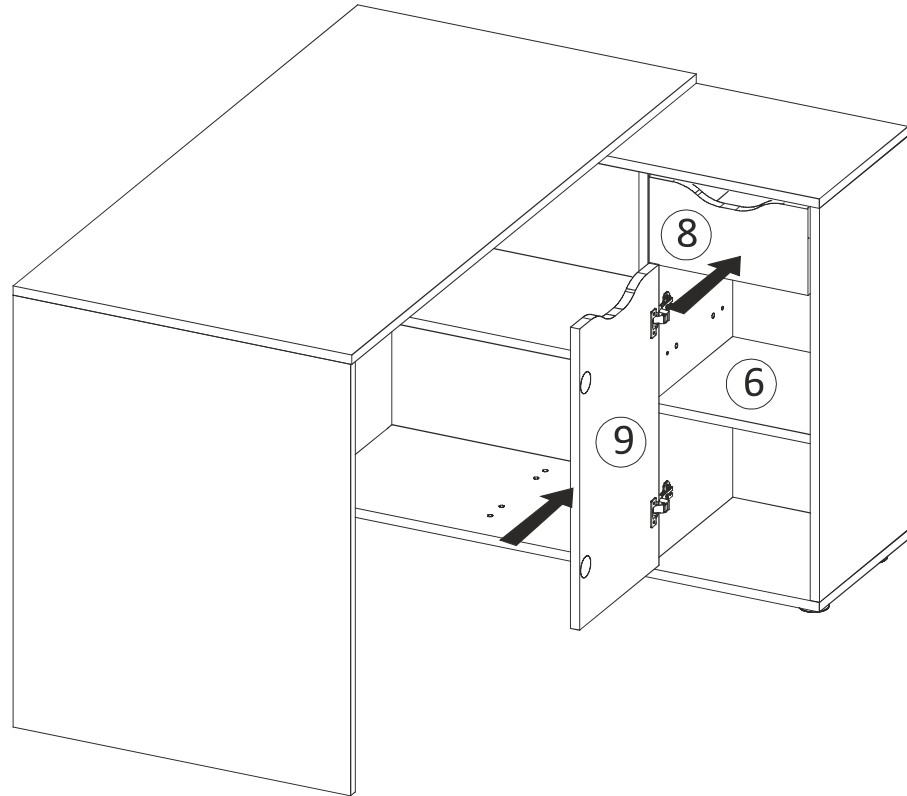
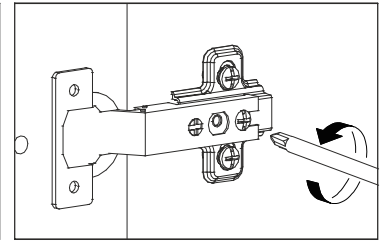
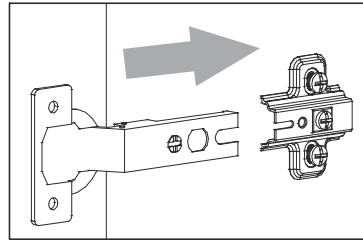
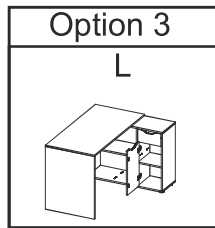

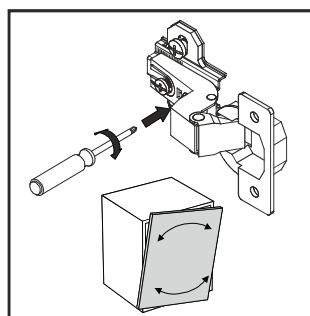
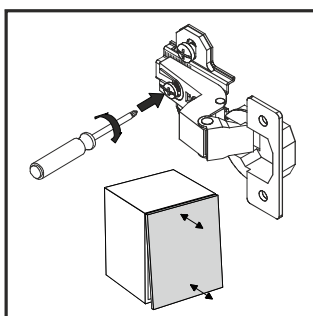
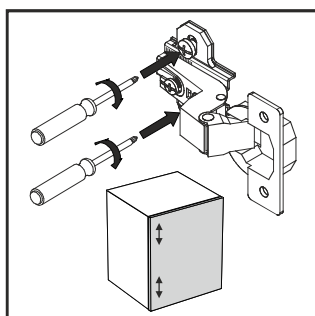
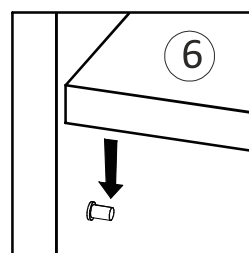
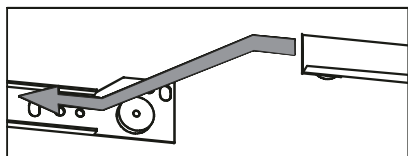
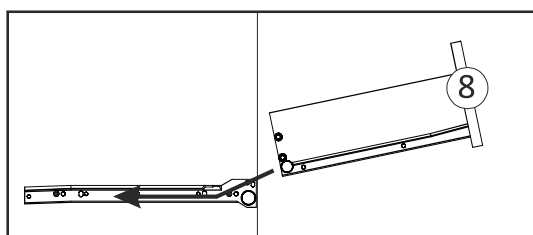
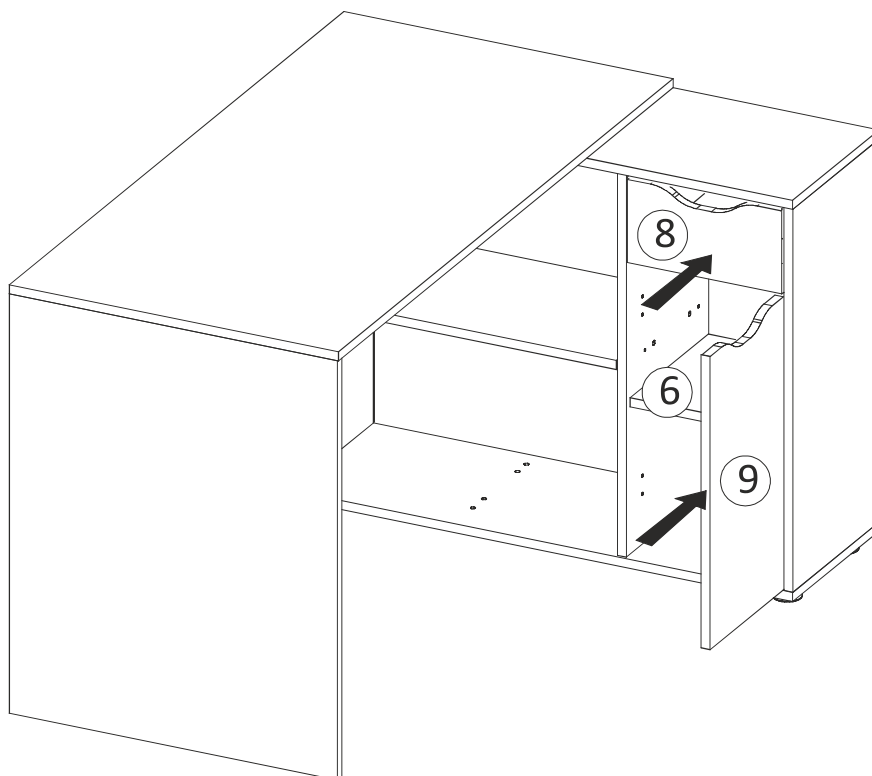
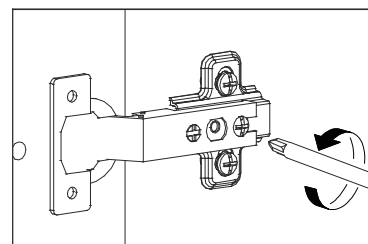
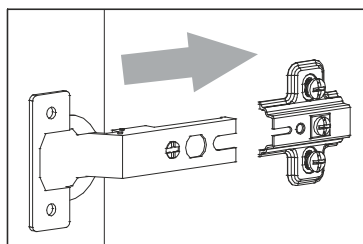
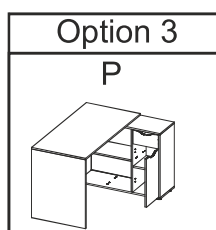

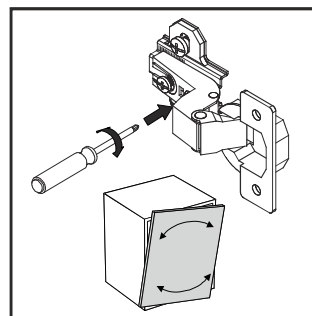
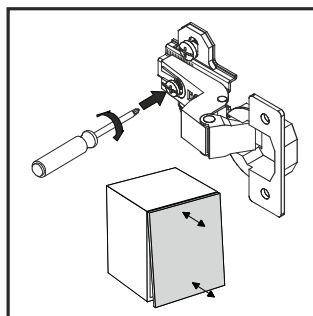
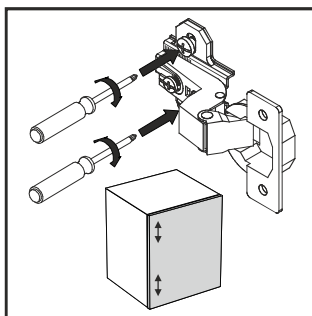
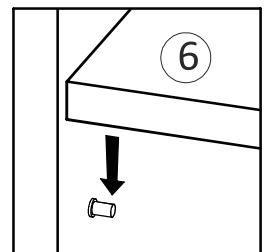
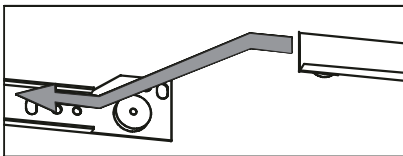
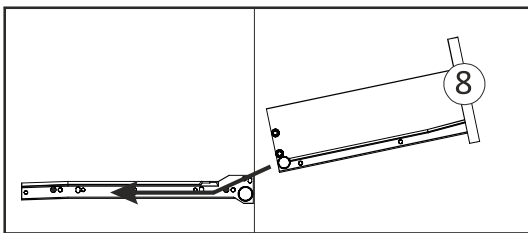
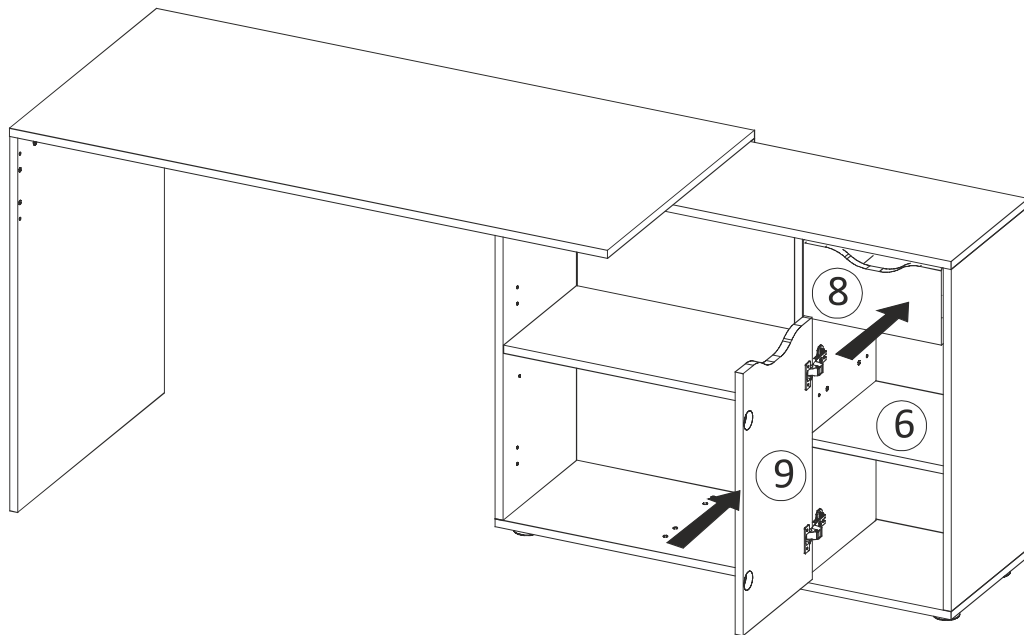
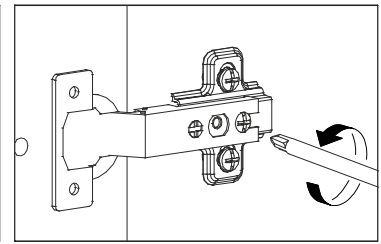
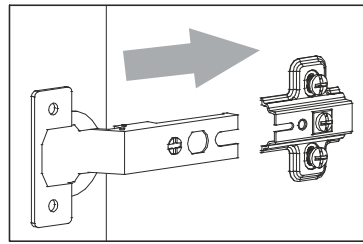
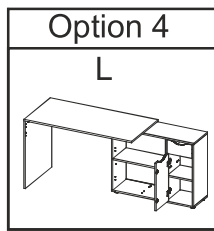

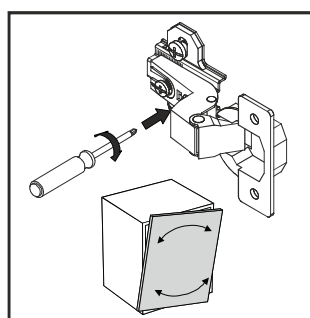
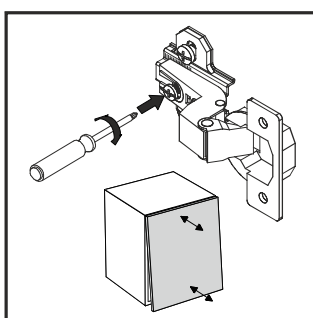
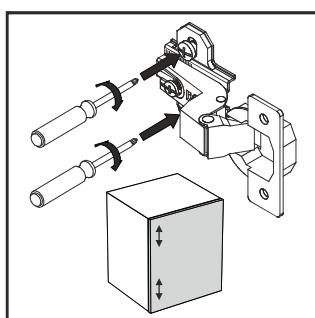
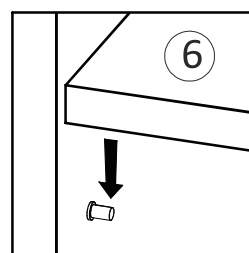
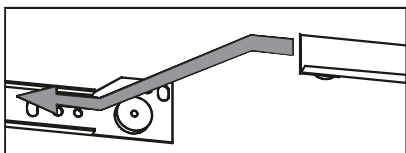
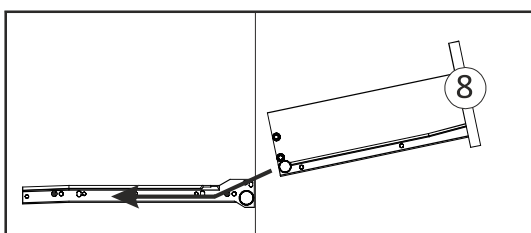
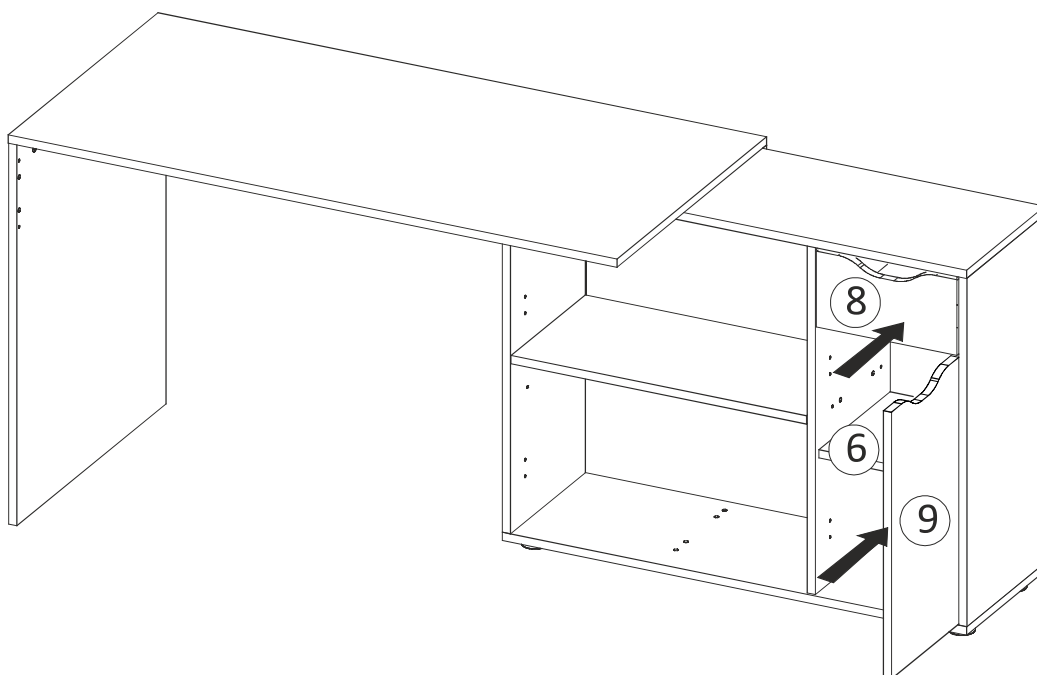
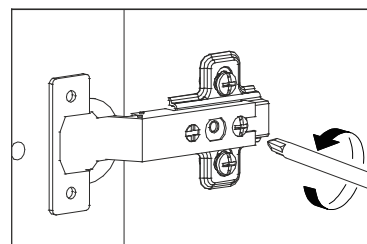
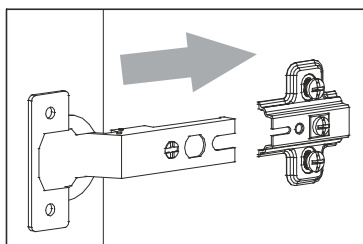
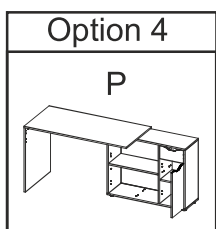

If you have any questions, please contact our customer care center, Our contact details are below:

US

 001-877-644-9366

 customerservice@aosom.com

Imported by Aosom LLC

27150 SW Kinsman Rd Wilsonville, OR 97070 USA

Made in Poland

If you have any questions, please contact our customer care center, Our contact details are below:

CA

 416-792-6088

 customerservice@aosom.ca

Imported by Aosom Canada Inc.

7270 Woodbine Avenue, Unit 307, Markham,
Ontario Canada L3R 4B9

Made in Poland

Si vous avez la moindre question, veuillez contacter notre centre d'assistance à la clientèle, Nos coordonnées sont les suivantes:

 416-792-6088

 customerservice@aosom.ca

Importé par Aosom Canada Inc.

7270 Woodbine Avenue, unité 307,
Markham, Ontario Canada L3R 4B9

Fabriqu  en Pologne

If you have any questions, please contact our customer care center, Our contact details are below:

UK

 0044-800-240-4004

 enquiries@mhstar.co.uk

IMPORTER ADDRESS:

MH STAR UK LTD

Unit 27, Perivale Park,

Horsenden lane South

Perivale, UB6 7RH

Made in Poland

Si vous avez la moindre question, veuillez contacter notre centre d'assistance à la clientèle, Nos coordonnées sont les suivantes:

FR

 0033-1-84166106

 aosom@mhfrance.fr

Import  par/Fabricant/REP:

MH FRANCE

2 Rue Maurice Hartmann

92130 Issy Les Moulineaux

France

Fabriqu  en Pologne

Wenn Sie Fragen haben, wenden Sie sich bitte an unser Kundendienstzentrum, Unsere Kontaktdaten stehen unten:

DE

 +49 40 87408465

 service@aosom.de

ADRESSE DES IMPORTEURE/Hersteller/REP:

MH Handel GmbH

Wendenstra e 309

D-20537 Hamburg

Germany

Hergestellt in Polen

In caso di dubbio, si prega di contattare il nostro centro assistenza clienti, I nostri dettagli di contatto sono di seguito:

IT

 0039-0249471447

 clienti@aosom.it

IMPORTATO DA/Produttore/REP:

AOSOM Italy srl

Centro Direzionale Milanofiori

Strada 1 Palazzo F1

20057 Assago (MI)

P.I.: 08567220960

Fatto in Polonia

Si tiene alguna pregunta, comun quese con nuestro Centro de Atenci n al Cliente, Nuestros datos de contacto son los siguientes:

ES

 0034-931294512

 atencioncliente@aosom.es

IMPORTADOR/Fabricante/REP:

SPANISH AOSOM, S.L.

C/ROC GROS, N 15.08550, ELS HOSTALET DE BALENY , SPAIN.

B66295775

Hecho en Polonia

Se tiver alguma d vida, por favor contacte o nosso Centro de Atendimento ao Cliente, Os nossos dados de contacto s o os seguintes:

 0034-931294512

 info@aosom.pt.

IMPORTADOR/Fabricante/REP:

SPANISH AOSOM, S.L

C.ROC GROS N.15, 08550. ELS HOSTALET DE BALENY 

Feito na Pol nia



FR

**DONNEZ
OU
RECYCLEZ**



OU



OU



ASSOCIATION

LIVRAISON

D CH TERIE

Adresses sur quefairedemesdechets.fr