

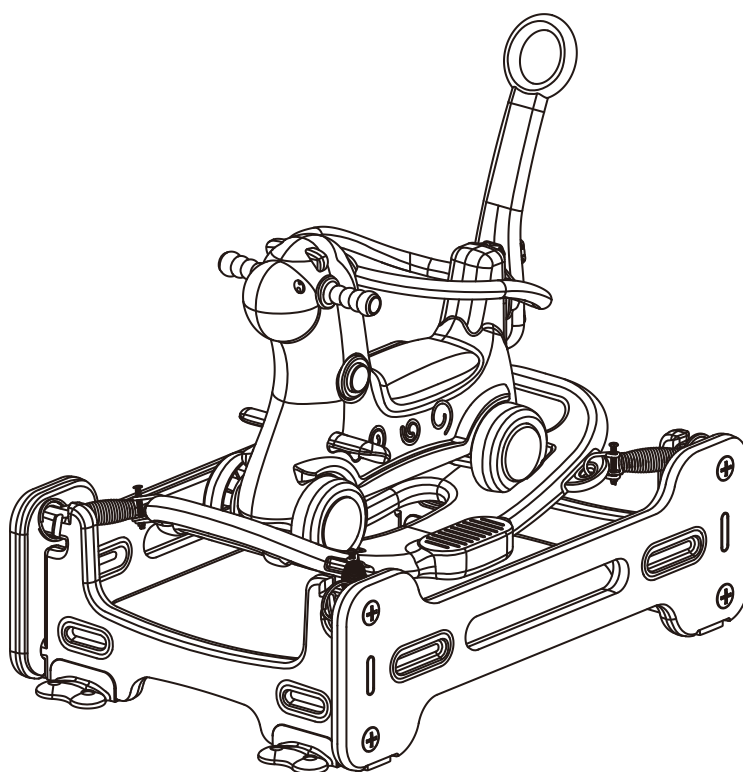

IN250300008V01_US_CA

330-185V00



EN_WARNING: Suitable for children of 1+ years old; Max weight: 30 kg.

FR_ATTENTION: Convient aux enfants de 1+ ans; Poids maximum: 30 kg.

15
STEPS



60 MIN



EN_IMPORTANT, RETAIN FOR FUTURE REFERENCE: READ CAREFULLY.

FR_IMPORTANT : A LIRE ATTENTIVEMENT ET A CONSERVER POUR VOUS Y REFERER ULTERIEUREMENT.

WARNING:

1. CHOKING HAZARD—Small parts. Not for children under 3 years.
2. Only allowed for adults to install, keep children away.
3. Warning. Risk of falling. Do not leave children under 36 months sitting or playing unattended.
4. Keep away from fire! Keep away from water!
5. Place it on a flat and clean floor, Check all the parts are well connected before use.
6. Adult supervision is recommended remove all plastic fasteners and hang tags before giving toy to child. These attachments are not part of the toy.

MAINTENANCE & CARE

- A. Keep all instructions and parts relating to this product for future reference.
- B. Please wipe down with a dry or damp cloth. Do not wash the product in water because it will be damaged and create a safety hazard.

ATTENTION:

1. RISQUE D'ÉTOUFFEMENT - Petites pièces. Déconseillé aux enfants de moins de 3 ans.
2. Installation par des adultes uniquement, tenir les enfants à l'écart.
3. Attention, Danger de chute. Ne pas laisser les enfants de moins de 36 mois s'asseoir ou jouer sur le jouet sans surveillance.
4. Loin du feu ! Loin de l'eau !
5. Posez-le sur un sol plat et propre. Vérifiez que toutes les pièces sont bien connectées avant toute utilisation.
6. Placez-le sur un sol plat et propre. Vérifiez que toutes les pièces sont bien connectées avant utilisation.

ENTRETIEN ET MAINTENANCE

- A. Conservez toutes les instructions et les pièces relatives à ce produit pour pouvoir vous y référer ultérieurement.
- B. Veuillez essuyer avec un chiffon sec ou humide. Ne lavez pas le produit dans l'eau car cela pourrait l'endommager et constituer un risque de sécurité.

PARTS

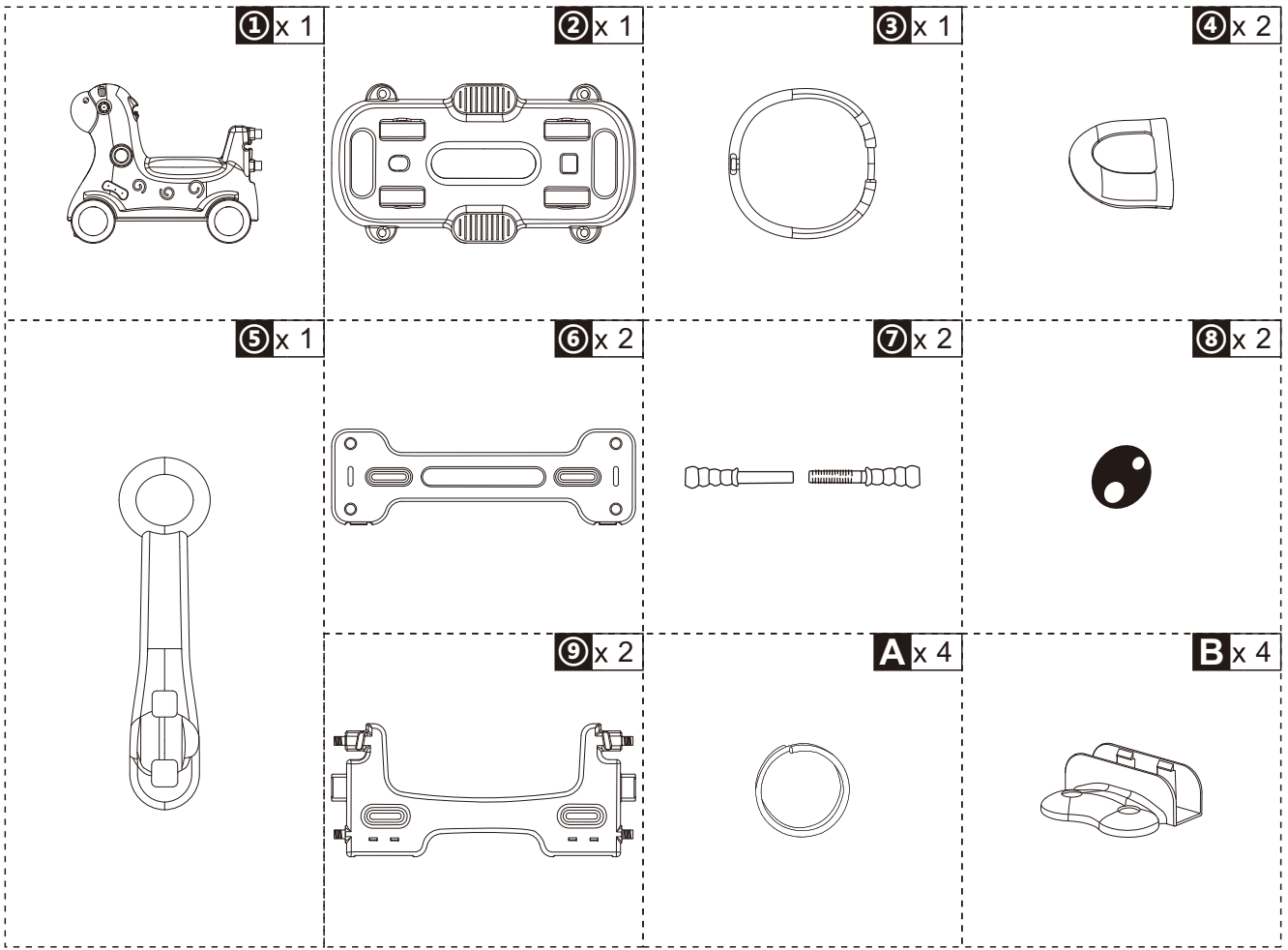

HARDWARE

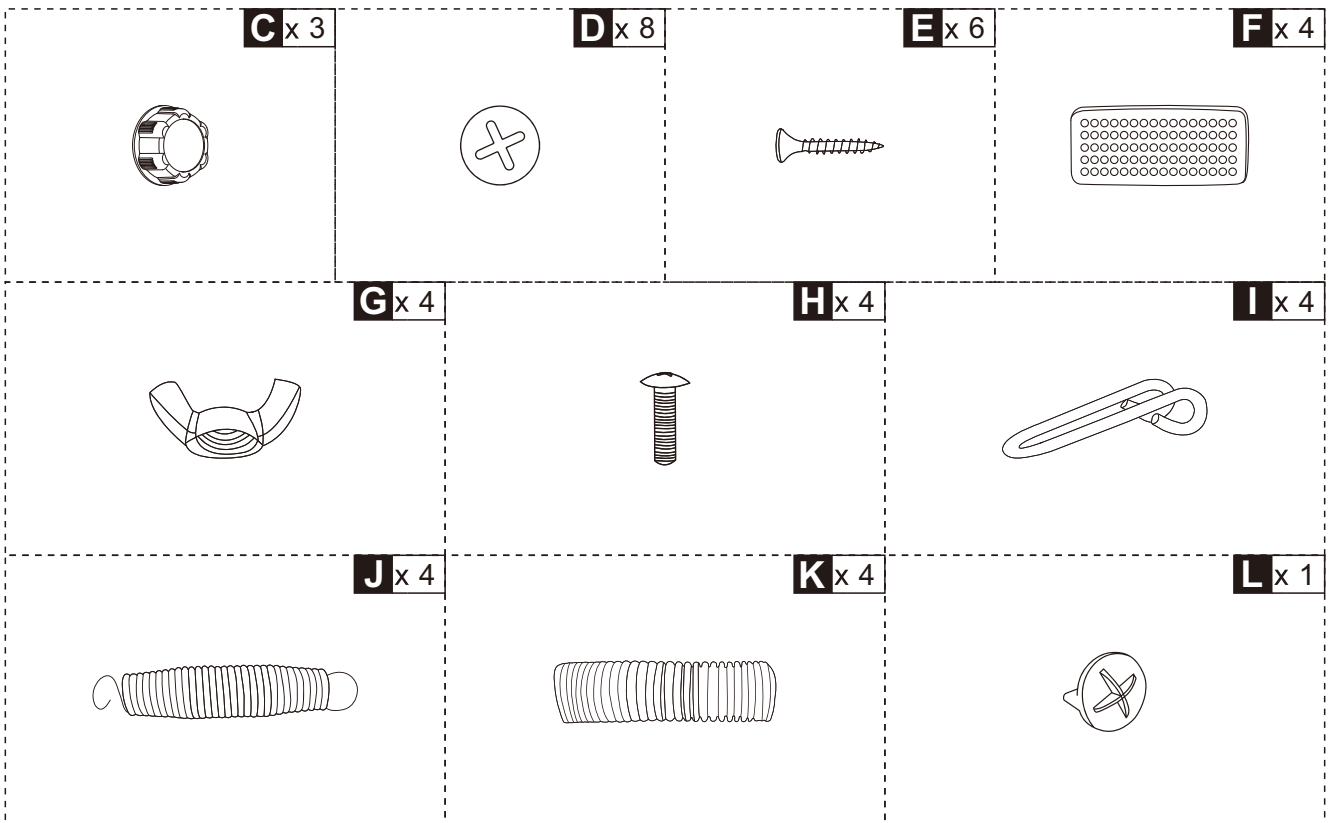

E*6

01

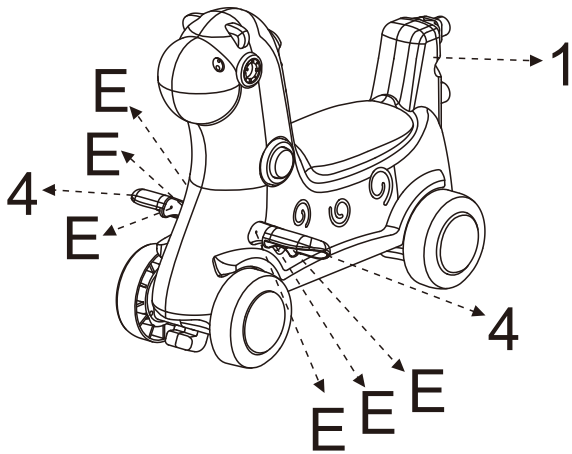

02

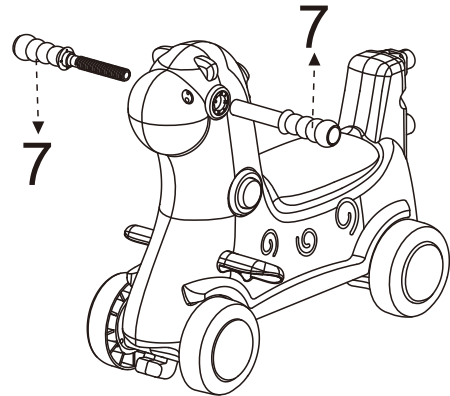

C*2

03

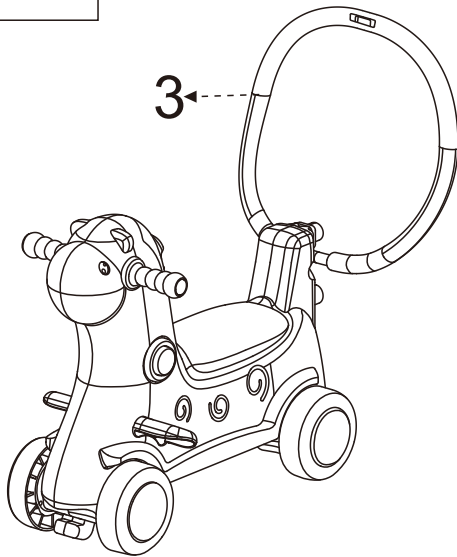

04

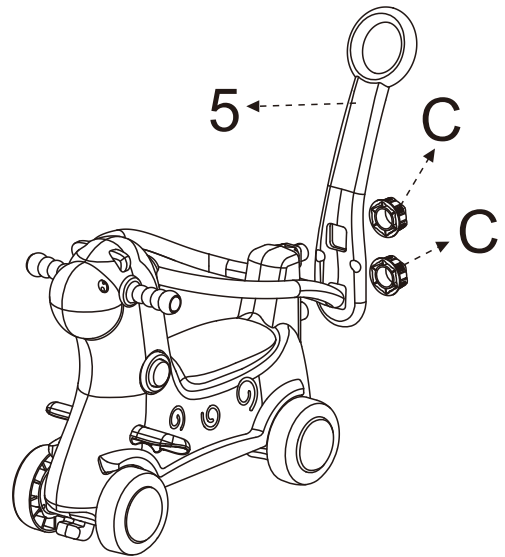

A*4

05

J*4

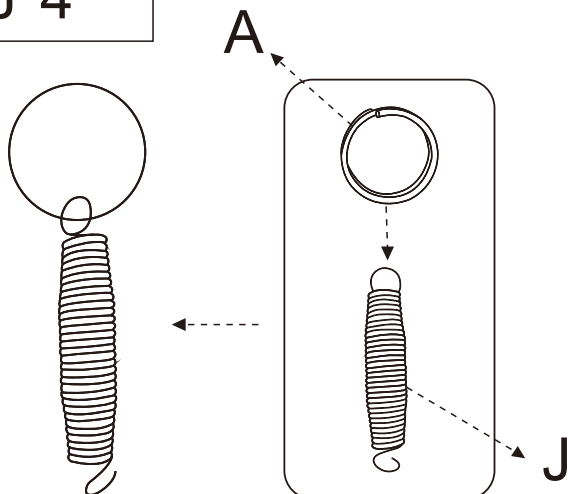

K*4

06

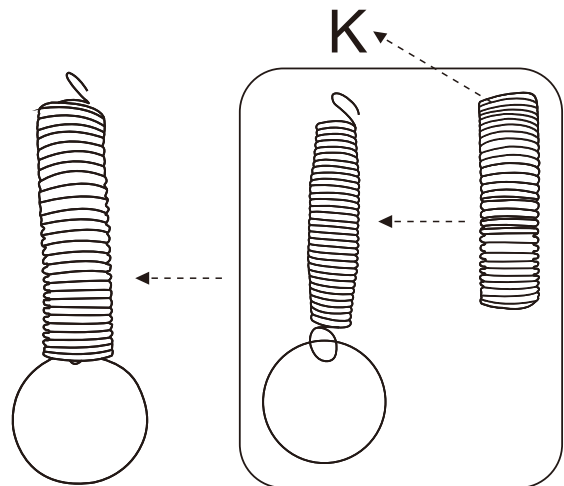

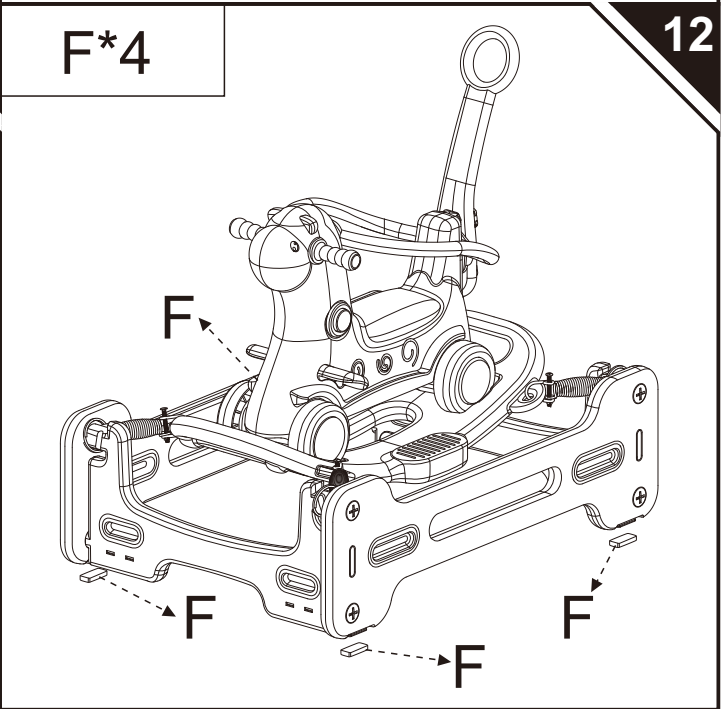
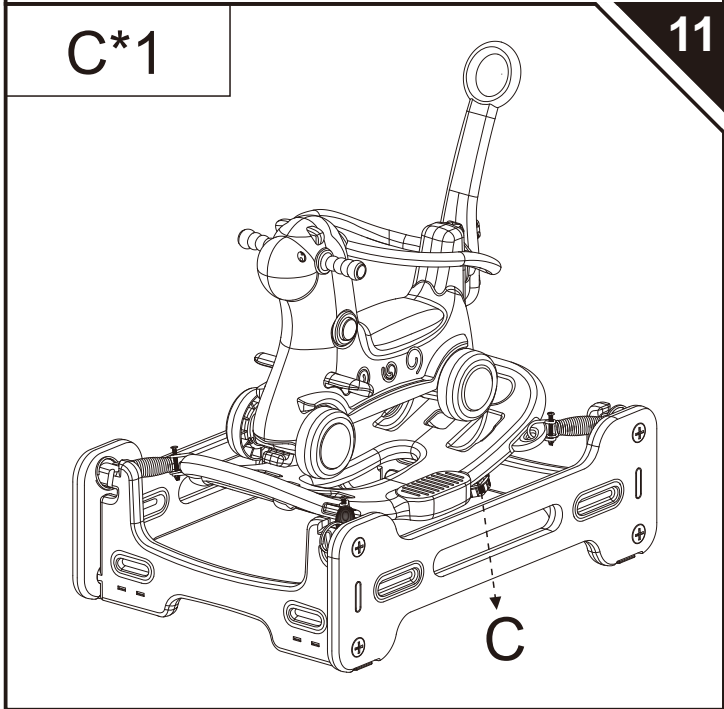
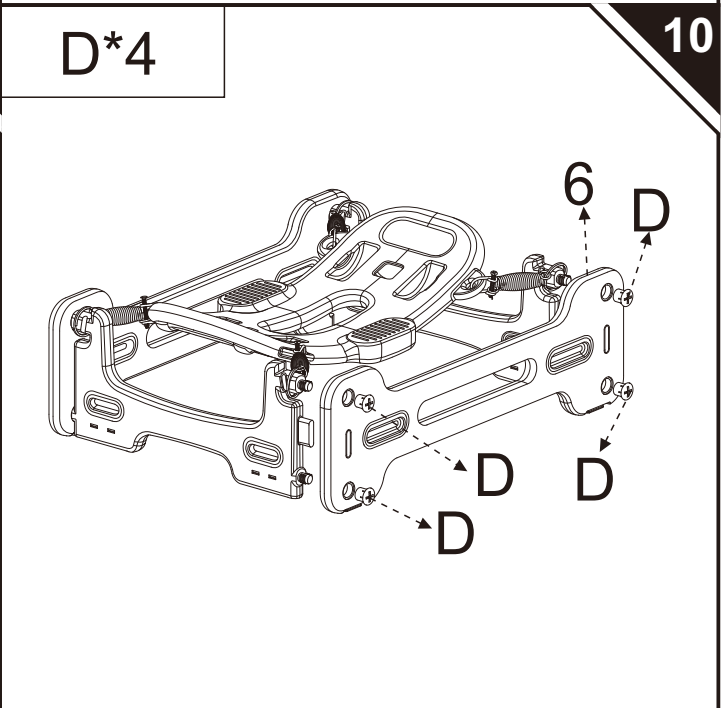
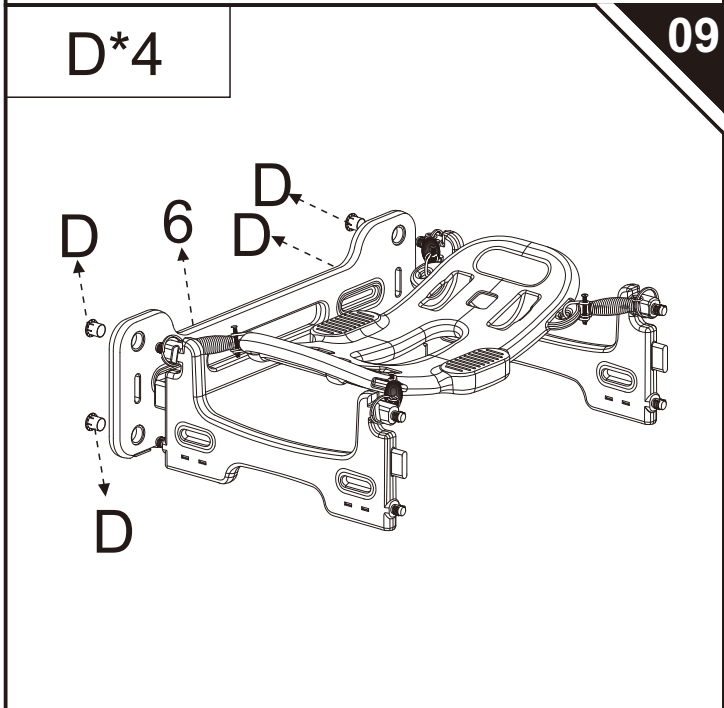
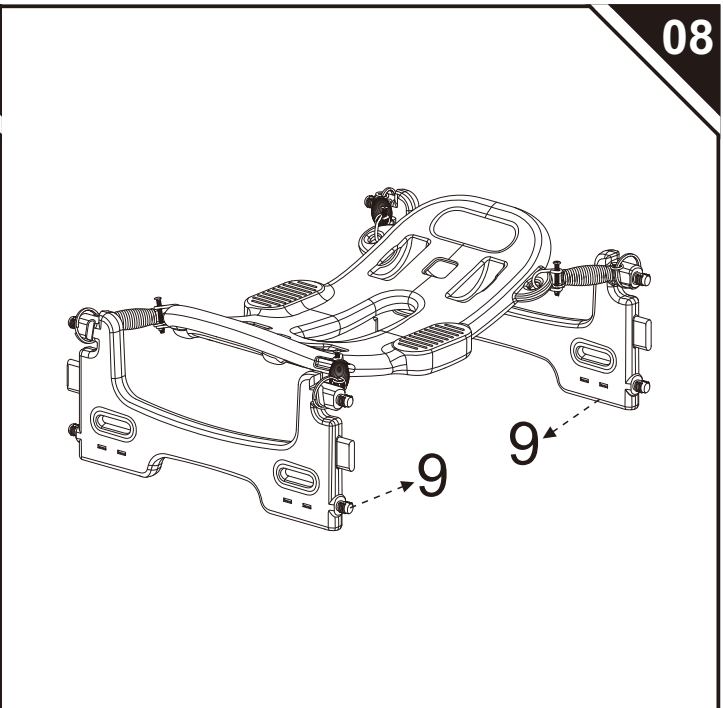
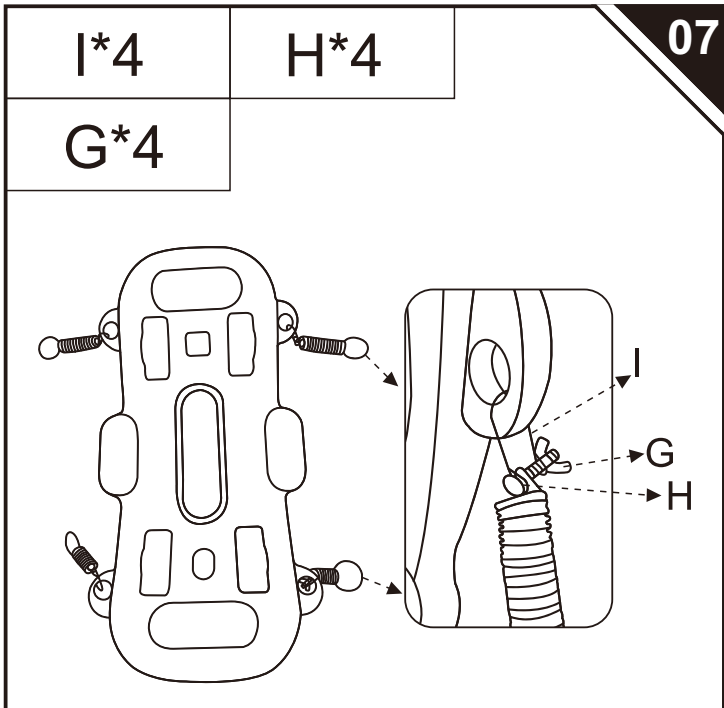

B*4

13

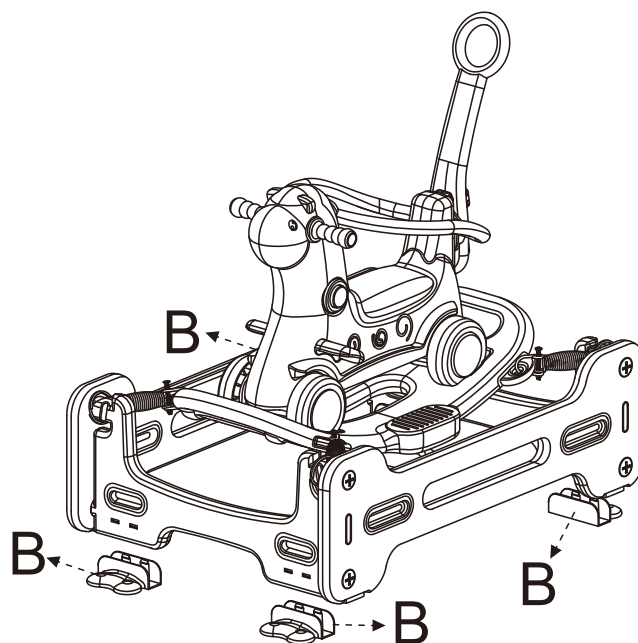

14

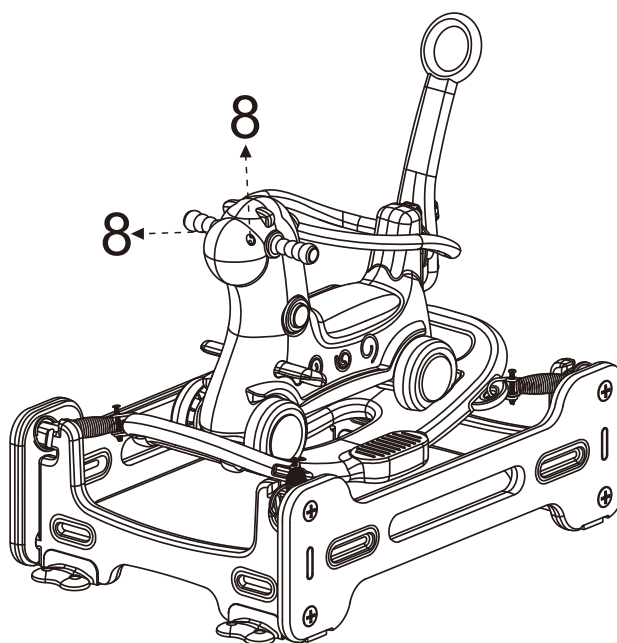

15

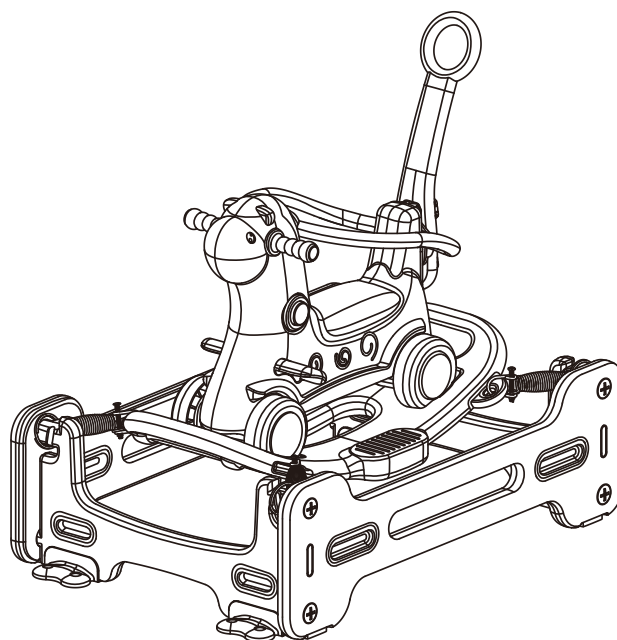

US

If you have any questions, please contact our customer care center.
Our contact details are below:



001-877-644-9366



customerservice@aosom.com

Imported by Aosom LLC
27150 SW Kinsman Rd Wilsonville, OR 97070 USA
MADE IN CHINA

CA

If you have any questions, please contact our customer care center.
Our contact details are below:

Si vous avez la moindre question, veuillez contacter notre centre d'assistance à la clientèle.
Nos coordonnées sont les suivantes:



416-792-6088



customerservice@aosom.ca

Imported by Aosom Canada Inc.
7270 Woodbine Avenue, Unit 307, Markham, Ontario Canada
L3R 4B9
MADE IN CHINA

Importé par Aosom Canada Inc.
7270 Woodbine Avenue, unité 307, Markham, Ontario Canada
L3R 4B9
FABRIQUÉ EN CHINE

